



## 4-STROKE PETROL BLOWER VACUUM SHREDDER

**RACASBT314T**

**USER GUIDE**

CAUTION: Read the instructions before using the machine.

# **SOMMAIRE**

<b>1. SAFETY INSTRUCTIONS .....</b>	<b>3</b>
<b>2. EXPLANATION OF SYMBOLS .....</b>	<b>5</b>
<b>3. INTENDED USE.....</b>	<b>6</b>
<b>4. KNOW YOUR PRODUCT .....</b>	<b>6</b>
<b>5. ASSEMBLY .....</b>	<b>7</b>
<b>6. OPERATION .....</b>	<b>9</b>
<b>7. MAINTENANCE .....</b>	<b>11</b>
<b>8 TROUBLESHOOTING .....</b>	<b>12</b>
<b>9. DECLARATION OF CONFORMITY .....</b>	<b>13</b>
<b>10. WARRANTY .....</b>	<b>14</b>
<b>11. PRODUCT FAILURE .....</b>	<b>15</b>
<b>12. WARRANTY EXCLUSIONS .....</b>	<b>16</b>

# 1. SAFETY INSTRUCTIONS

## 1.2 GENERAL WARNINGS

**WARNING:** For your own safety, please read this manual before attempting to operate your new unit. Failure to follow instructions can result in serious personal injury. Spend a few moments to familiarize yourself with your blower before each use. If you give this tool to another person, also hand over this manual.

Use this tool as described in this manual. Any mishandling and any use contrary to the instructions will not in any way engage the liability of the manufacturer.

Non-compliance with safety instructions and use can cause a risk of electric shock, fire and /or injury to persons.

### READ YOUR USER MANUAL THOROUGHLY BEFORE OPERATING YOUR UNIT.

- Never allow children, handicapped or inexperienced people to use the machine. Local regulations may restrict the age of the user.
- Keep children, bystanders and animals away from the machine when using it (at least 15 meters).
- Remember that the user is responsible for accidents or damage to people or their property.
- Never dismantle the machine by yourself. Any disassembly or repair must be carried out by qualified personnel.
- Always wear personal protective equipment (PPE)
- Wear long, thick pants, boots, eye protection and safety gloves. Do not wear loose clothing, shorts or jewellery, and never work barefoot.
- To reduce the risk of injury, never wear loose clothing, scarf, collar, chain, etc. as they could get caught in moving parts. If you have long hair, be sure to tie it above shoulder level to prevent it from getting caught in the moving parts.
- The machine is extremely noisy and requires the use of good quality hearing protection every time you use it.
- Carry the machine only by its handle. Never try to wear it in other places.
- Refuel only in safe places. Open the tank slowly to release any pressure that may have built up in the tank. Clean any gasoline or spills from the machine before using it. To prevent any risk of fire, move at least 10 meters away from the refuelling area before starting the machine.
- Switch off the machine before any preparation, installation or maintenance.
- All machine screws should be properly seated and tightened securely. The machine must be in good working order. Never use this machine if it is not assembled correctly.
- Keep handles clean and dry and free from gasoline or oil.
- Always store the machine in a clean and dry place away from all electrical equipment.
- Never start the engine in a closed or poorly ventilated room as the exhaust gases can be fatal.
- Only operate the machine at reasonable times - not too early in the morning or late at night, when people may be disturbed.
- Never use the machine in bad weather or if there is a risk of lightning or thunderstorms. Do not use in the rain or in wet areas.
- Do not use this machine if you are tired, sick, under the influence of alcohol or drugs, or if you are taking medication.
- Do not use this machine in a poorly lit area.
- Keep a safe distance from moving parts and never touch surfaces that become hot during use.
- Wear a mask that filters out microscopic particles if your work generates dust, to avoid the risks associated with inhaling harmful dust.
- Before starting the machine, clear the area where you are going to use it. Remove stones, broken glass, nails, wire ropes, ropes or other objects that could be thrown or get caught in the machine.
- Always keep a good balance. Support yourself well on your legs and do not extend your arm too far. Otherwise, you could fall, slip or injure yourself.
- Let your machine cool down before putting it away.
- Before transporting this machine in a vehicle, empty the fuel tank and secure the machine so that it cannot move during transport.
- To reduce the risk of fire and burns, handle fuel with care. It is an extremely flammable substance.
- Do not smoke when handling fuel.
- Mix and store fuel in a container designed to hold gasoline.
- Mix the fuel in the open air, away from any sparks or flames.
- Choose a clean, bare surface, stop the engine, and allow it to cool before filling it.
- Slowly unscrew the fuel cap to relieve pressure and prevent fuel from spilling around the cap.

- Screw on the tank cap firmly after filling.
- Wipe down the machine if you have spilled fuel.
- Move at least 10m away from where you filled the fuel tank before starting the engine.
- Never attempt to burn spilled fuel.
- When replacing, use only replacement parts and accessories recommended by the manufacturer. Failure to do so could reduce the efficiency of your machine and put you at risk of injury.
- Maintain your machine with care, according to the instructions in the "Maintenance" section of this manual.
- Check the condition of your machine before each use. Make sure that the fasteners are tight, that there are no fuel leaks and that no parts are damaged.
- Replace any damaged part.
- To reduce the risk of injury from contact with moving parts, stop the engine before installing or removing accessories.
- Do not use your machine if the protective elements are not installed. Always remove the spark plug before carrying out any maintenance or working on any moving part.
- Do not point the blower nozzle at people or pets.
- Never start this machine if the required accessories are not installed.
- Do not operate the machine near open windows,
- Use a rake and broom to loosen debris before blowing.
- Lightly dampen surfaces in dusty conditions before working.
- Use the pipes fully assembled so that the air flow can reach the floor.
- Caution: there is a risk of danger from rotating parts. Avoid coming into contact with them.
- In case of blockage or breakdown, stop using the machine immediately. Inspect it and remove the blockage securely (see chapter "Maintenance"). In the event of a fault, please take your machine to a qualified service for inspection.

### **Fuel handling**

- Be very careful when handling fuels. They are flammable and the vapors are explosive.
- Use only an approved container.
- Never remove the fuel cap or add fuel while the machine is on. Turn off the unit and allow the engine and exhaust components to cool before refuelling.
- Do not smoke.
- Never refuel inside a room
- Never store the tool and the fuel tray indoors where there is a naked flame, such as near a water heater.
- If fuel has spilled, do not attempt to start the machine, but rather move it away from the spill before starting to use it. Clean any spills.
- Replace and tighten the fuel tank cap after refuelling.
- Follow the instructions in this manual for filling the tool with fuel.

### **Maintenance and storage**

When the machine is stopped for servicing, inspection, or storage, or to change an accessory, shut off the power source and make sure that all moving parts have come to a complete stop. Allow the machine to cool before making any inspections, adjustments, etc. Maintain the machine with care and keep it clean.

- Store the machine in a dry place out of the reach of children.
- Always allow the machine to cool before storing.
- Replace worn or damaged parts for safety. Use only genuine replacement parts and accessories.
- Never attempt to override the interlocked feature of the guard.











### **Residuals risks**







Even if you use this product in compliance with all safety requirements, potential risks of injury and damage remain. The following hazards may arise from the structure and design of this product. Always be vigilant when using this product, so you can recognize and manage the risks early. Rapid intervention can prevent serious injury and property damage. Turn off the tool if there are any malfunctions. Have it checked by a qualified professional and have repairs carried out, if necessary, before using it again.

- There are harmful health consequences resulting from the emission of vibrations if the product is used for long periods of time or not properly managed and properly maintained.
- There is risk of injury and property damage due to attachments or broken the sudden impact of hidden objects.
- Risk of injury to persons and property caused by flying objects
- Inhalation of gasoline particles or toxic gases.
- Contact with moving parts. (Ex: Danger related to the starter handle (Risk of kickback))
- Hearing loss if hearing protection is not worn.

## 2. EXPLANATION OF SYMBOLS

This operator's manual describes safety and international symbols and pictographs that may appear on this product. Read the operator's manual for complete safety, assembly, operating and maintenance and repair information.

	<p>To reduce the risk of injury, user must read and understand operator's manual before using this product.</p>
	<p>Keep all bystanders at least 15 m away.</p>
	<p>Wear protective goggles.</p>
	<p>Wear hearing protection.</p>
	<p>Wear safety shoes.</p>
	<p>Wear protective gloves.</p>
	<p>Rotating impeller blades can cause severe injury</p>
	<p>Failure to keep loose clothing from being drawn into air intake could result in personal injury.</p>
	<p>Failure to keep hair into air intake could result in personal injury.</p>
	<p>Conforms to relevant safety standards</p>
	<p>Guaranteed sound power level: 105dB (A).</p>

	<p><b>CHOKE CONTROL</b>  1. • RUN choke position  2. • PARTIAL choke position</p>
	<p>OFF or STOP</p>
	<p>ON / START / RUN</p>
	<p>Hot surface</p>
	<p>Primer bulb</p>
	<p>Warning symbol</p>

## 3. INTENDED USE

This engine gasoline powered blower is intended for Cleaning yards, garages, driveways, porches, patios, around walls, fences, etc.

This product is intended for blower use only and is not designed for vacuum use.

Do not attempt to open air inlet cover that covers the impeller. Opening the air inlet cover may result in contact with the impeller blades and cause serious personal injuries.

## 4. KNOW YOUR PRODUCT

### 4.1 PRODUCT DESCRIPTION

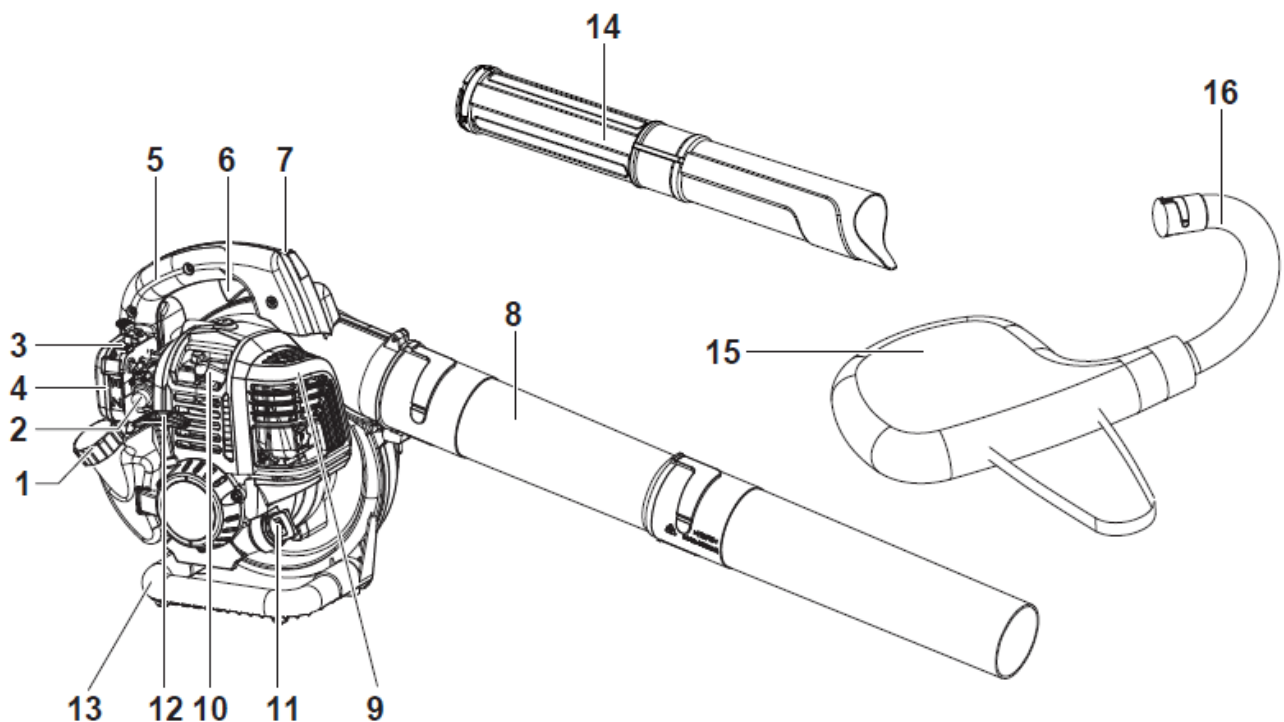

- |                     |                         |                  |
|---------------------|-------------------------|------------------|
| 1) Fuel cap         | 7) ON/OFF switch        | 13) Lower handle |
| 2) Primer bulb      | 8) Air tube             | 14) Vacuum tube  |
| 3) Choke level      | 9) Muffler              | 15) Bag          |
| 4) Air cleaner      | 10) Spark plug          | 16) Curved tube  |
| 5) Handle           | 11) Lubricating oil cap |                  |
| 6) Throttle trigger | 12) Starter rope grip   |                  |

## 4.2 TECHNICAL DATA

Engine Type	Air-Cooled, 4-STROKE
Engine displacement	31cm <sup>3</sup>
Maximum engine capacity	0.8 kW
Engine max speed	7000/min
Engine min speed	3200+/-300 min <sup>-1</sup>
Air speed	205 km/h
Air volume	720 m <sup>3</sup> /h
Fuel tank capacity	280 cm <sup>3</sup> / 0.28 L
Lubricating tank capacity	60 cm <sup>3</sup> / 0.06L
Net weight (without fuel)	5.7 kg
Sound pressure level LpA	90 dB(A), K=3.0dB(A)
Guaranteed sound power level LwA	105 dB(A)
Measured sound power level LwA	102,1 dB(A), K=3.0dB(A)
Main handle ah	12,35 m/s <sup>2</sup>
Aux. handle: ah	6,97m/s <sup>2</sup>
Uncertainty K	1.5 m/s <sup>2</sup>

## 5. ASSEMBLY

### 5.1 INSTALLING/REMOVE THE BLOWER TUBE



**WARNING!** Always install the upper blower tube. The lower blower tube is optional.

#### Installing the Upper Blower Tube

Align the slots on the upper end of the upper blower tube with the bumps on the blower outlet. Insert the upper blower tube into the blower outlet. While holding the handle, twist the upper blower tube clockwise until it locks into place (Fig. 1)

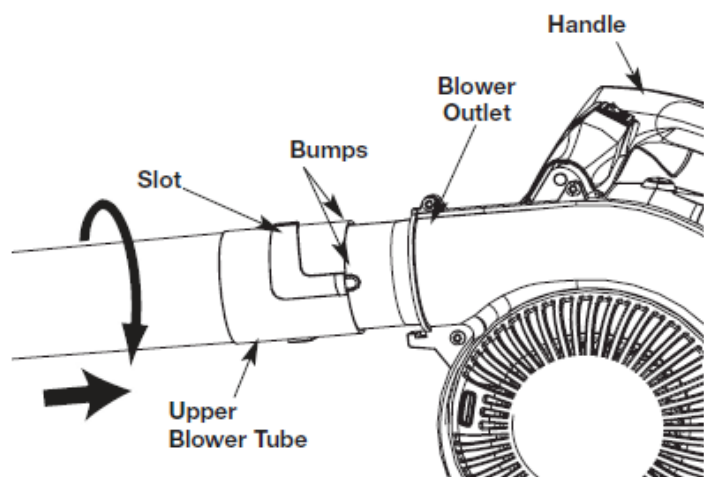

Fig. 1

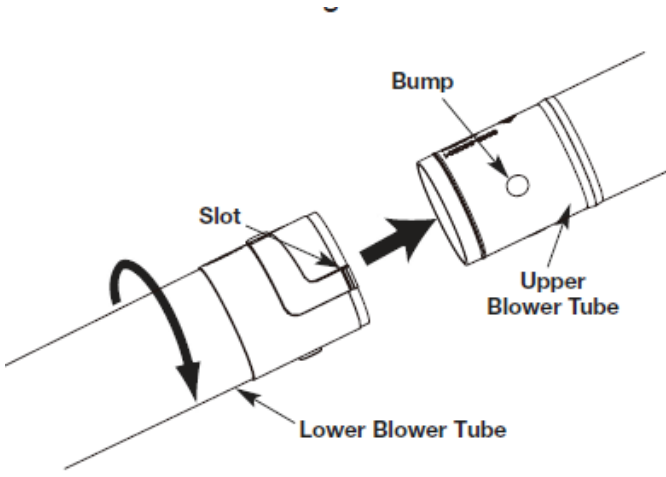

Fig. 2

#### Installing the Lower Blower Tube

Align the slots on the lower blower tube with the bumps on the lower end of the upper blower tube. Install the lower blower tube onto the upper blower tube. While holding the upper blower tube, twist the lower



blower tube clockwise until it locks into place (Fig. 2).

### Removing the Upper Blower Tube

Twist the upper blower tube counterclockwise until it unlocks from the blower outlet. Remove the upper blower tube from the blower outlet (Fig. 3).

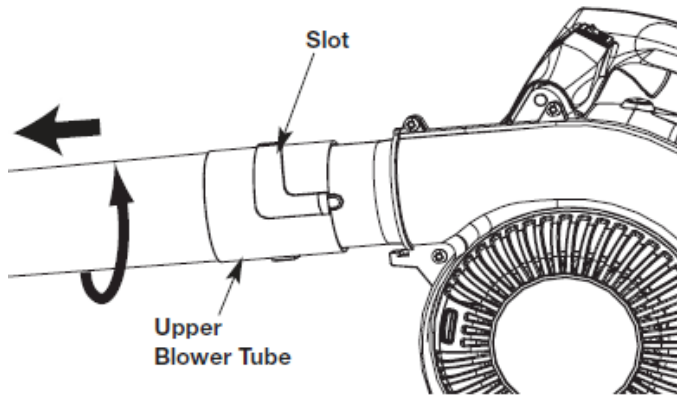

Fig. 3

### Removing the Lower Blower Tube

While holding the upper blower tube, twist the lower blower tube counterclockwise until it unlocks from the blower tube. Remove the lower blower tube from the upper blower tube.

## 5.2 INSTALLING/REMOVE THE VACUUM TUBE

### Installing the vacuum tube

- 1) Insert the curved tube through the zipper of the bag. Slotted end of tube (B) goes first through area (A) of bag. See complete assembly picture in FIG. 4 for the proper look. Once the tube is in place tighten the Velcro strap.
- 2) Align the slots in the curved tube (C) with the with the bumps on the blower outlet (D) Slide the tube on and rotate downward till it locks in place. When properly assembled the tube will curve downward (Fig.5).
- 3) Insert the tip of a flathead screwdriver or the spark plug wrench ( provided ) vertically into the slot of the air intake cover, turn the tool counterclockwise to unlock the air intake cover and open (Fig.6).
- 4) Assemble the lower vacuum tube (E) onto the upper vacuum tube (F), then insert the assembled vacuum tubes into the machine. Turn tubes clockwise until vacuum tubes lock into place (Fig.7) .

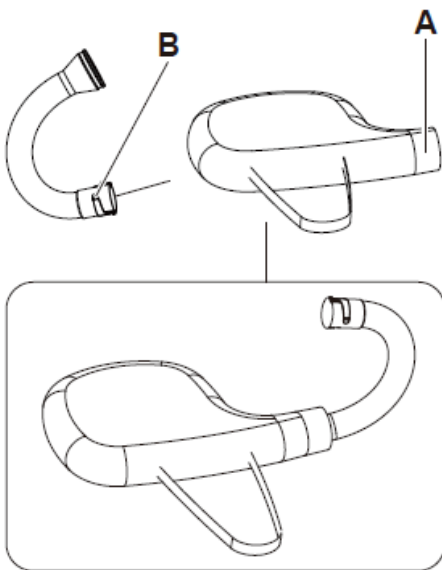

Fig. 4

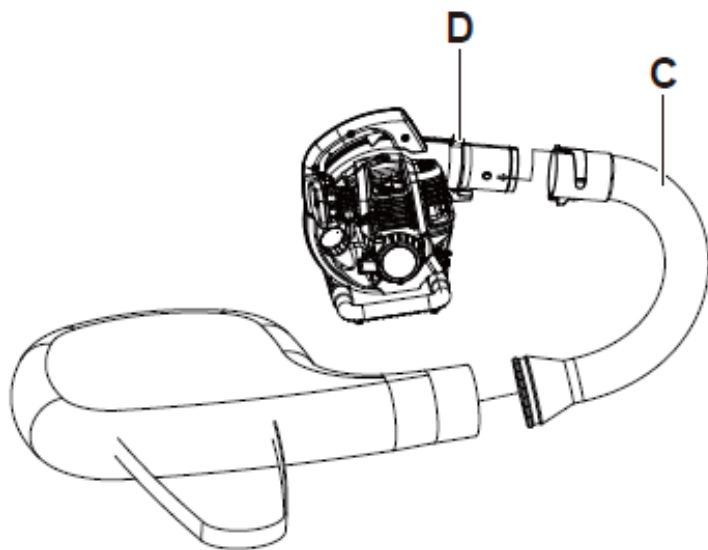

Fig. 5



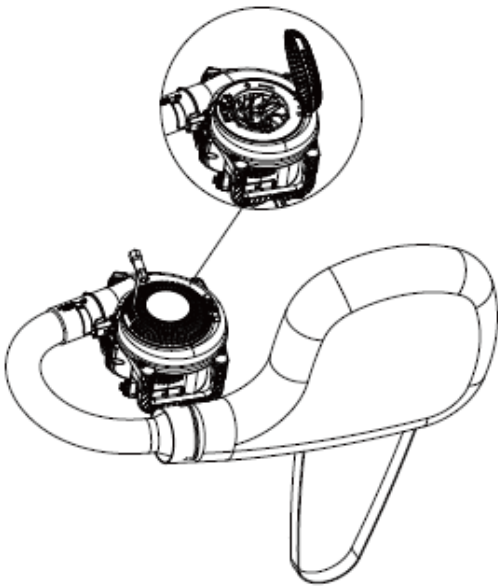

Fig. 6

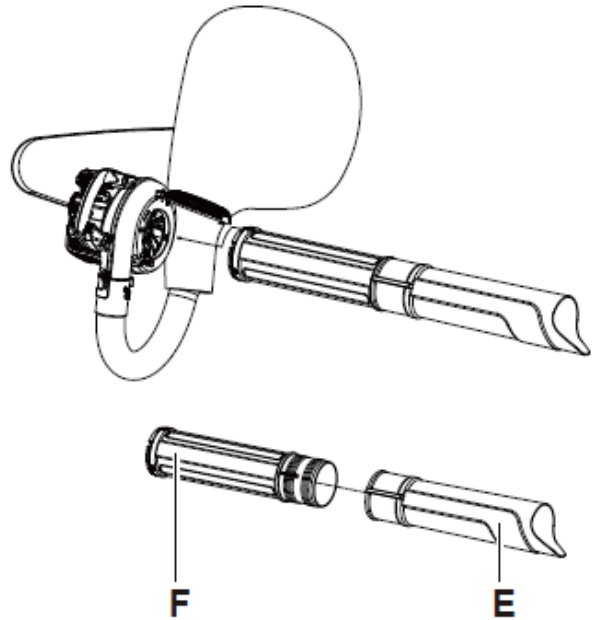

Fig. 7

#### Remove the vacuum tube:

- 1) Then turn the whole vacuum tube counterclockwise out of the machine and turn the E and F parts of the whole vacuum tube away. (Fig.7)
- 2) While holding the machine, twist the the curved tube counterclockwise until it unlocks from the machine. (Fig.5)

## 6. OPERATION

### 6.1 ADDING OIL: INITIAL USE



**CAUTION!** Use a high-quality SAE 30 weight oil. **DO NOT** use dirty oil. Failure to use clean oil of the correct type can cause premature engine wear and failure.

**Note:** This unit was shipped without oil in the crankcase. Oil must be added before starting the unit. This unit comes with a 60 ml container of oil.

- 1) Set the unit on a flat, level surface.
- 2) Unscrew the oil fill plug (Fig. 8)
- 3) Pour the entire container of oil into the oil fill hole (Fig. 8)



**WARNING!** **DO NOT** overfill. Refer to Checking the Oil Level. Never add oil to the fuel tank. This unit has a four-cycle engine. **DO NOT** mix oil with gasoline. Wipe up any oil that may have spilled. Make sure the O-ring is in place on the oil fill plug (Fig. 8).

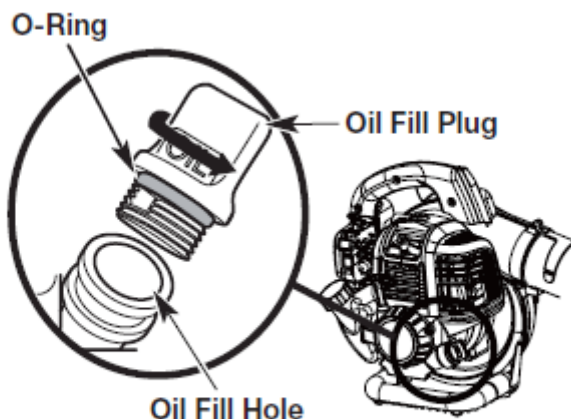

Fig. 8

## 6.2 STARTING / STOPPING THE BLOWER

### STARTING INSTRUCTIONS



#### CAUTION!

Operate this unit only in a well-ventilated outdoor area. Carbon monoxide exhaust fumes can be lethal in a confined area. Avoid accidentally starting the unit. To avoid serious injury, the operator and the unit must be in a stable position when pulling the starter rope.



#### CAUTION!

When starting the unit, make sure it is not directed toward people, animals, windows, automobiles or loose debris. Be sure to read the fuel information in the safety rules before you begin. If you do not understand the safety rules, do not attempt to fuel your unit.

- 1) Check the oil level. Refer to Checking the Oil Level.
- 2) Fill the fuel tank. Refer to Fueling the Unit.
- 3) Slowly press and release the primer bulb 10 times (Fig. 10).
- 4) Move the choke lever to the Full Choke position (Fig. 10).
- 5) DO NOT squeeze the throttle control. Crouch in the starting position (Fig. 11).
- 6) DO NOT squeeze the throttle control. Pull the starter rope with a controlled and steady motion 3 to 5 times to start the engine (Fig. 11).
- 7) Allow the engine to warm up less than 10 seconds, then squeeze the throttle control to return the choke to the Choke Off position and operate the blower.

**Note:** There is no need to turn the unit on. The On/Off switch is in the ON ( I ) position at all times (Fig. 9).

### STOPPING INSTRUCTIONS

Clear the area of children bystanders, and pets. At a minimum, keep all children, bystanders, and pets outside a 15 m (50 ft) radius; outside the 15 m (50 ft) zone, there is still a risk of injury from thrown objects. Bystanders should be encouraged to wear eye protection. If you are approached, stop the engine.

- 1) Release the throttle control and allow the engine to idle.
- 2) Press and hold the On/Off switch in the OFF (STOP) position until the engine comes to a complete stop.

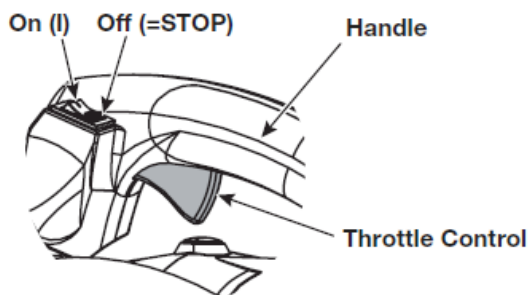

Fig. 9

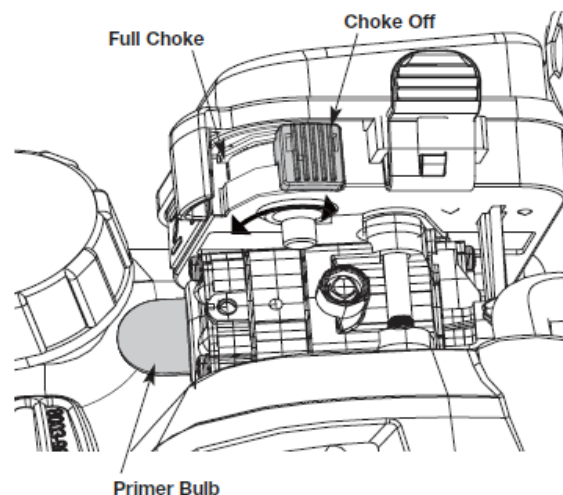

Fig. 10



Fig. 11

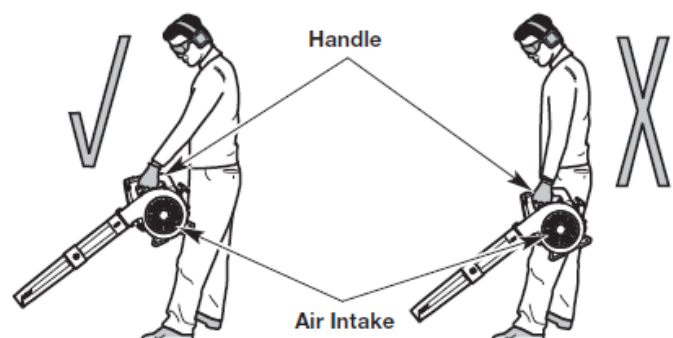

Fig. 12

## 6.3 OPERATING TIPS



### CAUTION!

While vacuuming or blowing debris, hold the unit with the muffler side facing away from your body and clothes.

- To reduce the risk of hearing loss associated with sound level(s), hearing protection is required.
- To reduce the risk of injury associated with contacting rotating parts, stop the engine before installing or removing attachments. Do not operate without guard(s) in place.
- Operate equipment only at reasonable hours not early in the morning or late at night when people might be disturbed. Comply with times listed in local ordinances. Usual recommendations are 9:00 a.m. to 5:00 p.m., Monday through Saturday.
- To reduce noise levels, limit the number of pieces of equipment used at any one time.
- To reduce noise and vibration levels, operate blowers at the lowest possible throttle speed to do the job.
- Use rakes and brooms to loosen debris before blowing.
- In dusty conditions, slightly dampen surfaces when water is available.
- Conserve water by using power blowers instead of hoses for many lawn and garden applications, including areas such as gutters, screens, patios, grills, porches, and gardens.
- Watch out for children, pets, open windows, or freshly washed cars. Blow debris away safely.
- Use the full blower nozzle extension so the air stream can work close to the ground.

After using blowers and other equipment, CLEAN UP! Dispose of debris in trash receptacles.

## 6.4 HOLDING THE UNIT



### CAUTION!

Stand in the operating position (Fig. 12). Stand up straight. Do not bend over.



### WARNING!

To prevent serious personal injury or damage to the unit,

**DO NOT** hold the unit at your side (Fig. 12) The engine may be extremely hot. **DO NOT** block the air intake.

- • Keep feet apart and firmly planted.
- • Hold the unit in front of, and away from, your body (Fig. 12)

# 7. MAINTENANCE



### WARNING!

Read the ENTIRE IMPORTANT SAFETY INFORMATION section at the beginning of this manual including all text under subheading therein before maintenance this product.

### GENERAL MAINTENANCE

- 1) Avoid using solvents when cleaning plastic parts. Most plastics are susceptible to damage from various types of commercial solvents and may be damaged by their use.
- 2) Use clean cloths to remove dirt, dust, lubricant, grease, etc.'

### FUEL CAP AND TANK AND LINES



### WARNING!

Check for fuel leaks. A leaking fuel cap, tank, or line is a fire hazard and must be replaced immediately. If you find any leaks, correct the problem before using the product.

Failure to do so could result in a fire that could cause serious personal injury.

- The fuel cap contains a non-serviceable filter and a check valve. A clogged fuel filter will cause poor engine performance. If performance improves when the fuel cap is loosened, check valve may be faulty or filter clogged.
- Replace fuel cap if required.

### SPARK PLUG REPLACEMENT



### CAUTION!

Be careful not to cross-thread the spark plug. Crossthreading will seriously damage the product. This engine uses a Champion RY4C or equivalent spark plug with .025 in. electrode gap. Use a recommended or equivalent replacement and replace annually.

## CHANGING ENGINE LUBRICANT



### WARNING!

Do not change engine lubricant while it is hot. Accidental contact with hot engine lubricant could result in serious burns.

To change the engine lubricant:

- Stop the engine. Allow the engine to cool completely before proceeding.
- Remove the screws from the engine cover. Remove the cover and set aside.
- Disconnect the spark plug wire.
- Remove the oil fill cap/dipstick.
- Tip blower on its side and allow lubricant to drain from the oil fill hole into an approved container.

**NOTE:** Drain the lubricant while the engine is still warm but not hot. Warm lubricant will drain quickly and more completely.

Return the blower to an upright position and refill with lubricant following the instructions in the Adding/Checking Engine Lubricant section previously in this manual. Reinstall the engine cover. Replace the screws and tighten securely.

**NOTE:** Used lubricant should be disposed of at an approved disposal site. See your local retailer for more information.

## STORING THE PRODUCT

Clean all foreign material from the product. Store idle unit indoors in a dry, well-ventilated area that is inaccessible to children. Keep away from corrosive agents such as garden chemicals and deicing salts. Abide by all ISO and local regulations for the safe storage and handling of gasoline.

# 8. TROUBLESHOOTING

SYMPTOM	POSSIBLE CAUSE	RECOMMENDED ACTIONS
THE ENGINE WILL NOT START	The fuel tank is empty	Fill the fuel tank with fresh fuel
	The primer bulb was not pressed enough	Press the primer bulb 10 times
	The fuel is old (over 30 days)	Drain the fuel tank and add fresh fuel
	The spark plug is fouled	Replace the spark plug
	The engine is hot	Cool the engine down
THE ENGINE WILL NOT IDLE	The air filter is dirty	Clean or replace the air filter
	The fuel is old (over 30 days)	Drain the fuel tank and add fresh fuel
	The idle speed is incorrect	Adjust the idle speed
	The air filter is dirty	Clean or replace the air filter
THE ENGINE WILL NOT ACCELERATE	The fuel is old (over 30 days)	Drain the fuel tank and add fresh fuel
	The air filter is dirty	Clean or replace the air filter
THE ENGINE LACKS POWER OR STALLS	The fuel is old (over 30 days)	Drain the fuel tank and add fresh fuel
	The air filter is dirty	Clean or replace the air filter
	The spark plug is fouled	Replace the spark plug

# 9. DECLARATION OF CONFORMITY



BUILDER

ZI, 32 rue Aristide Bergès – 31270 Cugnaux - France

Declares that the machinery designated below:

4-STROKE PETROL blower vacuum shredder

Model: RACASBT314T

Serial number: 20220526501-20220526800

Complies with the provisions of the Directive "machinery" 2006/42/EC and regulations  
National transposing it;

Also complies with the following European directives:

EMC Directive 2014/30/EU

Emission directive (EU) 2016/1628 & 2017/656/EU

Noise emission Directive 2000/14/EC and Directive 2005/88/EC

Guarantee sound power level: 105 dB(A)

Measured sound power level: 102,1 dB(A), K=3.0dB(A)

Also complies with European standards, national standards and provisions following  
techniques:

EN 15503:2009+A2:2015

EN ISO 14982:2009

Responsible of the technical file: M. Patriarca

Cugnaux, le 22/03/2022

Philippe Marie

A handwritten signature in black ink, appearing to be 'Philippe Marie', written over a faint circular stamp or background.

# 10. WARRANTY

The manufacturer guarantees the product against defects in material and workmanship for a period of 2 years from the date of the original purchase. The warranty only applies if the product is for household use. The warranty does not cover breakdowns due to normal wear and tear.

The manufacturer agrees to replace parts identified as defective by the designated distributor. The manufacturer does not accept responsibility for the replacement of the machine, in whole or in part, and/or ensuing damage.

**The warranty does not cover breakdowns due to:**

insufficient maintenance.  
abnormal assembly, adjustment or operations of the product.  
parts subject to normal wear and tear.

**The warranty does not extend to:**

shipping and packaging costs.  
using the tool for a purpose other than that for which it was designed.  
the use and maintenance of the machine done in a manner not described in the user manual.

Due to our policy of continuous product improvement, we reserve the right to alter or change specifications without notice. Consequently, the product may be different from the information contained therein, but a modification will be undertaken without notice if it is recognized as an improvement of the preceding characteristic.

**READ THE MANUAL CAREFULLY BEFORE USING THE MACHINE.**

When ordering spare parts, please indicate the part number or code, you can find this in the spare parts list in this manual. Keep the purchase receipt; without it, the warranty is invalid. To help you with your product, we invite you to contact us by phone or via our website:

**+33 (0)9.70.75.30.30**

**<https://services.swap-europe.com/contact>**

You must create a "ticket" via the web platform.

Register or create your account.

Indicate the reference of the tool.

Choose the subject of your request.

Describe your problem.

Attach these files: invoice or sales receipt, photo of the identification plate (serial number), photo of the part you need (for example: pins on the transformer plug which are broken).



# 11. PRODUCT FAILURE

## WHAT TO DO IF MY MACHINE BREAKS DOWN?

### **If you bought your product in a store:**

Empty the fuel tank.

Make sure that your machine is complete with all accessories supplied, and clean! If this is not the case, the repairer will refuse the machine.

Go to the store with the complete machine and with the receipt or invoice.

### **If you bought your product on a website:**

Empty the fuel tank.

Make sure that your machine is complete with all accessories supplied, and clean! If this is not the case, the repairer will refuse the machine.

Create a SWAP-Europe service ticket on the site: <https://services.swap-europe.com> When making the request on SWAP-Europe, you must attach the invoice and the photo of the nameplate (serial number).

Contact the repair station to make sure it is available before dropping off the machine.

Go to the repair station with the complete machine packed, accompanied by the purchase invoice and the station support sheet downloadable after the service request is completed on the SWAP-Europe site

For machines with engine failure from manufacturers BRIGGS & STRATTON, HONDA and RATO, please refer to the following instructions.

Repairs will be done by approved engine manufacturers of these manufacturers, see their site:

<http://www.briggsandstratton.com/eu/fr>

<http://www.honda-engines-eu.com/fr/service-network-page;jsessionid=5EE8456CF39CD572AA2AEEDFD290CDAE>

<https://www.rato-europe.com/it/service-network>

**Please keep your original packaging to allow for after-sales service returns or pack your machine with a similar cardboard box of the same dimensions.**

**For any question concerning our after-sales service you can make a request on our website <https://services.swap-europe.com>**

**Our hotline remains available at +33 (9) 70 75 30 30.**





# 12. WARRANTY EXCLUSIONS

## THE WARRANTY DOES NOT COVER:

Start-up and setting up of the product.

Damage resulting from normal wear and tear of the product.

Damage resulting from improper use of the product.

Damage resulting from assembly or start-up not in accordance with the user manual.

Breakdowns related to carburetion beyond 90 days and fouling of carburetors.

Periodic and standard maintenance events.

Actions of modification and dismantling that directly void the warranty.

Products whose original authentication marking (brand, serial number) has been degraded, altered or withdrawn.

Replacement of consumables.

The use of non-original parts.

Breakage of parts following impacts or projections.

Accessories breakdowns.

Defects and their consequences linked to any external cause.

Loss of components and loss due to insufficient screwing.

Cutting components and any damage related to the loosening of parts.

Overload or overheating.

Poor power supply quality: faulty voltage, voltage error, etc.

Damages resulting from the deprivation of enjoyment of the product during the time necessary for repairs and more generally the costs related to the immobilization of the product.

The costs of a second opinion established by a third party following an estimate by a SWAP-Europe repair station

The use of a product which would show a defect or a breakage which was not the subject of an immediate report and/or repair with the services of SWAP-Europe.

Deterioration linked to transport and storage\*.

Launchers beyond 90 days.

Oil, petrol, grease.

Damages related to the use of non-compliant fuels or lubricants.

\* In accordance with transport legislation, damage related to transport must be declared to carriers within 48 hours maximum after observation by registered letter with acknowledgement of receipt.

This document is a supplement to your notice, a non-exhaustive list.

**Attention:** all orders must be checked in the presence of the delivery person. In case of refusal by the delivery person, it you must simply refuse the delivery and notify your refusal.

**Reminder:** the reserves do not exclude the notification by registered letter with acknowledgement within 72 hours.

### **Information:**

Thermal devices must be wintered each season (service available on the SWAP-Europe site). Batteries must be charged before being stored.



BUILDER SAS

32 rue Aristide Berges - Z.I. du Casque - 31270 Cugnaux - France.

MADE IN PRC 2022

