

FEIDER

MACHINES

ORIGINAL INSTRUCTIONS

ORBITAL SANDER

FPO350B



WARNING! PLEASE READ THESE INSTRUCTIONS BEFORE USE THIS MACHINE.

BUILDER SAS

32, rue Aristide Bergès-ZI 31270 Cugnaux, France

MADE IN PPC



1. SAFETY WARNINGS

General power tool safety warnings



WARNING Read all safety warnings, instructions, illustrations and specifications provided with this power tool. *Failure to follow all instructions listed below may result in electric shock, fire and/or serious injury.*

Save all warnings and instructions for future reference.

The term "power tool" in the warnings refers to your mains-operated (corded) power tool or battery-operated (cordless) power tool.

1) Work area safety

- a) **Keep work area clean and well lit.** *Cluttered or dark areas invite accidents.*
- b) **Do not operate power tools in explosive atmospheres, such as in the presence of flammable liquids, gases or dust.** *Power tools create sparks which may ignite the dust or fumes.*
- c) **Keep children and bystanders away while operating a power tool.** *Distractions can cause you to lose control.*

2) Electrical safety

- a) **Power tool plugs must match the outlet. Never modify the plug in any way. Do not use any adapter plugs with earthed (grounded) power tools.** *Unmodified plugs and matching outlets will reduce risk of electric shock.*
- b) **Avoid body contact with earthed or grounded surfaces, such as pipes, radiators, ranges and refrigerators.** *There is an increased risk of electric shock if your body is earthed or grounded.*
- c) **Do not expose power tools to rain or wet conditions.** *Water entering a power tool will increase the risk of electric shock.*
- d) **Do not abuse the cord. Never use the cord for carrying, pulling or unplugging the power tool. Keep cord away from heat, oil, sharp edges or moving parts.** *Damaged or entangled cords increase the risk of electric shock.*
- e) **When operating a power tool outdoors, use an extension cord suitable for outdoor use.** *Use of a cord suitable for outdoor use reduces the risk of electric shock.*

f) **If operating a power tool in a damp location is unavoidable, use a residual current device (RCD) protected supply.** *Use of an RCD reduces the risk of electric shock.*

3) Personal safety

a) **Stay alert, watch what you are doing and use common sense when operating a power tool. Do not use a power tool while you are tired or under the influence of drugs, alcohol or medication.** *A moment of inattention while operating power tools may result in serious personal injury.*

b) **Use personal protective equipment. Always wear eye protection.** *Protective equipment such as a dust mask, non-skid safety shoes, hard hat or hearing protection used for appropriate conditions will reduce personal injuries.*

c) **Prevent unintentional starting. Ensure the switch is in the off-position before connecting to power source and/or battery pack, picking up or carrying the tool.** *Carrying power tools with your finger on the switch or energising power tools that have the switch on invites accidents.*

d) **Remove any adjusting key or wrench before turning the power tool on.** *A wrench or a key left attached to a rotating part of the power tool may result in personal injury.*

e) **Do not overreach. Keep proper footing and balance at all times.** *This enables better control of the power tool in unexpected situations.*

f) **Dress properly. Do not wear loose clothing or jewellery. Keep your hair and clothing away from moving parts.** *Loose clothes, jewellery or long hair can be caught in moving parts.*

g) **If devices are provided for the connection of dust extraction and collection facilities, ensure these are connected and properly used.** *Use of dust collection can reduce dust-related hazards.*

h) **Do not let familiarity gained from frequent use of tools allow you to become complacent and ignore tool safety principles.** *A careless action can cause severe injury within a fraction of a second.*

4) Power tool use and care

a) **Do not force the power tool. Use the correct power tool for your application.** *The correct power tool will do the job better and safer at the rate for which it was designed.*

b) **Do not use the power tool if the switch does not turn it on and off.** *Any power tool that cannot be controlled with the switch is dangerous and must be repaired.*

c) **Disconnect the plug from the power source and/or remove the battery pack, if detachable, from the power tool before making any adjustments, changing accessories, or storing power tools.** *Such preventive safety measures reduce the risk of starting the power tool accidentally.*

d) **Store idle power tools out of the reach of children and do not allow persons unfamiliar with the power tool or these instructions to operate the power tool.**

Power tools are dangerous in the hands of untrained users.

e) **Maintain power tools and accessories. Check for misalignment or binding of moving parts, breakage of parts and any other condition that may affect the power tool's operation. If damaged, have the power tool repaired before use.** *Many accidents are caused by poorly maintained power tools.*

f) **Keep cutting tools sharp and clean.** *Properly maintained cutting tools with sharp cutting edges are less likely to bind and are easier to control.*





g) **Use the power tool, accessories and tool bits etc. in accordance with these instructions, taking into account the working conditions and the work to be performed.** *Use of the power tool for operations different from those intended could result in a hazardous situation.*

h) **Keep handles and grasping surfaces dry, clean and free from oil and grease.** *Slippery handles and grasping surfaces do not allow for safe handling and control of the tool in unexpected situations.*

5) Service

a) **Have your power tool serviced by a qualified repair person using only identical replacement parts.** *This will ensure that the safety of the power tool is maintained.*

3, Warning symbol

	WARNING-To reduce the risk of injury, user must read instruction manual.
	Always wear ear protection
	Always wear goggles
	Always wear a breathing mask
	In accordance with essential applicable safety standards of European directives

3.1 Machine-related safety instructions

– Harmful/toxic dust can be produced during your work (e.g. lead-containing paint, some types of wood and metal). Contact with this dust, especially inhaling it, can represent a hazard for operating personnel or persons in the vicinity. Comply with the safety regulations that apply in your country. Connect the electric power tool to a suitable extraction system.



To protect your health, wear a P2 protective mask.



Always wear protective goggles to protect against sanding hazards.

–Use a residual current protective device when metal grinding, as well as when the operation of the power tool in a wet environment cannot be avoided. In the event of an electric shock, the protective switch protects you against life-threatening current through the body.

– Clean work equipment soaked in oils, for example sanding pad or polishing felt, with water and allow to dry. Work equipment soaked in oil may combust spontaneously.

– Attention: Risk of fire! Avoid overheating the grinding material and the sander. Always empty the dust container before taking a break. Swarf in

the filter bag or filter of the mobile dust extractor may self-ignite in unfavorable conditions such as flying sparks when grinding metals. Particular danger exists if the sward is mixed with paint, polyurethane residue or other chemical materials and the grinding material is hot after long periods of work.

– **Always use original sanding pads.** Foreign pads are not suitable for the speed of the sander and may break.

– **If the power tool is dropped or falls, check for damage to the machine and sanding pad. Remove the sanding pad for closer inspection. Repair damaged parts before using again.** Broken sanding pads and damaged machines can cause injuries and machine instability.

3.2 Mixed dust containing metal and sanding damp surfaces



With mixed dust containing metal (such as dust resulting from paint sanding in the automotive field) and when sanding damp surfaces, the following measures must be observed for reasons of safety:

- Connect the machine to a suitable dust extractor.
- Regularly blow out the motor housing of the machine to remove dust deposits.

4. Intended use

The sanders are designed for sanding wood, plastic, composite, paint/varnish, filler and similar materials as directed. With mixed dust containing metals (such as dust resulting from paint sanding in the automotive industry) and when sanding damp surfaces, special safety instructions must be followed. The sanders are not intended to be suitable for grinding bare metal. Material containing asbestos cannot be processed.



The user is liable for improper or non-intended use.

YOUR PRODUCT

1. Technical data

Power	350W
Mains voltage	230-240V~ 50Hz
Speed	Max 10000/min
Rated Eccentricity:	5
Size of backing pad	150mm
Weight	2Kg
Degree of protection	IPX0

2. Noise and vibration information

Sound pressure level(LPA)	79.7dB(A)
Sound power level (LWA)	90.3dB(A)
Sound measurement uncertainty K	3dB(A)
Vibration emission ah	3.221m/s ²
Vibration uncertainty K	1.5m/s ²

Figure1



3. Commissioning



WARNING

Unauthorized voltage or frequency!

Risk of accident

The mains voltage and the frequency of the power source must correspond with the specifications on the machine's name plate.

4. Operating instructions

4.1 The tool is intended to be operated as a hand held tool. The tool can be used in any position. Note! The sander can develop a torque reaction when started.

4.2 Make sure the sander is switched off. Select a suitable abrasive and secure it to the backing pad. Make sure the abrasive is centered on the sanding pad. For optimal performance we recommend original sanding pad and Sanding paper.

4.3 Switch on the sander by pressing the On/Off key,

4.4 The sander can now be started by pressing the lever.

4.5 The speed can be adjusted between 4,000 and 10000 rpm by rpm+ and rpm-. Each press increases or reduces the speed by 1,000 rpm until it reaches the limits.

4.6 When sanding, always place the tool on the work surface before starting the tool. Always remove the tool from the

work surface before stopping it. This will prevent gouging of the work surface due to excess speed of the abrasive.

4.7 When sanding is finished, turn off the sander by pressing the On/Off key. The sander LED (right) is now turned off.

5. Replacing the sanding pad



Always disconnect the power before maintenance! Only use original sanding pad!

5.1 Insert the pad wrench between the backing pad and brake seal to hold the spindle nut.

5.2 Turn the backing pad counterclockwise to remove it.

5.3 Fit and tighten the new backing pad with washers.

5.4 Remove the pad wrench.

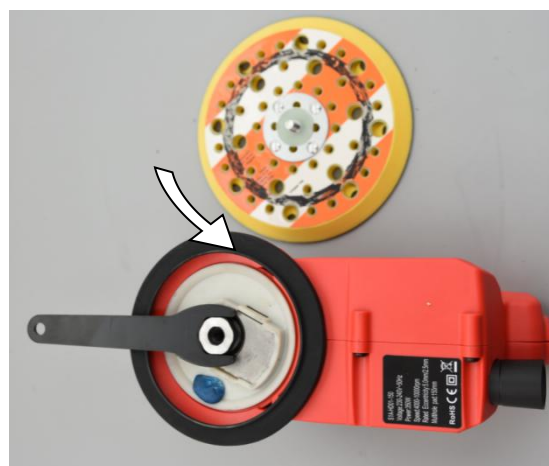
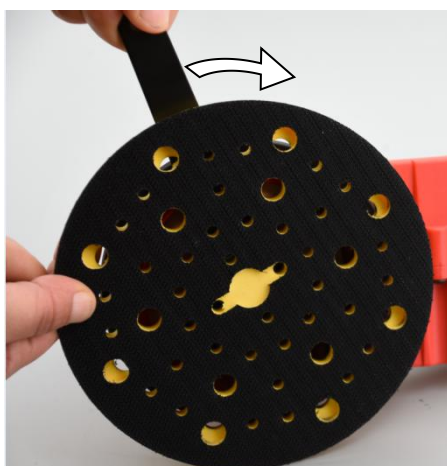

6. Attaching sanding accessories

The suitable sand paper and sanding cloth can be attached quickly and simply to the sanding pad. Press the self-adhesive sanding accessory onto the sanding pad.



In the case of a weakening adhesive effect of the sanding paper surface, the sanding pad accessories, in particular those which are not yet touching the work piece, may come loose from the sanding pad and cause injuries. Replace the sanding pad!



7. Dust extraction



WARNING

Dust hazard

Dust can be hazardous to health. Always work with a dust extractor.

Always read applicable national regulations before extracting hazardous dust.

The power tool does not have its own extractor unit. At the extractor connector, a mobile dust extractor with an extraction hose diameter of 40mm should be connected.

Recommendation: Use an antistatic suction hose. This helps reduce the electric charge.



8. Working with the machine



Risk of injury: Always secure the workpiece in such a manner that it cannot move while being machined.

8.1 Observe the following instructions:

-The sanding capacity and quality are mainly dependent on the selection of the correct abrasive.

- Hold the machine with two hands, one on the motor housing and one on the gear head.

8.2 Sanding work:

9000-10000/min

Sanding with max. abrasion

Sanding off old paint

Sanding of wood and veneered surface prior to paintwork

Intermediate sanding of paintwork on surfaces

8000-9000/min

Sanding thinly applied undercoat

Sanding wood with sanding cloth

Edge breaking on wooden parts

Smoothing primed wooden surfaces

7000-8000/min

Sanding solid wood and veneered edges

Sanding rebate of windows and doors

Intermediate sanding of paintwork at edges

Light sanding of natural wood windows using sanding cloth

Smoothing wooden surfaces using sanding cloth before staining

Rubbing or removing excess limestone residue using sanding cloth

6000-7000/min

Intermediate sanding of paintwork on stained surfaces

Cleaning natural wood window rebate using sanding cloth

4000-6000/min

Sanding stained edges

Sanding of thermoplastics

Maintenance and storage

a. Maintenance

There is no repairs to be provided by the user. For inspection and repair, return the tool directly to a qualified service. You can swipe the tool with a dry cloth.

If the replacement of the supply cord is necessary, this has to be done by the manufacturer or his agent in order to avoid a safety hazard.

b. Storage

After use and cleaning, store your tool. Store the tool in a clean, dry place. The tool should be kept away from children and pets.

Avoid exposing the tool to direct sunlight.

DISPOSAL



CAUTION! This product has been marked with a symbol relating to removing electric and electronic waste. This means that this product shall not be discarded with household waste but that it shall be returned to a collection system which conforms to the European WEEE Directive.

Contact your local authorities or ask for advice on recycling. It will then be recycled or dismantled in order to reduce the impact on the environment. Electric and electronic equipment can be hazardous for the environment and for human health since they contain hazardous substances.

9. DECLARATION OF CONFORMITY



BUILDER SAS

ZI, 32 RUE ARISTIDE BERGES – 312070 CUGNAUX – France

States that the designated below machine:

Product: Orbital sander

Model: FPO350B

Serial number: 20210453272- 20210453871

Developed, designed and manufactured in accordance with the requirements of directives:

Machinery Directive 2006/42/EC

EMC Directive 2014/30/EC

ROHS Directive (EU) 2015/863 amending 2011/65/EU

Also meets the following standards:

EN 62841-1: 2015

EN 62841-2-4: 2014

EN 55014-1: 2017

EN 55014-2: 2015

EN 61000-3-2: 2014

EN 61000-3-3: 2013

Responsible of the technical file: Olivier Patriarca

Cugnaux:Le 08/02/2021

A handwritten signature in black ink, appearing to read "Philippe MARIE". The signature is stylized and includes a large loop at the beginning.

Philippe MARIE / PDG

10. WARRANTY



WARRANTY

The manufacturer guarantees the product against defects in material and workmanship for a period of 2 years from the date of the original purchase. The warranty only applies if the product is for household use. The warranty does not cover breakdowns due to normal wear and tear.

The manufacturer agrees to replace parts identified as defective by the designated distributor. The manufacturer does not accept responsibility for the replacement of the machine, in whole or in part, and/or ensuing damage.

The warranty does not cover breakdowns due to:

- insufficient maintenance.
- abnormal assembly, adjustment or operations of the product.
- parts subject to normal wear and tear.

The warranty does not extend to:

- shipping and packaging costs.
- using the tool for a purpose other than that for which it was designed.
- the use and maintenance of the machine done in a manner not described in the user manual.

Due to our policy of continuous product improvement, we reserve the right to alter or change specifications without notice. Consequently, the product may be different from the information contained therein, but a modification will be undertaken without notice if it is recognized as an improvement of the preceding characteristic.

READ THE MANUAL CAREFULLY BEFORE USING THE MACHINE.

When ordering spare parts, please indicate the part number or code, you can find this in the spare parts list in this manual. Keep the purchase receipt; without it, the warranty is invalid. To help you with your product, we invite you to contact us by phone or via our website:

- **+33 (0)9.70.75.30.30**
- **<https://services.swap-europe.com/contact>**

You must create a "ticket" via the web platform.

- Register or create your account.
- Indicate the reference of the tool.
- Choose the subject of your request.
- Describe your problem.
- Attach these files: invoice or sales receipt, photo of the identification plate (serial number), photo of the part you need (for example: pins on the transformer plug which are broken).



11. PRODUCT FAILURE

WHAT TO DO IF MY MACHINE BREAKS DOWN?

If you bought your product in a store:

- a) Empty the fuel tank.
- b) Make sure that your machine is complete with all accessories supplied, and clean! If this is not the case, the repairer will refuse the machine.

Go to the store with the complete machine and with the receipt or invoice.

If you bought your product on a website:

- a) Empty the fuel tank.
- b) Make sure that your machine is complete with all accessories supplied, and clean! If this is not the case, the repairer will refuse the machine.
- c) Create a SWAP-Europe service ticket on the site: <https://services.swap-europe.com> When making the request on SWAP-Europe, you must attach the invoice and the photo of the nameplate (serial number).
- d) Contact the repair station to make sure it is available before dropping off the machine.

Go to the repair station with the complete machine packed, accompanied by the purchase invoice and the station support sheet downloadable after the service request is completed on the SWAP-Europe site

For machines with engine failure from manufacturers BRIGGS & STRATTON, HONDA and RATO, please refer to the following instructions.

Repairs will be done by approved engine manufacturers of these manufacturers, see their site:

- <http://www.briggsandstratton.com/eu/fr>
- <http://www.honda-engines-eu.com/fr/service-network-page;jsessionid=5EE8456CF39CD572AA2AEEDFD290CDAE>
- <https://www.rato-europe.com/it/service-network>

Please keep your original packaging to allow for after-sales service returns or pack your machine with a similar cardboard box of the same dimensions.

For any question concerning our after-sales service you can make a request on our website <https://services.swap-europe.com>

Our hotline remains available at +33 (9) 70 75 30 30.



12. WARRANTY EXCLUSIONS

THE WARRANTY DOES NOT COVER:

- Start-up and setting up of the product.
- Damage resulting from normal wear and tear of the product.
- Damage resulting from improper use of the product.
- Damage resulting from assembly or start-up not in accordance with the user manual.
- Breakdowns related to carburetion beyond 90 days and fouling of carburetors.
- Periodic and standard maintenance events.
- Actions of modification and dismantling that directly void the warranty.
- Products whose original authentication marking (brand, serial number) has been degraded, altered or withdrawn.
- Replacement of consumables.
- The use of non-original parts.
- Breakage of parts following impacts or projections.
- Accessories breakdowns.
- Defects and their consequences linked to any external cause.
- Loss of components and loss due to insufficient screwing.
- Cutting components and any damage related to the loosening of parts.
- Overload or overheating.
- Poor power supply quality: faulty voltage, voltage error, etc.
- Damages resulting from the deprivation of enjoyment of the product during the time necessary for repairs and more generally the costs related to the immobilization of the product.
- The costs of a second opinion established by a third party following an estimate by a SWAP-Europe repair station
- The use of a product which would show a defect or a breakage which was not the subject of an immediate report and/or repair with the services of SWAP-Europe.
- Deterioration linked to transport and storage*.
- Launchers beyond 90 days.
- Oil, petrol, grease.
- Damages related to the use of non-compliant fuels or lubricants.

* In accordance with transport legislation, damage related to transport must be declared to carriers within 48 hours maximum after observation by registered letter with acknowledgement of receipt.

This document is a supplement to your notice, a non-exhaustive list.

Attention: all orders must be checked in the presence of the delivery person. In case of refusal by the delivery person, it you must simply refuse the delivery and notify your refusal.

Reminder: the reserves do not exclude the notification by registered letter with acknowledgement within 72 hours.

Information:

Thermal devices must be wintered each season (service available on the SWAP-Europe site). Batteries must be charged before being stored.