

# FEIDER

## MACHINES

### INSTRUCTION MANUAL

#### Leaf&litter vacuum

#### FAST200T

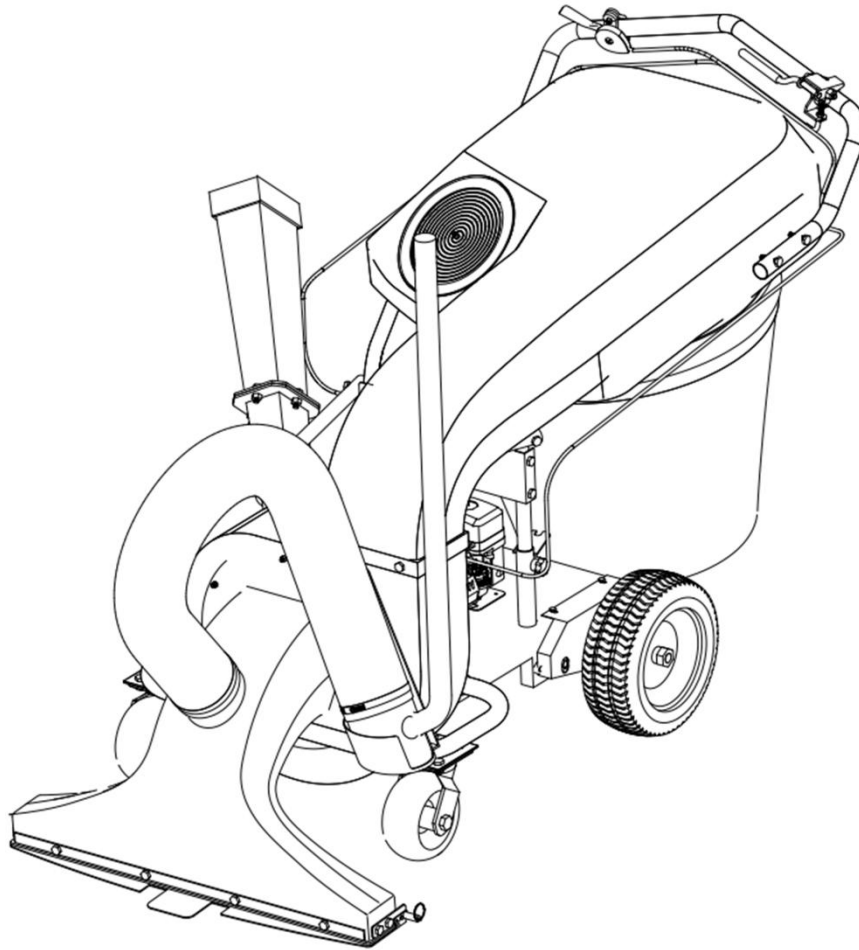

FEIDER  
ZI – 32, rue Aristide Bergès, 31270 Cugnaux, France  
Made in P.R.C. 2019

**IMPORTANT:** Read safety rules and instructions carefully before operating equipment.



## CONTENT

1. Safety Labels Found on Your Unit.....	2
2. <b>PURPOSE</b> .....	5
3. Safety with <b>petrol</b> - Powered Machines.....	6
4. General safety.....	6
5. PARTS IDENTIFICATION.....	7
6. Technical data.....	8
7. Delivery.....	8
8. Assembly.....	9
9. Preparation for use.....	13
10. Operate the machine.....	14
11. MAINTENANCE.....	19
12. TRANSPORT / STORAGE.....	22
13. Troubleshooting Table.....	24
14. CE declaration.....	25

## **WARNING**

Read this Safety & Operating Instructions manual before you use the Leaf&Litter Vacuum. Become familiar with the operation and service recommendations to ensure the best performance of your machine.

## **WARNING**

This indicates a hazardous situation, which, if not avoided, could result in death or serious injury.

## **CAUTION**

This indicates a hazardous situation, which, if not avoided, could result in minor or moderate injury.

## **NOTICE**

This information is important in proper using of your machine. Failure to follow this instruction could result in damage to your machine or property.

### **Additional Information and Potential Changes**

We reserve the right to discontinue, change, and improve **this** products at any time without notice or obligation to the purchaser. The descriptions and specifications contained in this manual were in effect at printing. Equipment described within this manual may be optional. Some illustrations may not be applicable to your machine. This manual provides complete operating and maintenance instructions that will help to maintain your Leaf&Litter Vacuum in top running order. Read this manual carefully before assembling, operating, or servicing your equipment.

# 1: Safety Labels Found on Your Unit

 <b>DANGER</b>		 <b>WARNING</b>	
			
			
	<p> <b>WARNING</b></p> <p>Always wear Hearing protecting when operating the Vacuum</p>		<p> <b>WARNING</b></p> <p>Always wear mask when operating the Vacuum</p>
	<p> <b>WARNING</b></p> <p>Rotating parts will kill you or cut off fingers. Take care!</p>	 	<b>NO SMOKING WHEN REFUELLING.</b>

# WARNING AND SAFTY INSTRUCTIONS

## OPERATOR SAFETY

- Always wear the proper clothing and protective gear. Eye and ear protection, hard hat, boots, gloves and dust masks are that may be required.
- Keep hair, fingers, and all other body parts away from openings and moving parts. Always wear, long pants, boots, and gloves. Secure hair so it is above shoulder length.
- Do not operate vacuum indoors. outdoor use only.
- Do not operate vacuum when tired, ill, or under the influence of alcohol, drugs, or medication.
- Frequently empty debris to prevent bag overloading with more weight than you can lift. Use the dust skirt when debris will be vacuumed in dusty conditions.
- Always use extreme caution while operating. Be sure of your footing and physical capabilities.

## TOOL SAFETY

- Inspect entire vacuum before each use. Replace damaged or worn parts.
- Check for fuel leaks and make sure all fasteners are in place and securely fastened.
- Replace Fan or chipper blade that are severely worn. Be sure the engine is not moving.

## MAINTENANCE SAFETY

- Maintain according to recommended procedures included in this manual.
- Disconnect the spark plug wire before performing maintenance.
- Stop engine before removing fuel cap.
- Use only genuine replacement parts of the engine manufacturer.

## FUEL SAFETY

- Refuel outdoors and where no sparks and flames.
- Store fuel in a container approved for gasoline.
- Do not smoke or allow smoking near fuel or the vacuum or while using the vacuum.
- Clean up all fuel spills before starting engine.
- Move at least 10 feet away from fueling site before starting engine.
- Stop engine before removing fuel cap.

## OPERATING SAFETY

- Hold the vacuum handle firmly with both hands.
- DO NOT place bag on or near hot surface, such as engine.
- Do not operate the engine with the air cleaner or the carburetor air intake cover removed. Removal of such parts could create a fire hazard. Do not use flammable solutions to clean the air filter.
- When chipping, know the correct methods of. DO NOT put branches that bigger than 50mm into the chipping pipe.
- Never overload or attempt to chip woods beyond the manufacturer's recommendation. It may result in personal injury or damage to the machine.

## TRANSPORTATION AND STORING

- Always shut off the fuel valve and engine.
- Always allow the engine to cool.
- Store vacuum and fuel where fuel vapors cannot reach sources of combustion like, water heaters, electric motors, switches, furnaces, etc.
- Always secure this vacuum with tie downs or similar restraints when transporting.
- The vacuum shall be stored in a manner that prevents it from falling, rolling or tipping over.



Always wear goggle and gloves.



Guaranteed sound power level  $L_{WA}$

## 2. PURPOSE

This vacuum is designed for picking up trash, organic material and other similar debris, must not be used for any other purpose. It should only be used by trained operators who are familiar with the content of this manual. It is potentially hazardous to fit or use any parts other than your dealer parts. The company disclaims all liability for the consequences of such use, which in addition voids the machine warranty.

### Before using the Leaf&Litter Vacuum



#### NOTICE

- Operators must be fully trained before using this machine.
- User Manual is read and understood.
- All fasteners are checked for tightness.

### When using the Leaf & Litter Vacuum



## NOTICE

- A. Maintain strict discipline at all times and service machine at specified periods.
- B. DO NOT operate the machine whilst under the influence of alcohol or drugs.

## Protecting Yourself



### WARNING

This is a high-powered machine, with moving parts operating with high energy. You must operate the machine safely. Always take the following precautions when using this machine:

- A. Always wear protective goggles or safety glasses while using the Leaf&Litter Vacuum to protect your eyes.
- B. Wear shoes with non-slip treads when using your Leaf&Litter Vacuum. If you have safety shoes, we recommend wearing them. Do not use the machine while barefoot or wearing open sandals.

## 3. Safety with petrol - Powered Machines



### WARNING

**Petrol** is a highly flammable liquid. **Petrol** also gives off flammable vapor that can be easily ignited and cause a fire or explosion. Never overlook the hazards of **Petrol**. Always follow these precautions:

- A. Never run the engine in an enclosed area or without proper ventilation as the exhaust from the engine contains carbon monoxide, which is an odorless, tasteless, and a deadly poisonous gas.
- B. Store all fuel and oil in containers specifically designed and approved for this purpose and keep away from heat and open flame, and out of the reach of children.
- C. Replace rubber fuel lines and grommets when worn or damaged and after 5 years of use.
- D. Fill the **Petrol** tank outdoors with the engine off and allow the engine to cool completely. Don't handle **Petrol** if you or anyone nearby is smoking, or if **you are** near anything that could cause it to ignite or explode. Reinstall the fuel tank cap and fuel container cap securely.
- E. If you spill **Petrol**, do not attempt to start the engine. Move the machine away from the area of the spill and avoid creating any source of ignition until the gas vapors have dissipated. Wipe up any spilled fuel to prevent a fire hazard and properly dispose of the waste.
- F. Allow the engine to cool completely before storing in any enclosure. Never store a machine that has gas in the tank, or a fuel container, near an open flame or spark such as a water heater, space heater, clothes dryer or furnace.
- G. Never make adjustments or repairs with the engine running. Shut down the engine, disconnect the spark plug wire, keeping it away from the spark plug to prevent accidental starting, wait 5 minutes before making adjustments or repairs.
- H. Never tamper with the engine's governor setting. The governor controls the maximum safe operation speed and protects the engine. Over-speeding the engine is dangerous and will cause damage to the engine and to the other moving parts of the machine. If required, see your authorized dealer for engine governor adjustments.
- I. Keep combustible substances away from the engine when it is hot.
- J. Never cover the machine while the **exhaust** is still hot.
- K. Do not operate the engine with the air cleaner or the carburetor air intake cover removed. Removal of such parts could create a fire hazard. Do not use flammable solutions to clean the air filter.
- L. The **exhaust** and engine become very hot and can cause a severe burn; do not touch.

## 4. General Safety

### WARNING

Operating this Leaf&Litter Vacuum safely is necessary to prevent or minimize the risk of death or serious injury. Always take the following precautions when operating:

- A. Your Leaf&Litter Vacuum is a powerful tool, not a **toy**. Exercise extreme caution at all times.
- B. Know how to stop the Leaf&Litter Vacuum quickly.
- C. Never operate your unit on a slippery, wet, muddy, or icy surfaces. Exercise caution to avoid slipping or falling.
- D. See manufacturer's instructions for proper operation and installation of accessories.
- E. Never, under any conditions, remove, bend, cut, fit, weld, or otherwise alter standard parts on the Leaf&Litter

Vacuum. This includes all shields and guards. Modifications to your machine could cause personal injuries and property damage and will invalidate your warranty.

F. If the machine starts to make an unusual noise or vibrate, shut down the engine, disconnect the spark plug wire, keeping it away from the spark plug to prevent accidental starting, wait 5 minutes for engine to cool down, then inspect for damage. Vibration is generally a warning of trouble. Check damaged parts and clean, repair and/or replace as necessary.

G. Never tamper with safety devices. Check their proper operation regularly.

H. Before performing any maintenance or inspection procedure, shut down the engine, disconnect the spark plug wire keeping it away from the spark plug to prevent accidental starting, wait 5 minutes for machine to cool down.

I. Never allow people who are unfamiliar with these instructions to use the Leaf & Litter Vacuum. Allow only responsible individuals who are familiar with these rules of safe operation to use your machine.

J. Never overload or attempt to chip wood beyond the manufacturer's recommendation. It could result in personal injury or damage to the machine.

K. While using, don't hurry or take things for granted. When in doubt about the equipment or your surroundings stop the machine and take time to look things over.

L. Never operate the machine when under the influence of alcohol, drugs, or medication.

M. Use the machine only in daylight.

N. Stay alert for hidden hazards or traffic.

O. Keep all nuts and bolts tight and keep the equipment in good operating condition.

## Note to All Users

List of warnings and cautions cannot be all-inclusive. If situations occur that are not covered by this manual, the operator must apply common sense and operate this Leaf&Litter Vacuum in a safe manner. Contact the dealers for assistance in your area.

## 5. PARTS IDENTIFICATION

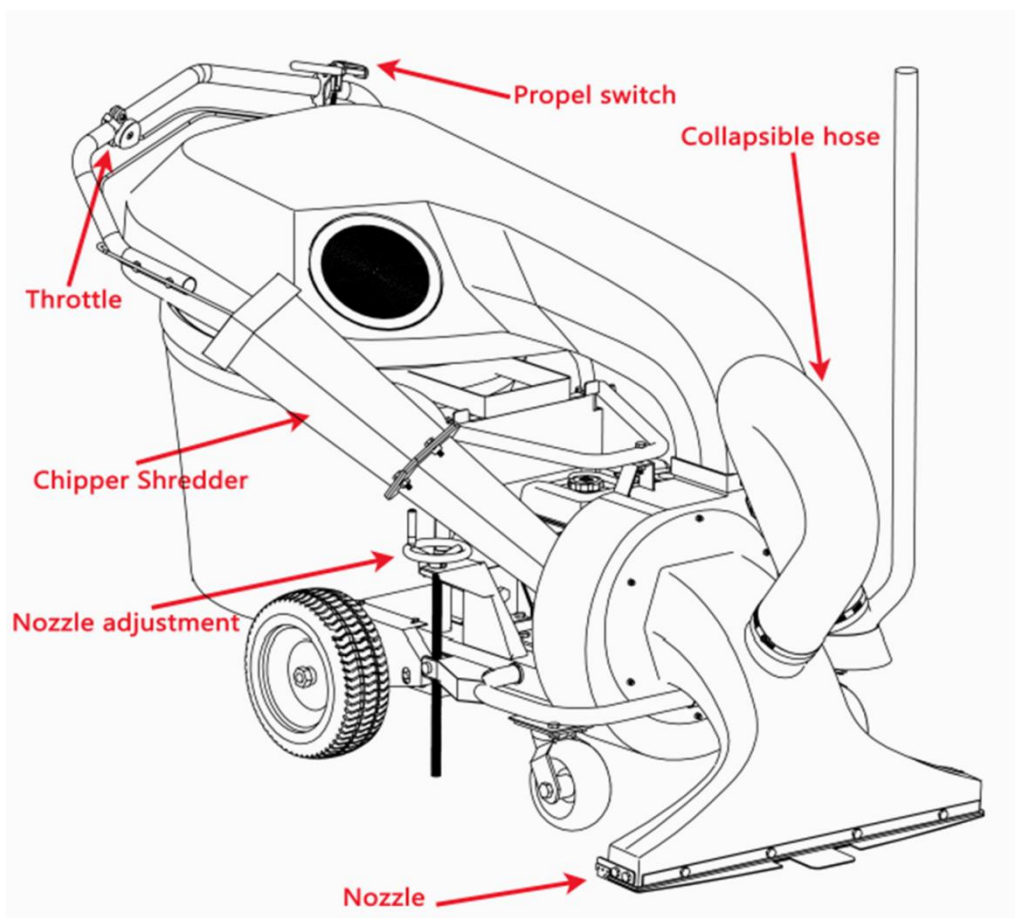

\*Engine: please refer to the engine manual

## 6. Technical data

Engine start	Recoil Start
Rated power	4.4kW(212cc)
Speed	3600/min
Engine: Fuel Capacity	3.6L
Engine: Oil Capacity	0.6L
Power	Petrol/petrol
Fan	6-blade armor plate steel
Bag	60L
Chipping Capacity	50mm
Overall Length	1700mm
Overall Width	730mm
Overall Height	1280mm
Overall Weight	140KG
Guaranteed sound power level L <sub>WA</sub>	111dB(A)

## 7. Delivery

After unpacking, check the contents of the box or shipping box

- ▶▶ Completeness
- ▶▶ possible transport damage

Report any complaints immediately to the dealer or manufacturer. Later complaints will not be accepted.

A: machine unit with petrol engine

B: guide rail

C: collection bag

D: fine dust bag

E: suction nozzle

F: Holder for suction hose

G: Handle bar for suction hose

H: Elastic suction hose

I: hopper for side panel

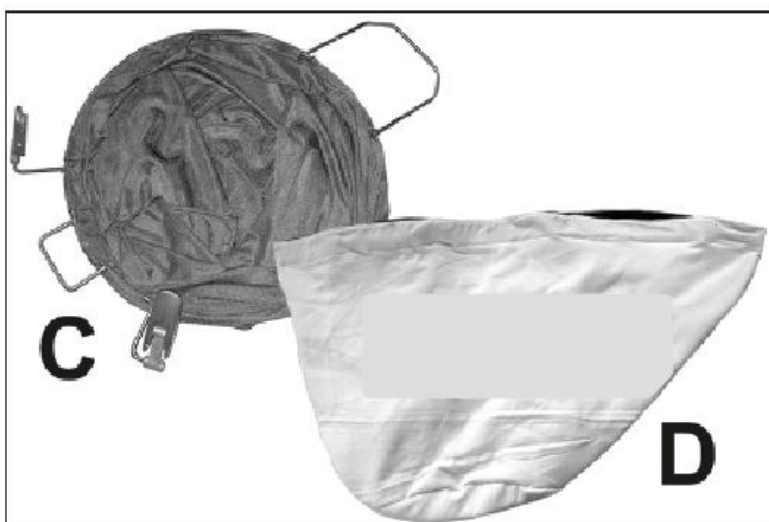
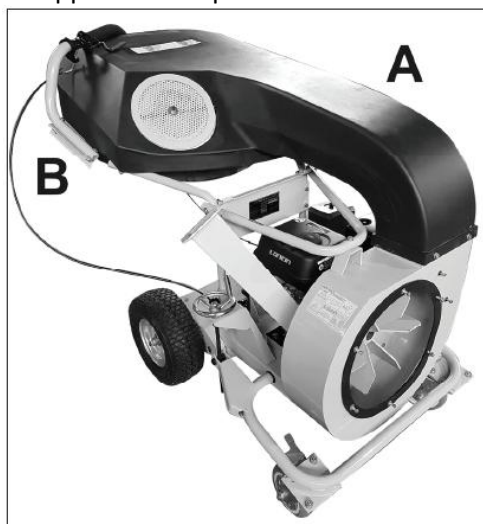



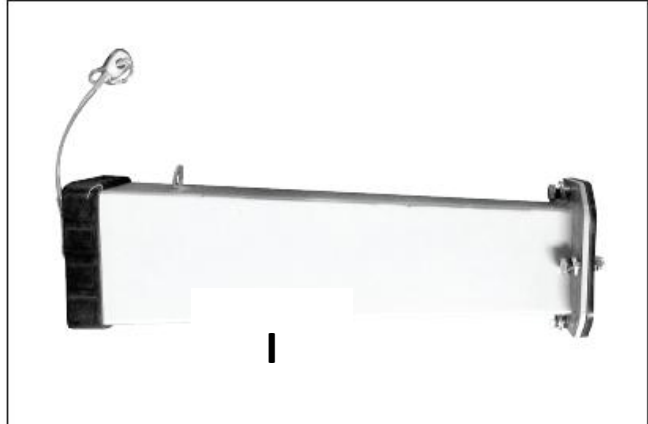
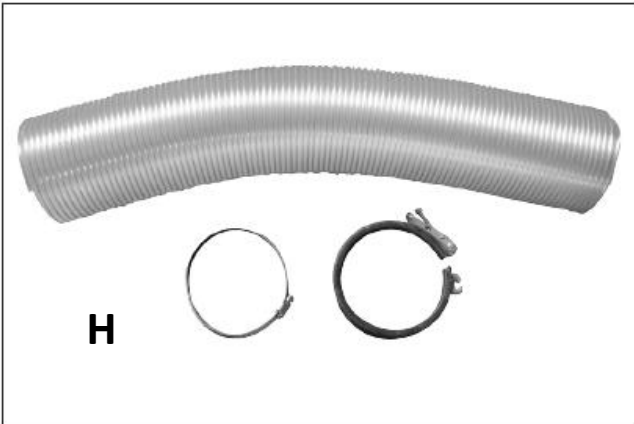
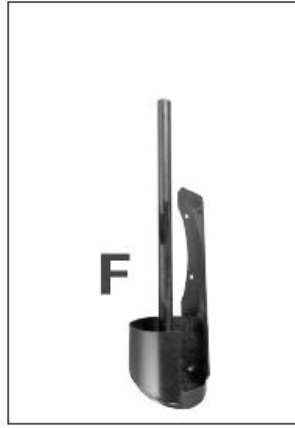

## 8. Assembly

At least two people are required for assembly. Install the assembly parts with the engine switched off.  
*Installation steps 1 - 6*

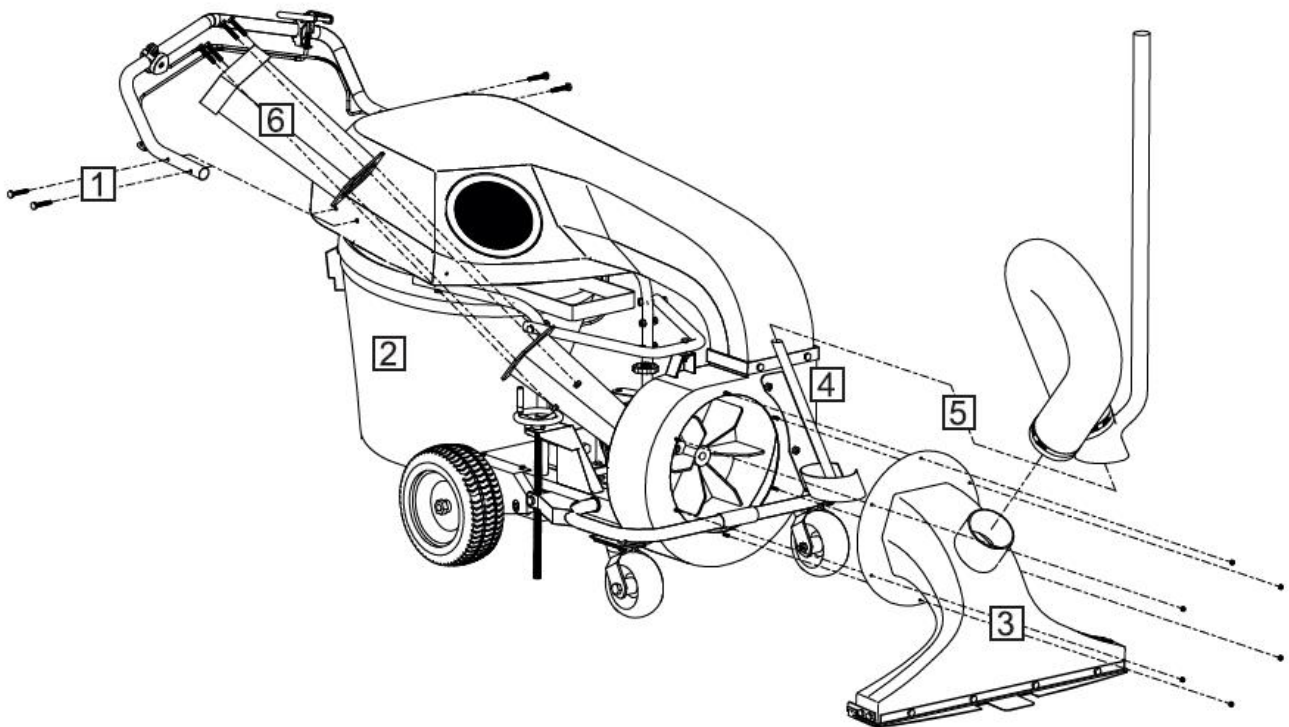

Step 1:

- 1) Loosen the two screws, nuts and washers left and right on the guide rail.
- 2) Position the guide rail at the mounting holes located backwards on the suction channel. A second person can now

help and hold the handlebar.

- 3) Fasten the guide bar to the suction channel with the previously loosened screws, nuts and washers.

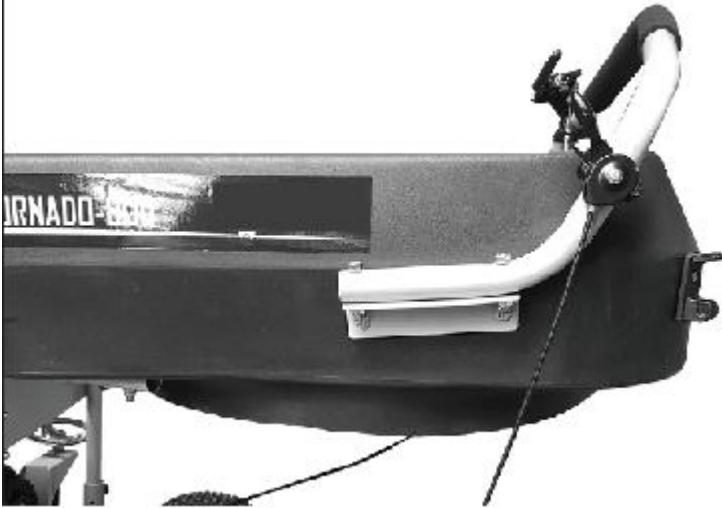

Step 2:

Mount the collecting bag with the retaining bracket and the two clamp closures as follows:

- (1) Guide the grass catcher under the guide bracket forwards towards the engine. Position the metal ring from the collection bag over the opening of the suction channel. Make sure that the front receptacle (retaining clip) of the collecting bag is in the correct position as shown in the next figure.
- (2) Fix the collecting bag with the two clamp closures.
- (3) Put the fine dust bag over the collecting bag and fix it with the Velcro strip.



*Position of the collection bag.*



*Fix the collecting bag to the suction hose,*



Step 3:

- 1) Loosen the 6 nuts and washers on the fan housing and attach the suction nozzle.
- 2) Screw the suction nozzle with the previously loosened nuts and washers. Tighten the screws. Be careful not to damage the case.

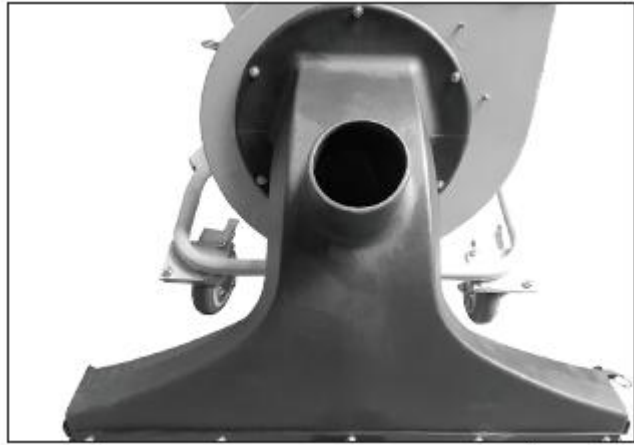
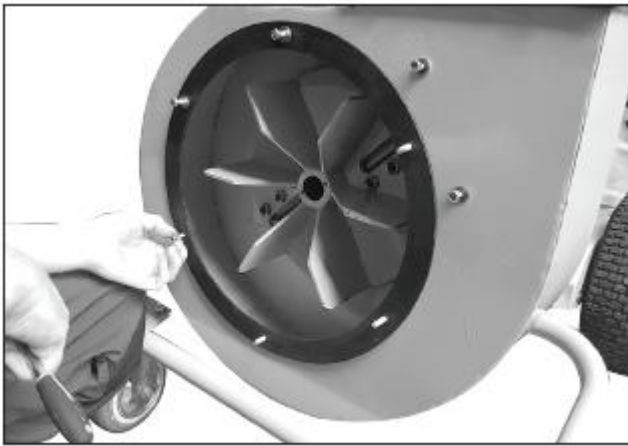

*Mount the suction nozzle on the housing*

**Step 4:**

- 1) Undo the 2 nuts and washers on the fan housing, to the left of the suction nozzle and insert the suction hose holder.
- 2) 12.4.2 Screw the bracket to the housing with the previously loosened nuts and washers.

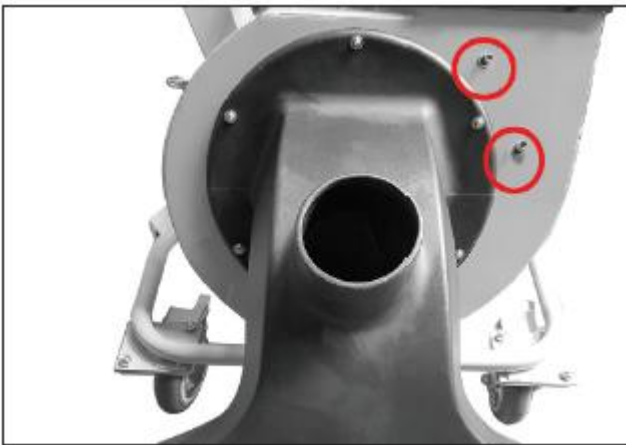

*Mount holder for suction hose / hand extraction on housing.*

**Step 5:**

- 1) First push one end of the suction hose onto the holder of the handlebar and fix it with the clamp.
- 2) Slide the rubber band over the other end of the hose. Then insert this suction hose end onto the receptacle on the suction nozzle and tighten the hose clamp.



*Secure the suction hose to the handlebar.*

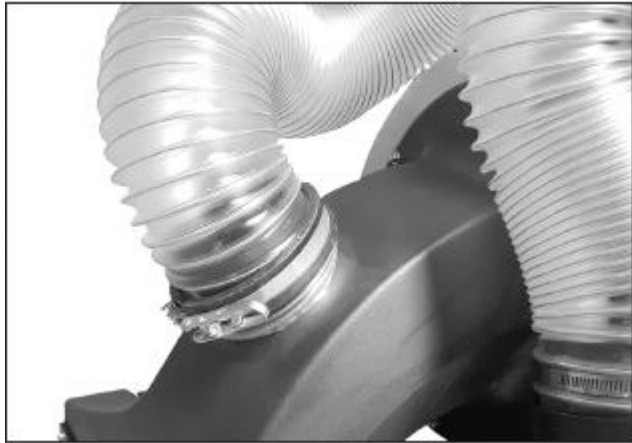
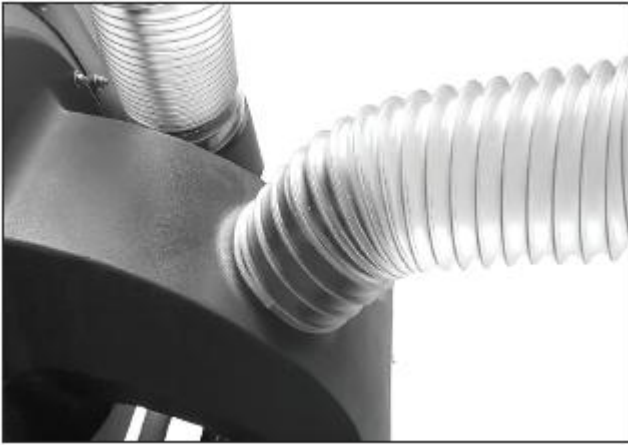

*Fix the suction hose on the suction nozzle.*

Step 6:

- 1) Loosen the 4 screws, nuts and washers on the side feed hopper and remove the rubber seal.
- 2) Place the rubber gasket on the pre-assembled intake for the funnel, to the right of the suction nozzle.
- 3) Position the side feed hopper over the receptacle and secure the hopper with the previously loosened bolts, nuts and washers.
- 4) Attach the Bowden cables to the guide rail with cable ties.



*Remove screws and gasket from funnel.*



*Fit side feed hopper*



**CAUTION**

After installation, check the screw connections again and retighten if necessary!

## 9. Preparation for use



### WARNING

You must not carry out the work described in this chapter until you have read and understood the safety instructions. It concerns your personal safety!



### CAUTION

Engine oil must be topped up before first use! Faulty oil filling can lead to irreparable damage to the engine. In this case sellers and manufacturers distance themselves from any warranty service.

**Use SAE30, 10W-30 or 10W-40 oil.**



### WARNING

**Petrol** is extremely flammable and explosive. You may suffer burns or other serious injuries when handling fuel. When refilling fuel, be sure to note:

- Switch off the engine and let it cool down for at least 10 minutes before removing the fuel filler cap.
- Keep the engine away from heat, sparks and flames.
- Fill the fuel outdoors or in a well-ventilated area.
- To allow the gas to expand, do not fill above the lower edge of the fuel nozzle.
- Keep **Petrol** away from sparks, open flames, pilot lights, heat sources and other sources of ignition.
- If fuel spills, wait until the vapors have volatilized before starting the engine.

#### **Petrol storage.**

- Fuels have limited shelf life and age. **Deteriorated** fuels or fuel mixtures can lead to start problems. Store only as much fuel as you consume in one month.
- Only store fuels in containers that have been specifically approved for this purpose. Store fuel tanks dry and secure.
- Store fuel tanks out of reach of children.

### 8.1 Refueling the machine

1. Clean the area around the tank lid of dirt and foreign objects.
2. Remove the tank cap carefully so that the existing overpressure can be reduced.
3. Carefully fill in **Petrol**. To allow the gas to expand, do not overflow the lower edge of the fuel nozzle.
4. Firmly screw on the tank cap to the filler neck.
5. Wipe up spilled **Petrol** immediately.

- Regularly lubricate the machine according to the frequency of use. See also ... TANKEN / ÖI (4.1)
- Make sure that all parts on the machine are in good condition and correctly installed. Always repair damage immediately. Replace worn and damaged parts. Always remove dust, grease, oil or dirt deposits. Always tighten all screws.
- Check that all guards are mounted and in working order.
- Check that the guide rail, collecting **bag**, suction nozzle / hose and the side drawer funnel are tight and functional.
- Check the **tyre** pressure. Both drive wheels must have the same **tyre** pressure of approx. 2.0 bar.
- Recall the safety instructions and shutdown routines as described in the operating instructions.
- Adjust the height of the suction nozzle to **suit the conditions**, such as Asphalt, gravel, grit, lawn or foliage.
- Use ear protection and goggles with side protection. Wear a surgical mask under dusty conditions.
- Check that the work area is free of metal objects (wires, nails, etc.), glass pieces, and the like. Objects can be thrown out and injure people and damage the equipment.
- Keep a minimum distance of 15 meters between other people, children, animals and the machine. Objects can be thrown away and injure **people** or animals.
- Always hold the machine with both hands while working. Hold the machine firmly by the guide rail.
- Work carefully near roads, paths or residential areas.

- Do not point the suction nozzle or the suction hose at objects or **people** lying around before starting the machine.
- The grass catcher must be completely closed before starting work.
- Check if the motor switch is working. Start the engine and let it run for a few seconds. Turn the engine switch to OFF, the engine will stop immediately.
- Check the oil level and fuel, top up if necessary.
- Check the condition of the air filter, the fuel lines and connections for leaks and mechanical damage, and the fuel tank for leaks and leaks.



## WARNING

Do not start the engine indoors. The exhaust gases contain carbon monoxide, which has a very toxic effect when inhaled!

\*Please read carefully the Engine manual.

### 8.2 Shred bag

Due to the enormous power of the **fan**, the machine is equipped with a PROFIA catcher bag, which has a slightly higher air permeability. To reduce the dust, a fine dust bag is supplied as standard, which must always be mounted. See also ... ASSEMBLING ASSEMBLY / collecting bag (12.2). This ensures that the dust is directed only down and the operator is protected.



## NOTICE

Empty the grass catcher often and regularly, so that the machine can always work optimally.



## WARNING

Do not operate the machine unless the grass catcher is properly fitted and secured. Furthermore, make sure that all guards are in place and in the protective position. Otherwise stones and dirt particles could be thrown out through the suction channel and lead to serious injuries.



## DANGER!!!

Never reach into the operation of the rotating **fan**, as well as the running cleaver. Risk of serious injury.



## WARNING

Warning of hot surfaces! The exhaust and other engine parts get very hot during operation. Never touch the hot engine. Keep enough distance from hot surfaces and keep children away from the running engine.

## 10. Operator the machine

### 9.1 Start the engine

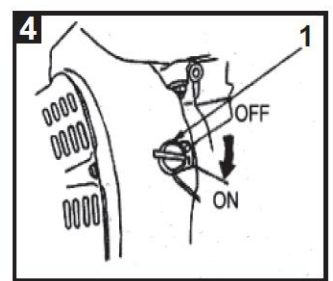
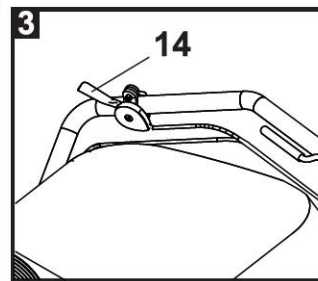
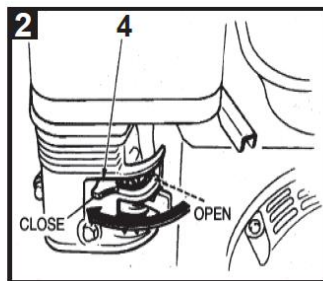
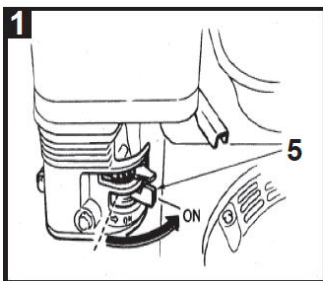

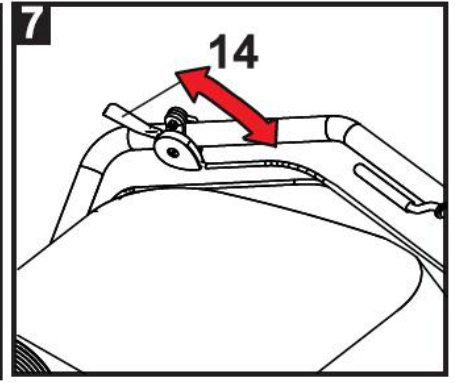
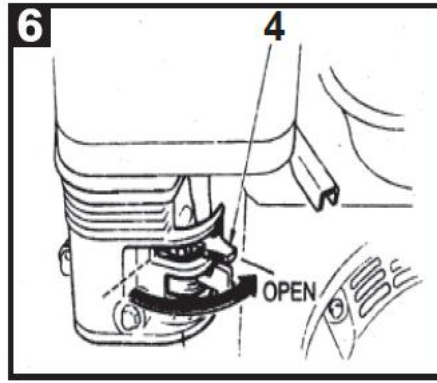
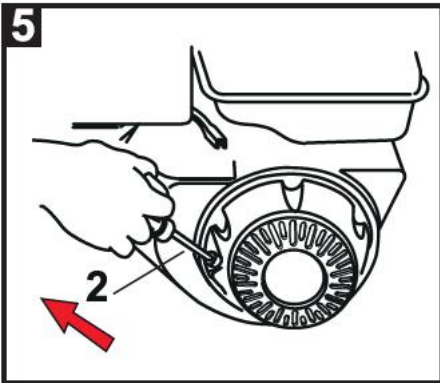

**Before use, ensure the** maintenance plan has been carried out. Check that there is enough fuel in the fuel tank. Before starting the engine, all controls must be switched to neutral. Do not step in front of the machine when starting the engine.

- 1). Turn fuel cock (5) to the ON / ON position.
- 2). When cold, set the choke lever (4) to the left to CLOSE / CLOSED. When warm, leave the choke lever to the right to OPEN / OPEN.
- 3). Place the throttle lever (14) on the guide rail in the neutral position SLOW / SLOW.
- 4). Turn the engine switch (1) to the ON / ON position.
- 5). Pull the recoil starter (2) slightly until a resistance is felt, then tighten it firmly on the cable and let it roll in slowly.
- 6). If the choke lever (4) is set to CLOSE / CLOSE to start the engine, gradually return it to OPEN / OPEN while the engine is warming up.
- 7). When the engine is running, adjust the speed using the throttle lever on the guide rail (14) until the engine is running smoothly.

## 9.2 Stop engine

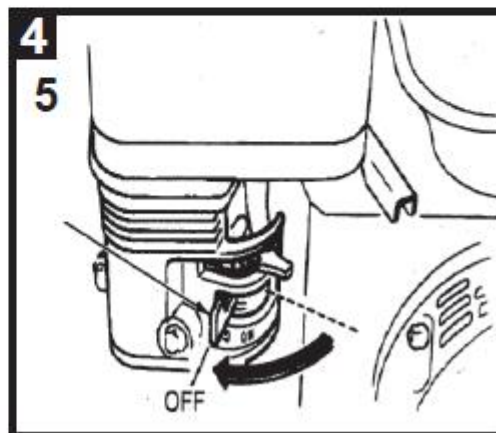
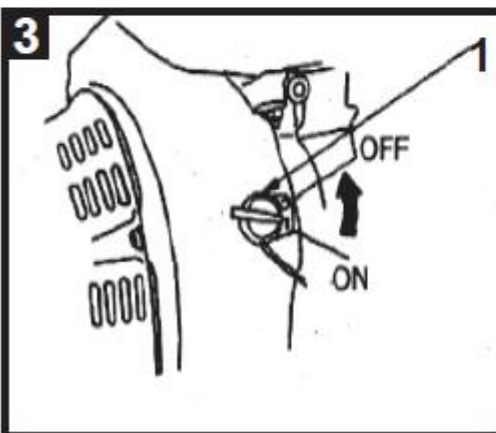
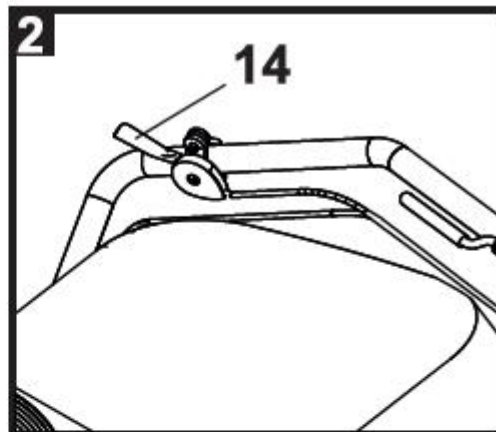
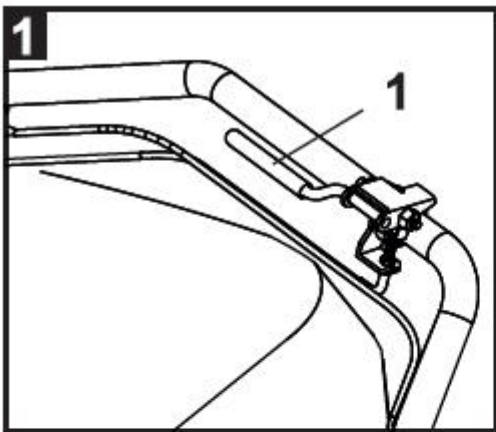

Before stopping the engine, chop all the leftovers in the side hopper .

1. Release the clutch lever (1) on the guide rail.
2. Set the throttle lever (14) on the guide rail in the idle position SLOW / SLOW.
3. Set the engine switch (1) to OFF / OFF and wait until the fan and chopper stand still. **WATCH OUT!** After switching off the

engine, the suction and **chipping** unit will continue to run for a few seconds.

4. Then push fuel tap (5) to the left to OFF / OFF to close.

5. Disconnect the spark plug connector so that accidental starting of the engine is not possible. = Protection against unauthorized use!



## WARNING

After switching off the engine, the suction and **chipping** unit will continue to run for a few seconds. Wait for the work tools to stop before carrying out any work.

■ In case of extraordinary noise or vibration, switch off the engine immediately. Disconnect the spark plug connector and wait for the tools to stop. Faults are to be eliminated immediately.

■ Repairs may only be carried out by an authorized service center or our service team.



## WARNING

Do not vacuum glass or ceramic waste, such as bottles and broken pieces.

The suction area must allow the operator and the machine to stand securely. Make sure that the surface to be vacuumed is freely accessible and there are no stones, glass or metal parts in the vicinity. Hard objects, like other waste, are smashed in the turbine. Sharp-edged shards can penetrate the collecting bag.



## WARNING

Danger of injury due to ejected fragments or handling of the waste.

### 9.3 Operation

9.3.1 Open the suction nozzle while folding the suction nozzle flap (6) backwards.

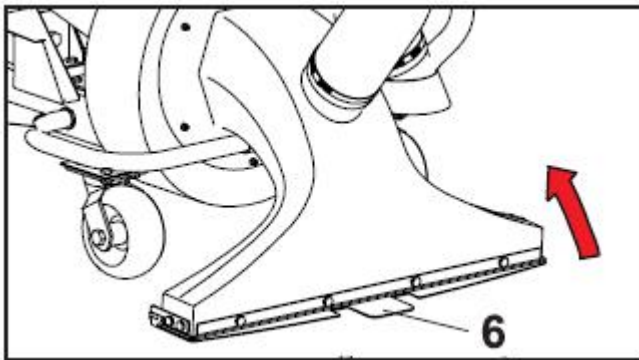

*Pull the suction nozzle flap backwards.*

9.3.2 Always press the clutch lever (1) slowly or release slowly.

1) Release throttle lever (14) on guide rail and set to FAST / FAST position.

2) Press the clutch lever, the machine starts and sucks the driven surface.

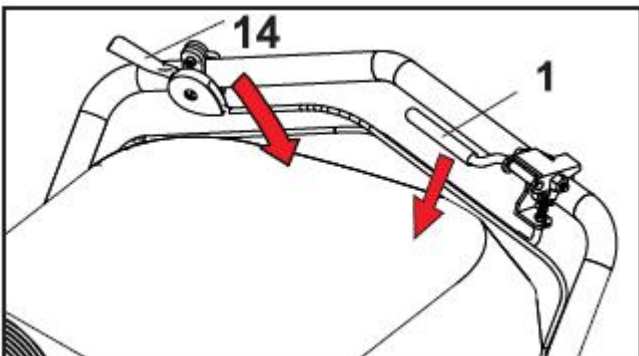

*Throttle lever / clutch lever*



The suction force is largely determined by the height adjustment of the suction nozzle, that is, the heavier the suction material, which is to be absorbed, the lower the suction nozzle should be. Very low on moist foliage, higher on dry foliage (about 3 cm). If a lower setting does not improve the suction result and may cause damage to the suction nozzle. Setting too high will reduce the suction power.

### Sucking dry leaves

Adjust the suction nozzle only as close to the ground as absolutely necessary to keep the machine optimally manoeuvrable. Keep in mind that when used in dry terrain, both machine and grass catcher **would be hardly dirtied**. If the leaves are damp, it is necessary to wash the grass catcher.



## NOTICE

**Always pay attention to a clean, air-permeable collection bag.**

### Sucking wet leaves

Basically, we do not recommend wet leaves to suck. If the machine mistakenly picks up damp leaves and soil, the turbine housing must also be checked daily for soiling or blockages. A strong deterioration of the suction indicates this error.

### Adjust suction nozzle

On the right side of the machines is the adjusting spindle for adjusting the height of the suction nozzle. Turn the spindle (9) anticlockwise to lower the suction nozzle.

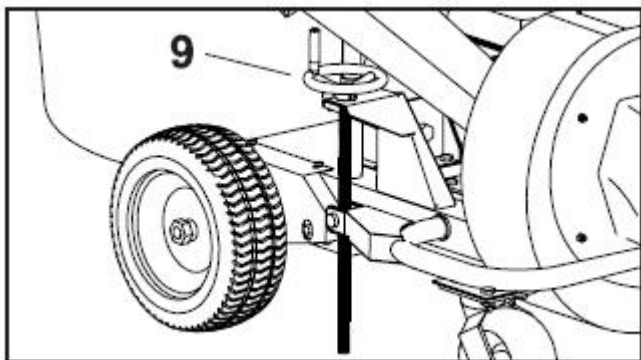

*Height adjustment of the suction nozzle.*



## NOTICE

**Set the suction nozzle as high as possible. Setting it too low can damage the suction nozzle and does not improve the suction result.**

### With the suction hose /

Hand suction work, the suction hose can be used to suck in hard-to-reach areas, such as between / in flower beds, under low bushes.

- 1). Switch off the engine.
- 2). Close the suction nozzle while folding the suction nozzle flap (6) forwards.

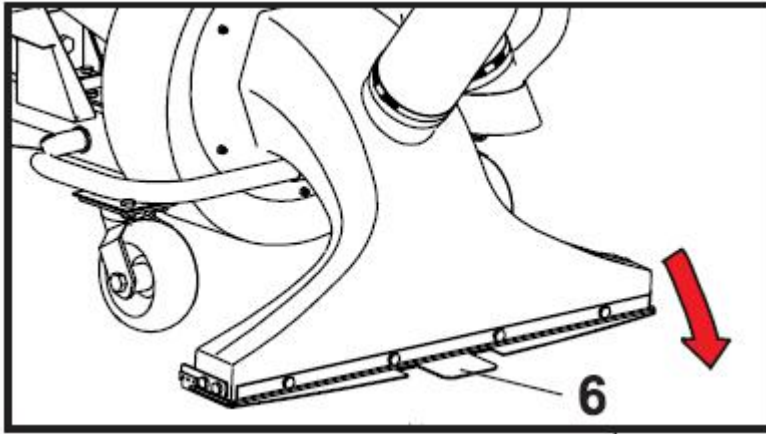

Suction nozzles flap

- 3). Guide the suction hose to the handlebar.
- 4). Hold the suction hose slightly down and move the end of the suction tube back and forth to pick up light debris.

### Shredding

Branches and smaller branches up to max. 50 mm diameter can be fed to the cleaver via the side feed hopper.



**WARNING, Do not chop hardwood or lumber (with nails or screws).**

1. Park the machine on a level surface and
2. Prepare the shredded material so that it can be easily inserted into the hopper.
3. Start the engine, position the throttle lever (14) on the guide rail in position FAST / FAST.
4. Insert shredded material into the side hopper.

### Empty the grass catcher

Switch off the engine and wait until all moving parts have come to a standstill before the collecting bag is opened.

1. Remove the fine dust bag from the collecting bag, carefully handle the Velcro strip.
2. Open the clamps on the collecting bag and remove any sucked-in material. Wear protective gloves.



**WARNING, Empty the grass catcher often and regularly, so that the machine can always work optimally.**

After working, the grass catcher should be washed out and dried. Hand wash! The fine dust bag can be brushed out or knocked out.

### Idle speed

If you are not sucking or chopping, move the throttle lever (14) to the IDLE position to reduce the load on the engine. Reducing idle engine speed extends engine life, saves fuel, and reduces noise levels.

### Switching off

At the end of the work, or in case of interruption, proceed as follows:

- 1). Reduce the engine speed, i. set the throttle to the IDLE position.
- 2). Turn off the engine.
- 4). Approx. Wait 20 seconds for the tools to stop completely.
- 5). Close the fuel tap.
- 6). Pull the spark plug connector on the engine.



**WARNING** The work tools are coupled by a centrifugal clutch and when switching off the engine they are still running. The flow time of the tools depends on the current engine speed.



**WARNING** Prohibition: not allow to block the centrifugal clutch by hand or a tool.

## 11. MAINTENANCE



### WARNING

Improper maintenance or non-observance or non-rectification of a problem can become a source of danger during operation. Only operate regularly and properly maintained machines. Proper maintenance and lubrication help keep the machine in perfect working order.

All persons performing maintenance on the machine must be technically qualified and trained accordingly. You must know all the dangers and risks associated with the machine. Additional work that is not described in these operating instructions may only be carried out by a qualified specialist workshop.



Before any cleaning, maintenance or repair work, switch off the engine, wait for the tools to stop and remove the spark plug connector.



Wear protective gloves when working on the fan, blade and grass catcher!



Do not carry out maintenance near an open fire. Risk of fire!

- 1). Turn off the engine and allow it to cool.
- 2). The throttle lever is SLOW / SLOW, in the idle position.
- 3). Always remove the spark plug connector. Unintentional starting is thereby prevented.
- 4). Inspect the general condition of the machine. The machine is exposed to vibration during work. Therefore, after a few hours, all screw connections always have to be checked for tightness
- 5). Fan, blade, suction hose, grass catcher bag and fine dust bag must be carefully maintained to avoid damage and injury.
- 6). Make sure that the machine is in good working order, in particular the fuel system and the tank cap for leaks.
- 7). After each use, dust, dirt and soil that has accumulated under and on the machine must be removed. To avoid overheating the engine, the cylinder cooling fins must be kept clean. Use commercially available multipurpose oil to lightly oil all moving parts.
- 8). Use only original parts. Other parts can cause unpredictable damage and injury.
- 9). After repair and maintenance, properly install and inspect the protective and safety equipment.
- 10). After cleaning, all moving parts must be greased or oiled. This is especially important when the machine is idle for a long time.



### WARNING

Never use a pressure washer to clean the machine. Water can penetrate narrow slots and damage spindles, pulleys, bearings and the engine. The use of a high-pressure cleaner results in a shortened service life and serviceability.

Clean the collecting bag



Switch off the engine and remove the spark plug connector.



Wear protective gloves.

To clean the collecting bag, loosen the clamps and remove the collecting bag together with the fine dust bag from the suction channel, then remove the fine dust bag from the collecting bag (Velcro!)

- Turn the the bag inside, out and knock out the debris, hand clean the bag only.
- Brush out or knock out the fine dust bag. The fine dust bag must not get wet! For all spare parts the original versions of

the manufacturer must be used.



**Never operate the machine without a collecting bag.**

### Lubricate moving parts

Lubricate every 30 hours with a few drops of light oil

■ the height adjustment of the suction nozzle

All bearing points on the machine are equipped with self-lubricating ball bearings, eliminating bearing lubrication.

### Mounting screws

Regularly check all screw connections for tightness, retighten if necessary. The first check of the screw connections must be made after the first 3 hours of operation.

### Tyres

Check the wheels, the **tyre** pressure of the drive wheels and the **tyre** condition at regular intervals.

■ Check that the screw connections on the wheel axles are in the correct position.

■ **Pay** attention to cuts and foreign bodies in the **tyre** profile

■ Check **tyre** pressure - approx. 2.0 bar.

### Suction nozzle

From time to time, disassemble the suction nozzle on the front of the machine and inspect the fan for any damage that may be caused by foreign objects.

### Motor switch

Check the function of the motor switch before each use and during each care and maintenance work.

### Clean / change air filter

Frequent cleaning of the air filter prevents carburetor malfunctions. If the engine begins to smoke and at the same time the engine power decreases, this is the sign that the filter is clogged. Clean air filter, tap lightly to allow dust to fall out of the paper element.



## WARNING

NEVER use petrol or low-flash point cleaning solutions to clean the air filter cartridge. A fire or an explosion could be the result.

Clean air filter, change filter elements

1. Loosen the fastening element and remove the cover.
2. Wipe dirt off the inside of the filter housing with a clean, damp cloth.
3. Carefully remove the foam filter insert from the paper filter element. Check both parts for damage. Replace damaged inserts.
4. Clean foam filter insert in warm water and mild soap solution. Rinse thoroughly with clean water and allow to dry well.
5. Tap out the paper filter cartridge on a hard surface to remove the dirt. Never brush off dirt as it will force it into the fibers.
6. Place the foam insert on the paper filter element.
7. Reinstall the filter element.
8. Close the cover and secure it with the fastening element.



**Never run the engine with or without a damaged air filter element. Dirt gets into the engine, which can cause serious engine damage. In this case, without any warranty services.**

### Check / replace spark plug

Check the spark plug and the distance of the electrodes regularly.



## WARNING

### Hot surfaces.

There are hot surface parts on the engine, such as the **exhaust** or engine cooling fins. Wait for the engine to cool down before performing any work on the engine.

### Check spark plug, clean and replace

1. Allow the engine to cool.
2. Disconnect the spark plug connector from the spark plug and remove any dirt in the spark plug area.
3. Remove spark plug with spark plug wrench and check.
4. Check insulator. In case of damage such as cracks or splinters, replace spark plug.
5. Clean the spark plug electrodes with a wire brush.
6. Check the electrode distance and adjust if necessary. Electrode distance must be 0.7 - 0.8 mm.
7. Carefully screw in the spark plug by hand and tighten with the spark plug wrench.
8. Place the spark plug connector on the spark plug. A loose spark plug can overheat and damage the engine. And over-tightening the spark plug can damage the threads in the cylinder head.

### Guideline:

- > Used spark plug: 1/8 - 1/4 turn
- > New spark plug: 1/2 turn

### Discharge of resources

Change the engine oil while the engine is still warm. Warm oil runs off quickly and completely.

**WATCH OUT!** Environmental damage. Operating materials and consumables **or contaminated** parts may not be used in the drinking water supply. Dispose of the supplies as hazardous waste, even if they are only small quantities.

The engine oil must be changed after the first 5 hours of operation. Thereafter only every 50 operating hours or every season.

1. Unscrew the oil drain plug.
2. Unscrew oil filler plug.
3. Hold a suitable container (at least 1.5 liters) under the oil drain plug.
4. A second person tilts the machine so that the oil can drain.
5. Thoroughly clean the area around the oil outlet.
6. Screw in the oil drain plug again.
7. **Engine oil** (0.6 liter **SAE30, 10W-30 or 10W-40 oil**)
8. Firmly screw in the oil filler plug.
9. Remove residual oil or dirt.
10. Dispose of engine oil in accordance with local regulations.

### Cleaning

Periodically clean the machine to ensure optimal operation.

Dirt accumulations (leaves, grass, chaff residues, dust, adherent leaf green and the like) inside and on the machine must be removed. Use a soft brush or a vacuum cleaner to remove these soiling

Remove the dirt from the chassis with a dry cloth. When cleaning, never direct water to the bearings or to the motor.

After cleaning, lubricate or lubricate all lubrication points and let the machine run for a short time so that the water ingress is pushed out again.



Waste that has clogged the machine may contain sharp-edged glass or ceramic shards and metal parts. There may be sharp edges in the machine. Risk of injury!



Always wear protective gloves when working on the fan, cleaver and when removing blockages.

## Maintenance Schedule

Maintenance work	Before every use	After each use	After the first 3hrs	After the first 10hrs	25hrs	30-50hrs	100hrs	If necessary	Annually
Check the machine	√								
Check motor switch	√								
Protective devices check	√								
Check fastening screws, retighten	√		√						
Refuel and check oil level	√								
Change engine oil				√		√			
Change fuel									√
Clean the air filter					√				
Replace air filter								√	
Check spark plug and spark plug connector							√		
Replace spark plug									√
Clean the machine		√							
Check tyres	√								
Check V-belt	√								
Lubricate moving parts						√			

## 12. TRANSPORT / STORAGE

### 11.1 TRANSPORT

Before transport or before relocation or indoor parking:

- Switch off the engine and let it cool down to prevent burns and to prevent fire.
- Disconnect the spark plug connector.
- Close fuel cock.
- Empty the fuel tank to prevent fuel overflow. Furthermore, it must be ensured that persons are not endangered by tilting or slipping the machine as well as by pushing up or down machine parts.



### WARNING

The machine is heavy and can not be lifted alone, get help or use the right equipment to lift the machine.



### NOTICE

Only transport the machine standing!

- ■ Move the machine upright to prevent fuel or oil leakage.
- ■ When transporting over long distances, the fuel tank must be emptied completely.

- Only use suitable and tested tools for loading and securing the load on or in vehicles.
  - Secure the machine on the transport vehicle to prevent it from rolling, slipping or tipping over and, in addition, lash it down with tension straps, chains or ropes at suitable points.
  - Always make sure that the applicable traffic regulations are adhered to during transport.
- Before lifting, make sure that the lifting device is capable of carrying the weight of the machine (see "Technical Data") without danger.
- Loading ramps must be stable and stable. The machine is not allowed to drive on public roads.

## 11.2 STORAGE

Storage of the machine for a month or more.

- Thoroughly remove dust, dirt and debris from the engine and the machine. Clean the collecting bag. Clean the engine with a rag. Avoid spraying with a strong stream of water (such as a high-pressure cleaner), as it could get water into the ignition and fuel system and cause it to malfunction.
- Treat all moving parts with an environmentally friendly oil (do not use grease!) And start the machine for a short time (let it run for 1-2 minutes)
- Drain the fuel. Let the engine run until the fuel is exhausted.
- Clean the air filter and replace if heavily soiled or damaged.
- Check the function of all moving parts. Replace damaged or worn parts.
- The collection bag, side-loading hopper, suction nozzle and hose must be checked and replaced if necessary.
- Disconnect the spark plug connector.
- Cover the machine and motor for dust protection and store in a dry, clean place, inaccessible to children and untrained persons.
- Additionally secure the machine against rolling away **by the use of wheel shock**. The machine must not be stored outdoors.

### 13. Troubleshooting Table

Before any troubleshooting

- Switch off the machine
- Wait for the tools to stop
- Disconnect the spark plug connector

SYMPTOM	POSSIBLE CAUSE
The engine won't start.  (Please refer to the engine user manual for engine-specific procedures.)	=> Is the ignition switch in the "ON" position? => Is the fuel shut-off valve on? => Are you using fresh, clean gas? If the gas is old, change it. Use a fuel stabilizer if you keep gas longer than 30 days. => Is the spark plug clean? If the spark plug is dirty or cracked, change it. If it's oily, leave it out, hold a rag over the plug hole and pull the recoil cord several times to blow out any oil in the cylinder, then wipe off the plug and reinsert it.
The engine lacks power or is not running smoothly.  (Please refer to the engine user manual for engine-specific procedures.)	=> Check that the Throttle Lever is in the "Run" position. => Is the air filter clean? If it's dirty, change it following the procedure in the engine manufacturer's owner's manual. => Is the spark plug clean? If it's fouled or cracked, change it. If it's oily, leave it out, hold a rag over the plug hole and pull your recoil cord several times to blow out any oil in the cylinder, then wipe off the plug and reinsert it. => Are you using fresh, clean unleaded petrol? If it's old, change it. Use a fuel stabilizer if you keep petrol longer than 30 days. ? Does your engine have the right amount of clean oil? If it's dirty, change it following the procedure in the engine manufacturer's owner's manual. ? Check the oil level and adjust as needed.
Engine smokes.  (Please refer to the engine user manual for engine-specific procedures.)	=> Check the oil level and adjust as needed. => Check the air filter and clean or replace if needed. => You may be using the wrong oil—too light for the temperature. Refer to your Engine Owner's Manual for detailed information. => Clean the cooling fins if they're dirty.
Excessive vibration	=> <i>Check engine</i> => <i>Check impeller and replace if required</i>
Will not vacuum or has poor vacuum performance	=> Clean debris bag. Shake bag clean or wash => Adjust nozzle height => Check for hose kit cap => Unclog nozzle or exhaust => Allow air to feed with debris
Nozzle scrapes ground	=> Adjust nozzle height
No self-propelling	=> Check forward/reverse gear selection => Check drive lever cable adjustment and belt





FEIDER

**ZI, 32 rue aristide Bergès – 31270 Cugnaux - France**

**Tel : +33 (0)5.34.502.502 Fax : +33 (0)5.34.502.503**

States that the designated below machine:

Model: Leaf&litter vacuum

**FAST200T**

Serial number: **20190829458-20190829477**

is in conformity with the essential requirements and other relevant provisions of the applicable European Directives, based on the application of European harmonized standards.

Any unauthorized modification of the apparatus voids this declaration.

European Directives (including, if applicable, their amendments up to the date of signature):

Machinery Directive 2006/42/EC

EMC Directive 2014/30/EC

Noise directive 2000/14/CE Annex VI + 2005/88/CE

Guaranteed Sound power level: 111 dB(A)

European harmonized standards (including, if applicable, their amendments up to the date of signature):

EN ISO12100:2010

EN 953:1997/A1:2009

EN ISO 13732-1:2008

EN ISO 14982:2009

Done at Cugnaux: 15/08/2019

A handwritten signature in black ink, appearing to read "Philippe MARIE".

Philippe MARIE/PDG

