

# ***Energizer***<sup>®</sup>



**CORDLESS LAWN TRIMMER AND  
BRUSH CUTTER  
EZ40VBEN  
USER GUIDE**

***Energizer***®

©2018 Energizer. Energizer and certain graphic designs are trademarks of Energizer Brands, LLC and related subsidiaries and are used under license by Builder SAS.

All other brand names are trademarks of their respective owners.

Neither Builder SAS nor Energizer Brands, LLC is affiliated with the respective owners of their trademarks

# Let's get started.

You're excited to power up, so we'll keep this brief!

## 1. SAFETY WARNINGS

---

### IMPORTANT READ CAREFULLY BEFORE USE KEEP FOR FUTURE REFERENCE

#### Safe operating practices

##### Training

- a) Read the instructions carefully. Be familiar with the controls and the correct use of the machine.
- b) Never allow children or people unfamiliar with these instructions to use the machine. Local regulations can restrict the age of the operator.
- c) Keep in mind that the operator or user is responsible for accidents or hazards occurring to other people or their property.

##### Preparation

- a) Before use, always visually inspect the machine for damaged, missing or misplaced guards or shields.
- b) Never operate the machine while people, especially **children**, or pets are nearby.

##### Operation

- a) Wear eye protection and stout shoes at all times while operating the machine.
- b) Avoid using the machine in bad weather conditions, especially when there is a risk of lightning.
- c) Use the machine only in daylight or good artificial light.
- d) Never operate the machine with damaged guards or shields, or without guards or shields in place.
- e) Switch on the motor only when the hands and feet are away from the **cutting means**.
- f) Always switch off the tool and remove the battery:
  - 1) Whenever the machine is left unattended;
  - 2) Before clearing a blockage;
  - 3) Before checking, cleaning or working on the machine;
  - 4) After striking a foreign object;
  - 5) Whenever the machine starts vibrating abnormally.
- g) Take care against injury to feet and hands from the **cutting means**.
- h) Always ensure that the ventilation openings are kept clear of debris.

##### Maintenance and storage

- a) Switch off and remove the battery before carrying out maintenance or cleaning work.
- b) Use only the manufacturer's recommended replacement parts and accessories.
- c) Inspect and maintain the machine regularly. Have the machine repaired only by an authorized repairer.
- d) When not in use, store the machine out of the reach of **children**.

- never allow **children**, persons with reduced physical, sensory or mental capabilities or lack of experience and knowledge or people unfamiliar with these instructions to use the machine, local regulations may restrict the age of the operator;
- Never operate the machine while people, especially **children**, or pets are nearby. Keep them at least 15 m away from the machine during its operation.

- Stop using the tool when a risk might occur (people are nearby, dangerous material on the working area, problem with the tool, etc.). Check the working area before working and stay in alert when operating the tool.
- Follow the provided instructions for assembly, use, repairs, maintenance and storage
- Never replace the non-metallic **cutting means** with metallic **cutting means**;
- Do not overreach and keep your balance at all times. Always be sure of your footing on slopes and walk, never run.
- Do not touch moving hazardous parts before the machine is stopped and the moving hazardous parts have come to a complete stop;
- Always wear substantial footwear and long trousers while operating the machine;
- This appliance is not intended for use by persons (including children) with reduced physical, sensory or mental capabilities, or lack of experience and knowledge, unless they have been given supervision or instruction concerning use of the appliance by a person responsible for their safety.
- Children should be supervised to ensure that they do not play with the appliance.
- Stay alert, watch what you are doing and use common sense when operating a power tool. Do not use a power tool while you are tired or under the influence of drugs, alcohol or medication. A moment of inattention while operating power tools may result in serious personal injury.
- Use personal protective equipment. Always wear eye protection. Protective equipment such as dust mask, non-skid safety shoes, hard hat, or hearing protection used for appropriate conditions will reduce personal injuries.
- Prevent unintentional starting. Ensure the switch is in the off-position before connecting the battery pack, picking up or carrying the tool.
- A moving cutting attachment can cause severe injury. Maintain proper control of the machine with both hands until the cutting attachment has completely stopped rotating.
- Replace any cutting attachment that has been damaged. Always make sure that the cutting attachment is installed correctly and securely fastened before each use.
- Use only accessories recommended by manufacturer. Non-recommended accessories can cause injuries and accidents. Contact your dealer or our service agent.
- Always use the harness provided when operating the tool.
- Cover the blade with the blade protector before storing the unit, or during transportation. Always remove the blade protector before using the unit. If not removed, the blade protector could become a thrown object as the blade begins to turn.
- Do not expose the tool to rain and humidity.
- In case of abnormal vibrations, stop immediately using the tool and remove the battery; check if all screws are firmly tightened, and if the cutting means are correctly assembled. In case of doubt, bring the tool to our agent service for inspection.
- Always start the tool safely: tools correctly and fully assembled, foot and body far from the cutting means, harness installed and used.
- Always inspect the tool before and after the operation for signs of damage such as cracks in the cutting attachment or ageing. In case of damages or ageing, bring the tool to our agent service for inspection and reparation.
- Check the tool for loose fasteners. Tighten safely loose fasteners.
- Never operate the machine with defective guards or shields, or without safety devices.
- Always use the tool with the battery fully charged. Before use, check the charge level and charge the battery if necessary.

- In case of accident or breakdown, stop immediately using the tool and remove the battery. Check the breakdown or accident, repair the tool if necessary. Bring the tool to a service agent if necessary.
- Do not replace the blade with metal multi-piece pivoting chains and flail blades; this type of blade must not be used with this tool.
- Stop the machine and allow it to cool before storing or transporting. Do not store or transport the machine with batteries fitted, remove and secure separately
- Clean all foreign material from the product. Store it in a cool, dry, and well-ventilated place that is inaccessible to children. Keep away from corrosive agents such as garden chemicals and de-icing salts. Do not store outdoors.
- Cover the blade with the blade protector before storing the unit, or during transportation.
- For transportation, secure the machine against movement or falling to prevent injury to persons or damage to the machine.
- Use only original manufacturer's replacement parts, accessories and attachments. Failure to do so can cause possible injury, poor performance and may void your warranty. You may make adjustments and repairs described here. For other repairs, contact the authorized service agent.
- Before any maintenance or adjustment, stop the tool and remove the battery.
- After extending new cutter line or cleaning, checking the blade, always return the product to its normal operating position before starting.
- After each use, clean the product with a soft dry cloth.
- Check all nuts, bolts and screws at frequent intervals for proper tightness to ensure the product is in safe working condition. Any part that is damaged should be properly repaired or replaced by an authorized service centre.

## **RESIDUAL RISK**

Even when the product is used as prescribed, it is still impossible to completely eliminate certain residual risk factors. The following hazards may arise in use and the operator should pay special attention to avoid the following:

- Injury caused by vibration. Always use the right tool for the job, use designated handles and restrict working time and exposure.
- Exposure to noise can cause hearing injury. Wear ear protection and limit exposure
- Kickback can occur when using the brush cutter. Ensure proper control by using both hands on the designated handles. Read and follow the directions elsewhere in this manual to help reduce the risk of kickback.
- Injuries may be caused, or aggravated, by prolonged use of a tool. When using any tool for prolonged periods, ensure you take regular breaks.

## **INTENDED USE**











### **Brush cutter**

The product is intended for cutting long grass, pulpy weed, brush and similar vegetation at or about ground level. The product is not allowed to be used for cutting or chopping hedges, shrubs, bushes, flowers and compost.

### **Trimmer**

The product is designed for cutting grass and light weeds only in private garden areas. The product is not allowed to be used in public gardens, parks, sports centers or at roadsides as well as for agricultural and forestry use. The product is not allowed to be used for cutting or chopping hedges, shrubs, bushes, flowers and compost.

### **Symbol**

 	<p>Read the instruction manual</p>
	<p>Risk of projection. Keep bystander away (at least 15 m)</p>
	<p>Do not expose the tool to rain or humidity</p>
 	<p>Wear hearing protection and ocular protection</p>
	<p>Wear protection gloves</p>
	<p>Wear protective and non-skid shoes</p>
	<p>Wear a protective helmet</p>
	<p>Wear protective equipment (helmet, hearing and ocular protection)</p>
	<p>Caution! The tool can contact a voluminous material. Loss of control and injuries can be created.</p>
	<p>People must kept away from the work area</p>
	<p>Guarantee sound power level</p>
	<p>Do not use saw blade</p>

## 2. PRODUCT

### Description

1. Safety lock button
2. Trigger
3. Rear handle
4. Front handle
5. Drive tube
6. String cutter guard
7. Blade cutter guard
8. String head
9. Two speed button
10. Blade (3 teethes)
11. Battery compartment

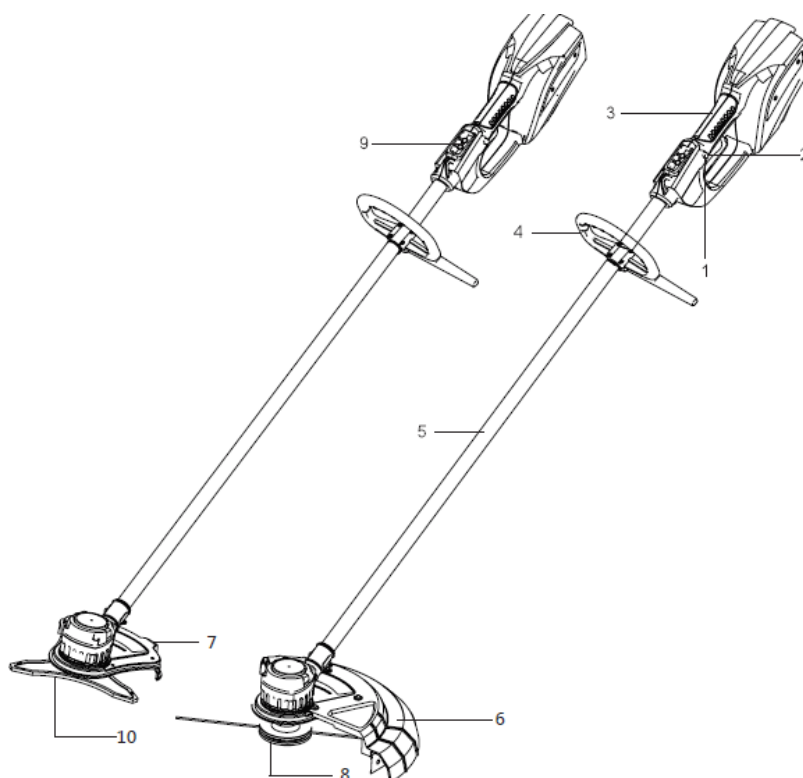

The tool is provided with screws, bolts, wrenches, safety belt and mounting tool.

### Technical data

Machine mass	5,1 kg (lawn trimmer), 5,4 kg (brush cutter) Max. 5,5 kg with battery pack
Cutting attachments (type, diameter for blades),	Blade: 260mm (3 teethes blade) Lawn trimmer: 330/380 mm (nylon wire)
Voltage	36V --- (40V max)
Maximum rotational frequency of the spindle	Max. 6500/min
Vibration total value	2,0m/s <sup>2</sup> k= 1,5m/s <sup>2</sup>
Sound pressure level	Lawn trimmer - Lpa: 78,1 dB(A) Brush cutter - Lpa: 76,7 dB(A)
Sound power level	Lawn trimmer - Lwa: 93,7 dB(A) Brush cutter Lwa: 90,9 dB(A)
Sound pressure level emitted by the machine	82 dB(A)
Uncertainty K	Kpa: 3 dB(A) Lwa: 0,93 dB(A)
Guarantee sound power level	Lwa: 96 dB(A)



### 3. ASSEMBLY

---

#### a. Front handle

Install the front handle on the bar and screw it with the 4 screws and bolts provided.



#### b. Cutting attachment

##### Brush cutter

**When working with the metal cutting blade, wear gloves. Be careful of the sharp edges.**

- On the shaft, install the upper blade and the little carter of protection and screw it with the provided screws.
- Insert in the following order: cutting blade, the lower plate, the cover bell and the holding nut.
- Secure the shaft by inserting a metal rod on the side of the drive gear and on the tool drive.
- Tighten the retaining nut counterclockwise with the supplied wrench.
- Remove then the protection from the cutting blade.



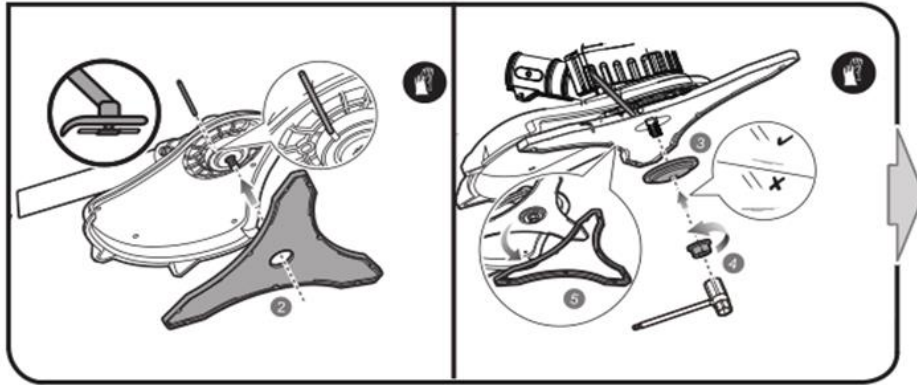

**Lawn trimmer**

- On the shaft, install the upper plate.
- Secure the shaft by inserting a metal rod on the side of the drive gear and on the tool drive.
- Screw on the shaft the nylon cutting head
- Install on the carter of protection the other part of the carter and screw it in place with the provided screws.

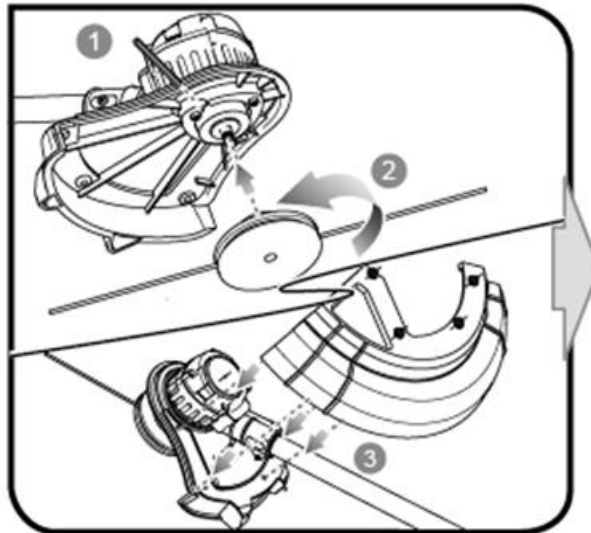

**Assembly/replacement of the nylon**

- If the cutting head is delivered non- assembled:
  - Turn the cutting head. Install two nylon wires on the cutting head/
  - To replace them, stop the tool; remove the cutting head and change the nylon wire like above.



**NOTE:**

- DO NOT ATTEMPT TO USE BOTH FUNCTIONS IN THE SAME TIME. RISK OF SERIOUS INCIDENTS AND INJURIES.
- ALWAYS INSTALL THE CARTER OF PROTECTION WHEN USING THE TOOL AND AS EXPLAINED THIS INSTRUCTIONS: THE LITTLE CARTER FOR BRUSHCUTTING AND THE BIG ONE (WITH THE SECOND PART) FOR LAWNTRIMMING.

**SAFETY BELT**



**BATTERY**

To charge the battery:

- Remove the battery from the tool
- Plug the charger to a power socket. Then plug the charger to the battery.

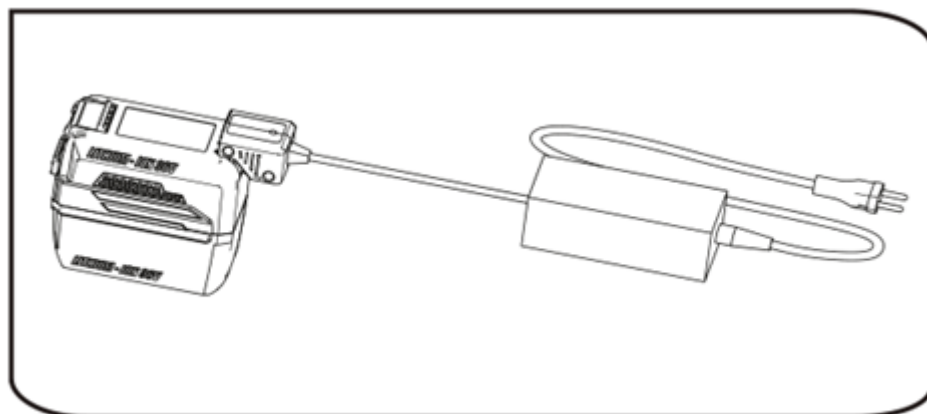
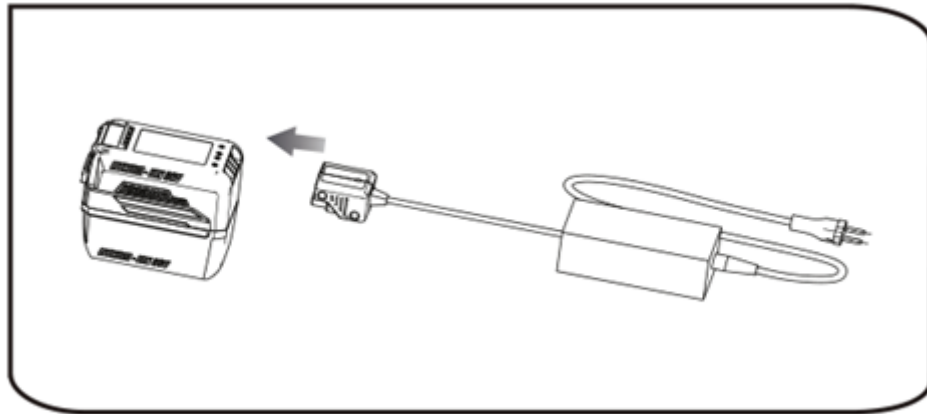

## OPERATION

---

- 1) Place the battery in the tool. Align the grooves in the battery with those in the battery compartment. Push the battery into its compartment to lock it in place. Make sure that the battery is properly installed to avoid any incident.
- 2) Press the switch lock button first, and then press the trigger switch. Release the trigger switch to stop.

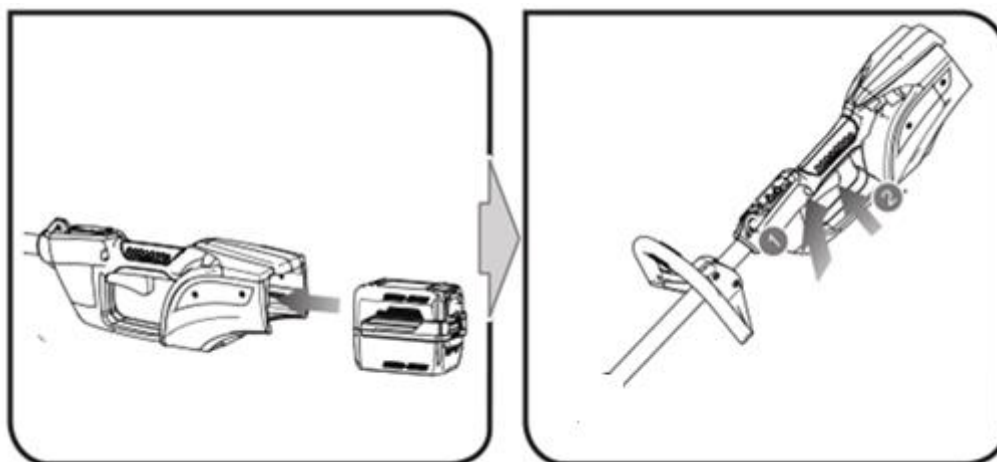

### 3) **Tips of operation**

Do not use the device without the carter of protection. Before each use, make sure that the appliance is functional. When working with the electric brush cutter, always wear protective equipment.

Protect yourself from noise and comply with local regulations. The use of the device may be prohibited or limited on certain days (Sundays and holidays), at certain times (noon, evening), or in certain areas (spas, clinics).

- Always wear appropriate harness and protective clothing during use.
- When starting or working, make sure that the cutting head does not touch any stone, gravel, wire or other foreign matter.
- During use, avoid too much effort on the equipment.
- Avoid contact with fixed objects (rock, wall, fence, batten, etc.). Use the crankcase edge to maintain the correct distance.
- Do not run with the machine running. This can cause damage.
- Start the unit before approaching the lawn.
- Cut the tall grass in several stages from top to bottom.
- Do not cut damp or wet grass.

### **WORKING WITH THE CUTTING HEAD**

- Short or worn wires cut badly. If there is an inefficient cut, replace the nylon wire.
- During use, hold the cutting head just above the floor at all times and gently rotate the unit. Cut gently and keep the machine tilted about 30 ° forward.

### **WORKING WITH THE METAL BLADE**

**Make sure the blade is properly mounted. Replace damaged or blunt blades. There is a risk of injury!**

- Blades cut only free surfaces. Inspect the area thoroughly and remove any foreign matter. Avoid impacts with stones, metal or other obstacles. The blades could be damaged and there is a risk of retro-shock
- Inspect the damaged blades regularly and replace if necessary.
- Do not use the appliance to cut rejects or thickets.
- During use, hold the head above the floor and rotate the appliance like a regular left and right arc.

- Do not hold the cutting head tilted

## **MAINTENANCE AND STORAGE**

**Hold and pull the tab and remove the batter before working on the appliance, If work is not described in this manual, it must be done by the authorized service. Use original parts and be careful when installing the cutting blade. There is a risk of injury! Never use worn or non-original parts. Use only genuine parts. Never use metal wires. Use of non-original parts may result in adverse health effects and irreparable damage to the unit and immediately voids the warranty.**

## **REPLACING THE CUTTING HEAD AND NYLON WIRE**

- Turn the tool upwards to raise the head.
- Block the shaft by putting a tool in the hole of the shaft
- Unscrew the cutting head.
- To reload the cutting head with wire, remove first the current wire. Then insert in the holes of cutting head news wires. 4 wires can be added.

## **REPLACING THE BLADE**

Replace the blade when it is damaged, worn or used.

- Unscrew the holding nut. Then remove the cover bell and the lower plate.
- Replace the blade by a new one
- Replace the lower plate cover bell and fix them by screwing the holding nut in place.

## **CLEANING**

- Clean and maintain the appliance regularly. This will ensure performance and durability.
- After each use, remove the grass and soil from the brush cutter and the safety guard.
- Clean the appliance with a soft brush or cloth.

Do not spray water on the appliance or soak it in water. Do not use detergent or solvent. The device would be irreparably damaged. Chemicals can attack the plastic parts of the device.

## **SERVICE AND SPARE PARTS**

Have your appliance checked by qualified personnel using original parts. This will ensure the safety of the tool. If you require technical advice, repairs or genuine parts, contact the SWAP service nearest you. For information or places of service, go to: [www.swap-europe.com](http://www.swap-europe.com). When ordering spare parts, please indicate the part number, you can find them at: [www.swap-europe.com](http://www.swap-europe.com).

## **STORAGE**

- Clean your appliance and its accessories after each use. This prevents the formation of clusters.
- Store the device in a dry place away from dust and out of reach of children.
- Do not store the unit in direct sunlight.
- Do not place the appliance in plastic bags as mildew may appear.
- Do not place the unit under a protective cover. Hang it on a wall with the top of the handle.



## **WARRANTY**

The manufacturer warrants the product against defects in materials and workmanship for a period of 2 years from the date of purchase to the original purchaser. The guarantee applies when the product is used as a home tool. The warranty does not extend for failures due to normal wear and tear.

The manufacturer agrees to replace the spare parts that are classified as defective by a designated distributor. The manufacturer will not accept responsibility for the replacement of the machine, either partially or in full, and / or consequential damages.

The warranty does not cover failures due to:

- Insufficient maintenance.
- Assembly, adjustment or abnormal operation of the product.
- Spare parts that are subject to wear.

Nor does the guarantee extend to:

- Cost of freight and packaging.
- The use of the tool for any other purpose than for which it was designed
- Use and maintenance of the machine in a manner not described in the user's manual.

As part of our policy of continuous product improvement, we reserve the right to alter or modify specifications without prior notice. As a result, the product may differ from the information contained herein, but any alteration will only be implemented without prior notice if it is classified as an improvement of the previous specification.

**READ THE MANUAL CAREFULLY BEFORE USING THE MACHINE.**

When ordering spare parts, please quote the part number or code, this can be found in the parts list included in this manual.

Keep the purchase receipt; Without it, no guarantee will be valid.

In order to get help about your brush cutter we invite you to go through this link or to call us by phone  
+33 (0)8.20.20.22.68:

<https://services.swap-europe.com/contact>

You need to create a "ticket" via their platform.

- Login or create your account
- Put your tool reference
- Choose the subject of your request
- Explain your problem
- Attach these files: the invoice or receipt, the nameplate picture (serial number), the picture of the part you need (for example: pins on the transformer plug that broke away)

We offer you a warranty extension to 1 year. To profit it, please follow the below proceeding:

- Connect on the website:
- Insert your contact details
- Register your tool with:
  - The reference
  - The serial number
  - The date you bought the tool
- Generate automatically the PDF warranty certificate and print it.

## CE DECLARATION

---

### BUILDER SAS

ZI, 32, rue Aristide Bergès – 31270 Cugnaux - France

Tel: +33 (0)5.34.502.502 Fax: +33 (0)5.34.502.503

Declares that the machine:

### Cordless Lawn Trimmer and Brush Cutter

### EZ40VBEN

### Serial No:

The people name holding the technical file: Mr Olivier Patriarca

Have been designed in compliance with the following standards:

EN ISO 11806-1:2011

EN 50636-2-91:2014

EN 60335-1:2012+A11:2014

EN 55014-1:2006+A1:2009+A2:2011

EN 55014-2:2015

And in accordance with the following directives:

Directive Machine 2006/42/EC

Directive EMC 2014/30/EU

Noise Directive 2000/14/EC Annex VI & Directive 2005/88/EC

sound pressure level	Lawn trimmer – Lpa: 78,1 dB(A) Brush cutter – Lpa: 76,7 dB(A)
sound power level	Lawn trimmer – Lwa: 93,7 dB(A) Brush cutter Lwa: 90,9 dB(A)
Guarantee sound power level	Lwa: 96 dB(A)

Hyundai battery model (HBAT40V4-A) is same with the factory model (TPBT3640).

Philippe MARIE / PDG

Cugnaux, 04-12-2018





## DISPOSAL

---

Electrical products should not be discarded with household products. According to the European Directive 2012/19/EU on waste electrical and electronic equipment and its implementation into national law, electrical products used must be collected separately and disposed of at collection points provided for this purpose. Talk with your local authorities or dealer for advice on recycling.

