

Energizer[®]



CORDLESS GRASS TRIMMER EZ20VCBC-UK USER GUIDE

Energizer®

©2019 Energizer. Energizer and certain graphic designs are trademarks of Energizer Brands, LLC and related subsidiaries and are used under license by Builder SAS.

All other brand names are trademarks of their respective owners.

Neither Builder SAS nor Energizer Brands, LLC is affiliated with the respective owners of their trademarks

Let's get started.

You're excited to power up, so we'll keep this brief!

1. SAFETY WARNINGS



WARNING Read all safety warnings and all instructions. *Failure to follow the warnings and instructions may result in electric shock, fire and/or serious injury.*
Save all warnings and instructions for future reference. *The term "power tool" in the warnings refers to your mains-operated (corded) power tool or battery-operated (cordless) power tool.*

1) Work area safety

- a) **Keep work area clean and well lit.** *Cluttered or dark areas invite accidents.*
- b) **Do not operate power tools in explosive atmospheres, such as in the presence of flammable liquids, gases or dust.** *Power tools create sparks which may ignite the dust or fumes.*
- c) **Keep children and bystanders away while operating a power tool.** *Distractions can cause you to lose control.*

2) Electrical safety

- a) **Power tool plugs must match the outlet. Never modify the plug in any way. Do not use any adapter plugs with earthed (grounded) power tools.** *Unmodified plugs and matching outlets will reduce risk of electric shock.*
- b) **Avoid body contact with earthed or grounded surfaces, such as pipes, radiators, ranges and refrigerators.** *There is an increased risk of electric shock if your body is earthed or grounded.*
- c) **Do not expose power tools to rain or wet conditions.** *Water entering a power tool will increase the risk of electric shock.*
- d) **Do not abuse the cord. Never use the cord for carrying, pulling or unplugging the power tool. Keep cord away from heat, oil, sharp edges or moving parts.** *Damaged or entangled cords increase the risk of electric shock.*
- e) **When operating a power tool outdoors, use an extension cord suitable for outdoor use.** *Use of a cord suitable for outdoor use reduces the risk of electric shock.*
- f) **If operating a power tool in a damp location is unavoidable, use a residual current device (RCD) protected supply.** *Use of an RCD reduces the risk of electric shock.*

3) Personal safety

- a) **Stay alert, watch what you are doing and use common sense when operating a power tool. Do not use a power tool while you are tired or under the influence of drugs, alcohol or medication.** *A moment of inattention while operating power tools may result in serious personal injury.*
- b) **Use personal protective equipment. Always wear eye protection.** *Protective equipment such as dust mask, non-skid safety shoes, hard hat, or hearing protection used for appropriate conditions will reduce personal injuries.*
- c) **Prevent unintentional starting. Ensure the switch is in the off-position connecting to power source and/or battery pack, picking up or carrying the tool.** *Carrying power tools with your finger on the switch or energizing power tools that have the switch on invites accidents.*
- d) **Remove any adjusting key or wrench before turning the power tool on.** *A wrench or a key left attached to a rotating part of the power tool may result in personal injury.*
- e) **Do not overreach. Keep proper footing and balance at all times.** *This enables better control of the power tool in unexpected situations.*
- f) **Dress properly. Do not wear loose clothing or jewelry. Keep your hair, clothing and gloves away from moving parts.** *Loose clothes, jewelry or long hair can be caught in moving parts.*
- g) **If devices are provided for the connection of dust extraction and collection facilities, ensure these are connected and properly used.** *Use of dust collection can reduce dust-related hazards.*

4) Power tool use and care

- a) **Do not force the power tool. Use the correct power tool for your application.** *The correct power tool will do the job better and safer at the rate for which it was designed.*
- b) **Do not use the power tool if the switch does not turn it on and off.** *Any power tool that cannot be controlled with the switch is dangerous and must be repaired.*

c) Disconnect the plug from the power source and/or the battery pack from the power tool before making any adjustments, changing accessories, or storing power tools.

Such preventive safety measures reduce the risk of starting the power tool accidentally.

d) Store idle power tools out of the reach of children and do not allow persons unfamiliar with the power tool or these instructions to operate the power tool. Power tools are dangerous in the hands of untrained users.

e) Maintain power tools. Check for misalignment or binding of moving parts, breakage of parts and any other condition that may affect the power tool's operation. If damaged, have the power tool repaired before use. Many accidents are caused by poorly maintained power tools.

f) Keep cutting tools sharp and clean. Properly maintained cutting tools with sharp cutting edges are less likely to bind and are easier to control.

g) Use the power tool, accessories and tool bits etc. in accordance with these instructions, taking into account the working conditions and the work to be performed.

Use of the power tool for operations different from those intended could result in a hazardous situation.

5) Battery tool use and care

a) Recharge only with the charger specified by the manufacturer. A charger that is suitable for one type of battery pack may create a risk of fire when used with another battery pack.

b) Use power tools only with specifically designated battery packs. Use of any other battery packs may create a risk of injury and fire.

c) When battery pack is not in use, keep it away from other metal objects, like paper clips, coins, keys, nails, screws or other small metal objects, that can make a connection from one terminal to another. Shorting the battery terminals together may cause burns or a fire.

d) Under abusive conditions, liquid may be ejected from the battery; avoid contact. If contact accidentally occurs, flush with water. If liquid contacts eyes, additionally seek medical help. Liquid ejected from the battery may cause irritation or burns.

6) Service

a) Have your power tool serviced by a qualified repair person using only identical replacement parts. This will ensure that the safety of the power tool is maintained

ADDITIONAL SAFETY RULES FOR GRASS TRIMMER

- Danger! The cutting elements continue to rotate after the motor is switched off
- Before use check the tool and battery about signs of damage or ageing. If there are damages or ageing, do not use the tool and bring it to a qualified service for inspections and reparations.
- Read the instruction carefully. Be familiar with the controls and proper use of the equipment.
- Local regulation may restrict the age of the operator.**
- Always wear substantial footwear and long trousers while operating the machine**
- Wear ear, eye and dust protection at all times. Wear also helmet, gloves and protection clothes.
- Never allow children, people unfamiliar with these instructions to use the trimmer.
- Avoid using the trimmer while people, especially children, infirm people or pets, are nearby.
- Use the trimmer only in daylight or good artificial light.
- Never operate the trimmer with damaged guards or shields or without guards or shields in place.
- Switch on the motor only when the hands and feet are away from the cutting means.
- Never fit metal cutting elements.
- Use only the manufacturer's recommended replacement parts and accessories.
- Switch off and remove the battery when leaving the trimmer unattended.
- Switch off and remove the battery before carrying out maintenance or cleaning work.
- Inspect and maintain the trimmer regularly. Have the trimmer repaired only by an authorised repairer.
- Take care against injury from the cutting lines. After extending new cutter line or replacing the spool line. Always return the trimmer to its normal operating position before switching on.

- When not in use, store the trimmer out of the reach of children and infirm people.
- Periodically inspect the condition of the cutting head. If the spool is damaged, switch off; replace the spool by a new one.
- Do not use the machine to cut grass, which is not on the ground. For example, do not cut grass, which is on walls or rocks.
- Do not switch on the machine in enclosed or poorly ventilated spaces or in the presence of inflammable and /or explosive substances such as liquid, gases and powders.
- Always stop the trimmer and remove the battery when cutting is delayed or when walking from one cutting location to another.
- Do not cross roads or gravel paths with machine still running.
- Only use the machine according to the instructions given in this manual.
- Do not extend the trimming line beyond the guard and do not operate the trimmer without both lines extended and proper line installed.
- Check regularly that the nuts, bolts and screws are tight.
- Disconnect the supply (e.g. remove the plug from the mains or remove the disabling device):
 - whenever the machine is left by the user;
 - before clearing a blockage;
 - before checking, cleaning or working on the machine;
 - after striking a foreign object to inspect the machine for damage
 - if the machine starts to vibrate abnormally, for immediately check;
- Never to replace the non-metallic cutting means with metallic cutting means.
- Do not overreach and to keep the balance at all times.
- Always be sure of the footing on slopes.
- Walk, never run.
- Warning! Do not touch moving hazardous parts before the machine is disconnected from the mains. The moving hazardous parts have come to a complete stop;
- Avoid using the machine in bad weather conditions especially when there is a risk of lightning;
- In case of abnormal vibration, immediately stop to use the machine. When the machine is in a complete stop, inspect the tool and bring to our service agent if necessary.

Intended Use

This tool is designed to cut the grass, as well as the edges of the flowerbeds. Do not use it for other activities. Any use of this product for any purpose other than that described in this manual may cause damage to the unit or result in serious injury to the user. Specially design to work with Energizer range of battery and charger.

Residual risks

- Cuts from the blade
- Inhalation of particles of material to be cut
- Projection of the parts of the cutting blades
- Contact with uncovered cutting head (wounds, cuts)
- Contact with tool in operation (injuries, cuts)
- Development of toxic dusts / fumes when used in confined spaces (vomiting / nausea)
- Hearing loss in the absence of proper hearing protection

WARNING! This machine generates an electromagnetic field during its operation. This field may under certain circumstances disrupt the functioning of active or passive medical implants. To reduce the risk of serious injury or death, people with medical implants should consult with their physician and the implant manufacturer before using this machine.

Symbols



Warning symbol



Read the instructions manual



Wear an ocular protection



Wear a hearing protection



Do not expose to rain or humidity



Risk of projections. Keep bystanders away



Remove the battery when the tool is damaged and before maintenance and servicing. Read the instruction manual



Guarantee sound power level



Do not use metal blades



Wear protection gloves

2. YOUR PRODUCT

a. Description

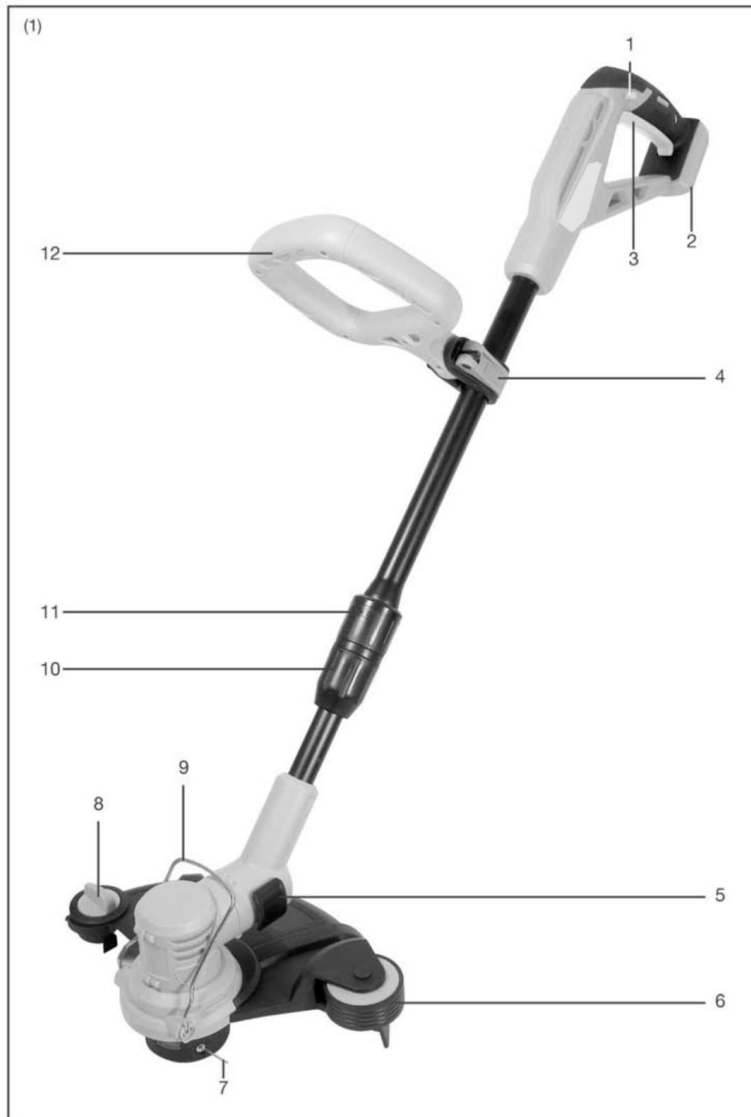

- | | |
|-----------------------------------|---------------------------------------|
| 1. ON/OFF trigger lock-out button | 7. Single line cutting spool |
| 2. Battery port | 8. Line cutting blade adjustment dial |
| 3. ON/OFF trigger | 9. Guide |
| 4. Assist handle locking lever | 10. Shaft length adjuster lock |
| 5. Edger adjustment button | 11. Shaft angle adjuster lock |
| 6. Edging guide wheel | 12. Auxiliary assist handle |

b. **Technical data**

Voltage	20V d.c.
No load speed	7200/min
Cutting width	250/300 mm
Mass	2,74 kg
Sound Pressure level LpA	85 dB(A) K=3dB(A)
Measured sound power level	89 dB(A) K=3dB(A)
Guarantee sound Power level LwA	96dB(A)
Vibration Level	2.5 m/s ² K=1.5m/s ²

Information

- The declared vibration total value has been measured in accordance with a standard test method and may be used for comparing one tool with another;
- The declared vibration total value may also be used in a preliminary assessment of exposure.

Warning

- That the vibration emission during actual use of the power tool can differ from the declared total value depending on the ways in which the tool is used;
- the need to identify safety measures to protect the operator that are based on an estimation of exposure in the actual conditions of use (taking account of all parts of the operating cycle such as the times when the tool is switched off and when it is running idle in addition to the trigger time).

Wear hearing protection.

3. ASSEMBLY

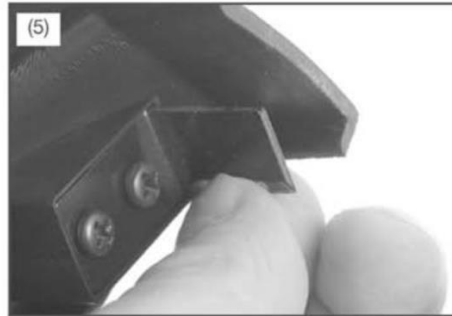
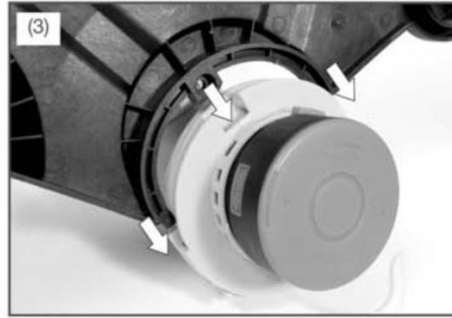

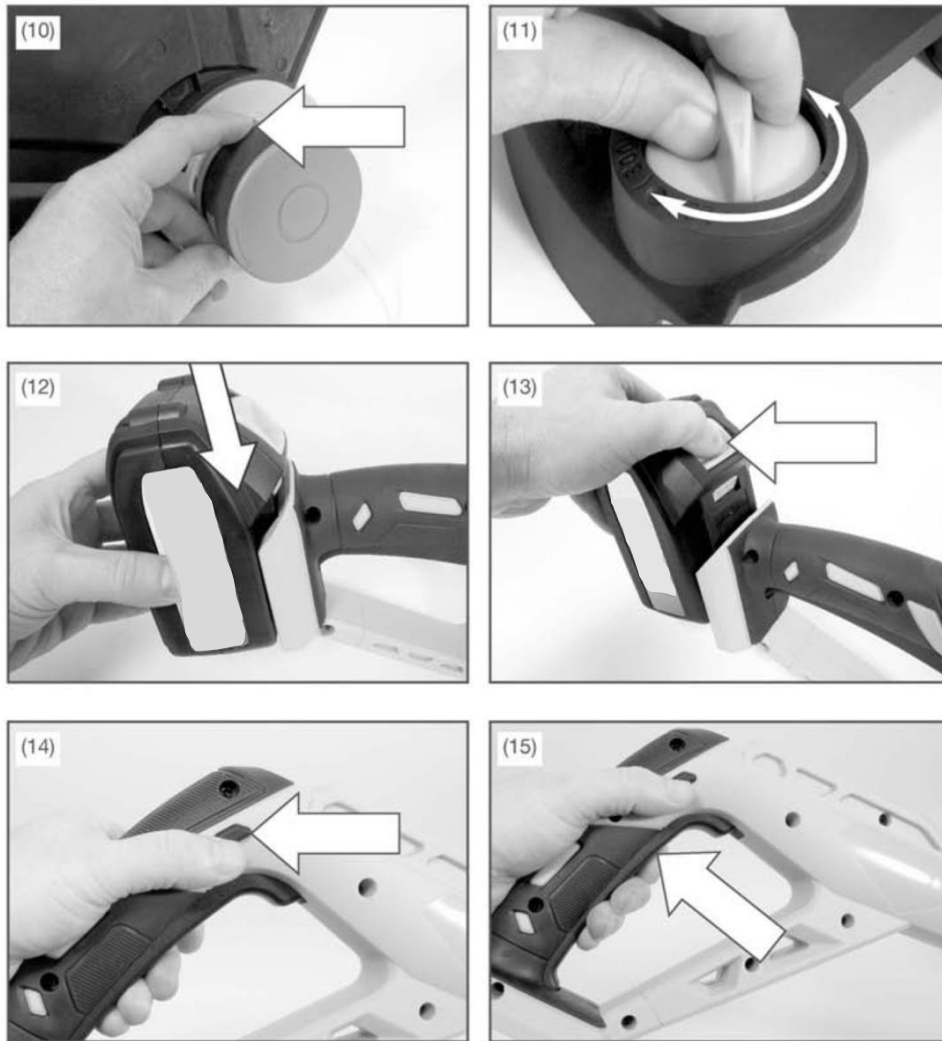





a. **Charging**

Energizer range battery and charger not sold together with this tool. Battery has not been fully charged at the factory.

Before using it for the first time, charge the battery for 60min to 130min. Insert the charger plug into the charging socket and plug the charger into a 230V/50Hz electrical outlet. Detailed information please read carefully the manual for battery and charger.

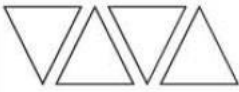
Charge status

To display the amount of charge left in the battery, press the charge level indicator button, Fig.2.

Charge level indicator	Amount of charge remaining
	0-10%
	10-25%
	25-50%
	50-75%
	75-100%

x

b. ATTACHING THE GUARD

Remove the battery pack. Invert the grass trimmer/edger to access the trimmer head. Remove the pre-installed screw from the trimmer head. Place the guard on to the trimmer head so that the large part of the guard sits to the rear, Fig.3. Align the screw hole on the guard with the screw hole on the trimmer head. Insert the screw into the trimmer head, fastening the guard in place. Fig.4. Remove the protective tape from the line cutting blade, Fig.5.

c. ADJUSTING THE AUXILIARY HANDLE

To avoid injury, adjust the auxiliary handle for optimum control and balance. Do not overreach when operating grass trimmer/edger. Keep proper balance at all times for better control of the tool in unexpected situations. The auxiliary handle can be moved either up and down the shaft, forward and backwards or rotated 360° around the shaft. To find your optimum desired position unlock the assist handle locking lever by pulling outwards, Fig.6. Once you have the desired position relock the assist handle locking lever by pushing inwards.

d. ADJUSTING THE SHAFT LENGTH

Loosen the lower part of the centre collar (Fig.7). This will allow the lower part of the shaft to be extended or retracted. When the shaft is at a comfortable length, retighten the collar.

e. **ROTATING THE SHAFT**

The shaft can be rotated to the 0° or 180° position for trimming and edging operations. Pull the upper part of the centre collar (Fig.8). This will allow the motor to be rotated between the 0° and 180° position.

Note: The head will only lock in the 0 or 180° position.

f. **ROTATING THE TRIMMER HEAD**

The trimmer head can be rotated to the 0° or 90° position for trimming and edging operations.

Press the Edger adjustment button, Fig.9, and the trimmer head will spring around 90°. Make sure it is locked into place. To move the trimmer head back simply press the Edger adjustment button again and rotate back to its original position.

g. **EXTENDING THE LINE**

To extend the line press the spool line extension button on the spool, Fig.10.

Warning! To prevent accidental starting that could cause serious personal injury, always remove the battery pack from the product when extending the line.

h. **ADJUSTING THE LINE CUTTING BLADE**

The cutting line can be set at two lengths (250 & 300 mm). To adjust the line cutting blade turn the Line cutting blade adjustment dial by pushing down and rotating 180°, Fig.11.

i. **INSTALLING THE BATTERY PACK**

Warning! Always remove battery pack from your tool when you are assembling parts, making adjustments, cleaning, carrying, transporting or when not in use. Removing battery pack will prevent accidental starting that could cause serious personal injury.

NOTE: To avoid serious personal injury, always remove the battery pack and keep hands clear of the lock-out button when carrying or transporting the tool.

Slide the battery pack into the tool base, Fig 12. (Note the battery has raised ribs which allows it to fit into the tool only one way). Make sure the battery pack snaps into place and that battery pack is secured in the tool before beginning operation. Improper installation of the battery pack can cause damage to internal components.

j. **REMOVING THE BATTERY PACK**

Locate the battery release catch on the top of the battery and press downwards, Fig 13. Whilst holding down the battery release catch slide the battery pack away from the tool

4. OPERATION

To avoid injury:

**Do not squeeze the trigger while the grass trimmer/edger is inverted.
Do not carry the grass trimmer/edger with your finger on the switch. Avoid unintentional starting.**

a. **TURNING ON AND OFF**

Press and hold the On/Off trigger lock-out button, Fig.14.

Depress the On/Off trigger, Fig.15.

Caution: Always allow 5 seconds or more for the cutting line spool to stop rotating after releasing the trigger switch. Do not invert the grass trimmer/edger, or place your hands under the protective guard until the grass trimmer/edger spool has come to a complete stop.

b. **PREPARING TO WORK**

Ensure that the battery is not inserted in its compartment.

Before starting work please:

Check that the trigger switches and the safety switch should move freely without forcing and return automatically and rapidly back to their neutral position;

Check that the cooling air vents are not obstructed;

Check that hand grips and protection devices are clean and dry, correctly mounted and well fastened to the tool;

Check that the tool is not showing signs of wear or damage due to knocks or other causes, and carry out the necessary repairs.

Check that the battery is in good working condition and there are no signs of damage.

Never use the tool with a damaged or worn battery;

Charge the battery according to the instructions in the charging section.

c. **TRIMMING AND EDGING**

For the most effective grass trimming, ensure the tool is operating at full speed and then use slow shallow sweeps of the line, ensuring that you do not overload the tool by cutting too fast or cutting through heavy terrain.

Make sure that the work area is free of rock, debris, lines and other foreign objects.

Start the tool before approaching the grass to be cut.

Cut the grass by swinging the tool from right to left and proceed slowly keeping the trimmer inclined forwards at an angle of about 30°. Light cuts are better than heavy cuts as they allow the cut grass to fall away from the spool preventing the grass from clogging the spool.

High grass should be cut in layers always beginning from the top. Do not cut damp or wet grass. Do not overload your tool.

Avoid wearing the line out quickly by knocking against hard objects (stones, walls, fences etc.).

Watch out for kickback in the events of impact with hard objects.

After finishing the cutting operation, keep the head close to ground level, release the trigger switch and allow the motor to come to a complete stand still. Place the trimmer on the ground, remove the battery.

For edging, rotate the motor head.

Note. Periodically clean out the grass between the spool and the rim of the guard to prevent the tool from vibrating.

5. MAINTENANCE AND STORAGE

Warning! To prevent accidental starting that could cause serious personal injury; always remove the battery pack from the product before adjusting, inspecting, or cleaning. Never disassemble the tool or carry out any repairs. Always have the trimmer and charger maintained or repaired by a competent person at an authorised service centre. Warning! There is danger of moving hazardous parts. Let the tool completely stop and remove battery before user maintenance.

a. **CLEANING**

After each use, remove the battery pack. Brush or blow dust and debris out of the air vent using compressed air or a vacuum. Keep the air vents free of obstructions, sawdust, and wood chips. Do not sprays, wash, or immerse the air vents in water.

Wipe off the housing and the plastic components using a moist, soft cloth. Do not use strong solvents or detergents on the plastic housing or plastic components. Certain household cleaners may cause damage, and may cause a shock hazard.

b. **STORAGE**

Clean the grass trimmer thoroughly before storing. Store the grass trimmer in a dry, well-ventilated place that is inaccessible to children. Keep away from corrosive agents such as garden chemicals and dicing salts.

Always place blade cover on cutting blades before storing.

Store and charge your batteries in a cool area. Temperatures above or below normal room temperature will shorten battery pack life.

Never store batteries in a discharged condition. Wait for battery pack to cool and fully charge immediately.

All batteries gradually lose their charge. The higher the temperature, the quicker they lose their charge. If you store your unit for long periods of time without using it, recharge the batteries every month or two. This practice will prolong battery pack life.

c. **Repairs**

All repairs and the replacement of accessories shall be done by our service agent.



6. DISPOSAL



Electrical products should not be discarded with household products. According to the European Directive 2012/19/EU on waste electrical and electronic equipment and its implementation into national law, electrical products used must be collected separately and disposed of at collection points provided for this purpose. Talk with your local authorities or dealer for advice on recycling.



WARRANTY

The manufacturer warrants the product against defects in materials and workmanship for a period of 2 years from the date of purchase to the original purchaser. The guarantee applies when the product is used as a home tool. The warranty does not extend for failures due to normal wear and tear.

The manufacturer agrees to replace the spare parts that are classified as defective by a designated distributor. The manufacturer will not accept responsibility for the replacement of the machine, either partially or in full, and / or consequential damages.

The warranty does not cover failures due to:

- Insufficient maintenance.
- Assembly, adjustment or abnormal operation of the product.
- Spare parts that are subject to wear.

Nor does the guarantee extend to:

- Cost of freight and packaging.
- The use of the tool for any other purpose than for which it was designed
- Use and maintenance of the machine in a manner not described in the user's manual.

As part of our policy of continuous product improvement, we reserve the right to alter or modify specifications without prior notice. As a result, the product may differ from the information contained herein, but any alteration will only be implemented without prior notice if it is classified as an improvement of the previous specification.

READ THE MANUAL CAREFULLY BEFORE USING THE MACHINE.

When ordering spare parts, please quote the part number or code, this can be found in the parts list included in this manual.

Keep the purchase receipt; Without it, no guarantee will be valid.

In order to get help about your grass trimmer we invite you to go through this link or to call us by phone +33 (0)8.20.20.22.68:

<https://services.swap-europe.com/contact>

You need to create a "ticket" via their platform.

- Login or create your account
- Put your tool reference
- Choose the subject of your request
- Explain your problem
- Attach these files: the invoice or receipt, the nameplate picture (serial number), the picture of the part you need (for example: pins on the transformer plug that broke away)

We offer you a warranty extension to 1 year. To profit it, please follow the below proceeding:

- Connect on the website:
- Insert your contact details
- Register your tool with:
 - The reference
 - The serial number
 - The date you bought the tool
- Generate automatically the PDF warranty certificate and print it.

7. DECLARATION OF CONFORMITY



EC Declaration of conformity

BUILDER SAS
32, rue Aristide Bergès - ZI 31270 Cugnaux – France

Declares that the machine

**Designation: CORDLESS GRASS TRIMMER
EZ20VCBC-UK**

Serial number:

Is in conformity with the European Directives:

Machine Directive 2006/42/EC

EMC Directive 2014/30/EU

RoHS Directive 2011/65/EU

Noise directive 2000/14/EC +Annex VI & 2005/88/EC

Measured sound power level	89 dB(A) K=3dB(A)
Guarantee sound Power level LwA	96dB(A)

This product is also in conformity with the following standards:

EN 60335-1:2014+A11:2014

EN50636-2-91:2014

EN55014-1:2006+A1:2009+A2:2011

EN55014-2:1997+A1:2001+A2:2008

Notified body 0359

Intertek Testing & Certification Ltd.

Davy Avenue, Knowlhill, Milton Keynes, MK5 8NL

Telephone: +44 (0)1908 857777 Fax: +44 (0)1908 857830

Web: www.intertek.com

Responsible of the technical file: Mr Olivier Patriarca

Cugnaux, 10/07/2019

Philippe MARIE / PDG