

# Instruction manual

## MULTI-FUNCTION ROTARY TOOL

CPMG160W (DY94285)



ORIGINAL INSTRUCTIONS

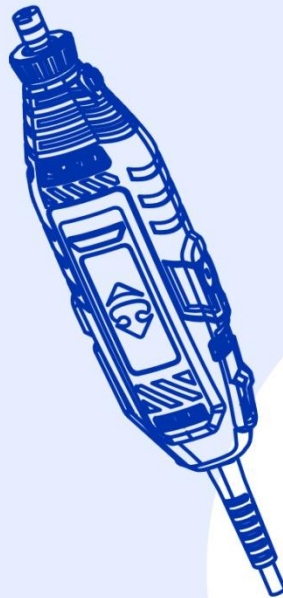



Congratulation on your purchase.

The quality team at CARREFOUR cares for its products to meet conformity and performances. Paying close attention to your satisfaction, our experts work all day on the improvement of our products.



For assembly and/or maintenance and/or use of your product, you can use:



These products are available in CARREFOUR stores.



## Read this manual carefully

For a better use of your new device, we recommend you to read carefully this Instruction Manual and keep it for record.

Keep it carefully for future reference.







Please also find information about the scraping of the product in this Instruction Manual.



## Safety instructions

Before installing or using the product, please read carefully the safety measures after the summary.

## Pictograms used

	Warning symbols with information on damage and injury prevention.
	Read the operation instructions carefully.
	Wear hearing protection.
	Wear dust mask
	Wear safety glasses.
	Electrical products must not be disposed of with the domestic waste.
	Protection class II (double insulation only for charger)

# CONTENTS

---

SAFETY INSTRUCTIONS .....	5
PRODUCT DESCRIPTION.....	10
INTENDED USE.....	13
SCOPE OF DELIVERY .....	13
OPERATION .....	13
CLEANING & MAINTENANCE .....	17
STORAGE AND TRANSPORTATION .....	17
REPLACEMENT PARTS /ACCESSORIES .....	17
DISPOSAL .....	18
DECLARATION OF CONFORMITY .....	18
WARRANTY .....	19
PRODUCT FAILURE.....	20
WARRANTY EXCLUSIONS .....	21

# SAFETY INSTRUCTIONS

---

## GENERAL POWER TOOL SAFETY WARNINGS

**WARNING** Read all safety warnings, instructions, illustrations and specifications provided with this power tool. *Failure to follow all instructions listed below may result in electric shock, fire and/or serious injury.*

**Save all warnings and instructions for future reference.**

*The term "power tool" in the warnings refers to your mains-operated (corded) power tool or battery-operated(cordless) power tool.*

### 1. Work area safety

- a) **Keep work area clean and well lit.** *Cluttered or dark areas invite accidents.*
- b) **Do not operate power tools in explosive atmospheres, such as in the presence of flammable liquids, gases or dust.** *Power tools create sparks which may ignite the dust or fumes.*
- c) **Keep children and bystanders away while operating a power tool.** *Distractions can cause you to lose control.*

### 2. Electrical safety

- a) **Power tool plugs must match the outlet. Never modify the plug in any way. Do not use any adapter plugs with earthed (grounded) power tools.** *Unmodified plugs and matching outlets will reduce risk of electric shock.*
- b) **Avoid body contact with earthed or grounded surfaces, such as pipes, radiators, ranges and refrigerators.** *There is an increased risk of electric shock if your body is earthed or grounded.*
- c) **Do not expose power tools to rain or wet conditions.** *Water entering a power tool will increase the risk of electric shock.*
- d) **Do not abuse the cord. Never use the cord for carrying, pulling or unplugging the power tool. Keep cord away from heat, oil, sharp edges or moving parts.** *Damaged or entangled cords increase the risk of electric shock.*
- e) **When operating a power tool outdoors, use an extension cord suitable for outdoor use.** *Use of a cord suitable for outdoor use reduces the risk of electric shock.*
- f) **If operating a power tool in a damp location is unavoidable, use a residual current device (RCD) protected supply.** *Use of an RCD reduces the risk of electric shock.*

### 3. Personal safety

- a) **Stay alert, watch what you are doing and use common sense when operating a power tool. Do not use a power tool while you are tired or under the influence of drugs, alcohol or medication.** *A moment of inattention while operating power tools may result in serious personal injury.*
- b) **Use personal protective equipment. Always wear eye protection.** *Protective equipment such as a dust mask, non-skid safety shoes, hard hat or hearing protection used for appropriate conditions will reduce personal injuries.*
- c) **Prevent unintentional starting. Ensure the switch is in the off-position before connecting to power source and/or battery pack, picking up or carrying the tool.** *Carrying power tools with your finger on the switch or energising power tools that have the switch on invites accidents.*
- d) **Remove any adjusting key or wrench before turning the power tool on.** *A wrench or a key left attached to a rotating part of the power tool may result in personal injury.*
- e) **Do not overreach. Keep proper footing and balance at all times.** *This enables better control of the power tool in unexpected situations.*

f) Dress properly. Do not wear loose clothing or jewellery. Keep your hair and clothing away from moving parts. *Loose clothes, jewellery or long hair can be caught in moving parts.*

g) If devices are provided for the connection of dust extraction and collection facilities, ensure these are connected and properly used. *Use of dust collection can reduce dust-related hazards.*

#### 4. Power tool use and care

a) Do not force the power tool. Use the correct power tool for your application. *The correct power tool will do the job better and safer at the rate for which it was designed.*

b) Do not use the power tool if the switch does not turn it on and off. *Any power tool that cannot be controlled with the switch is dangerous and must be repaired.*

c) Disconnect the plug from the power source and/or remove the battery pack, if detachable, from the power tool before making any adjustments, changing accessories, or storing power tools. *Such preventive safety measures reduce the risk of starting the power tool accidentally.*

d) Store idle power tools out of the reach of children and do not allow persons unfamiliar with the power tool or these instructions to operate the power tool. *Power tools are dangerous in the hands of untrained users.*

e) Maintain power tools and accessories. Check for misalignment or binding of moving parts, breakage of parts and any other condition that may affect the power tool's operation. If damaged, have the power tool repaired before use. *Many accidents are caused by poorly maintained power tools.*

f) Keep cutting tools sharp and clean. *Properly maintained cutting tools with sharp cutting edges are less likely to bind and are easier to control.*

g) Use the power tool, accessories and tool bits etc. in accordance with these instructions, taking into account the working conditions and the work to be performed. *Use of the power tool for operations different from those intended could result in a hazardous situation.*

#### 5. Service

a) Have your power tool serviced by a qualified repair person using only identical replacement parts.

*This will ensure that the safety of the power tool is maintained.*

### **SAFETY INSTRUCTIONS FOR ALL OPERATIONS**

a) This power tool is intended to function as a grinder, sander, wire brush, polisher, carving or cut-off tool. Read all safety warnings, instructions, illustrations and specifications provided with this power tool. *Failure to follow all instructions listed below may result in electric shock, fire and/or serious injury.*

b) Do not convert this power tool to operate in a way which is not specifically designed and specified by the tool manufacturer. *Such a conversion may result in a loss of control and cause serious personal injury.*

c) Do not use accessories which are not specifically designed and specified by the tool manufacturer. *Just because the accessory can be attached to your power tool, it does not assure safe operation.*

d) The rated speed of the accessory must be at least equal to the maximum speed marked on the power tool. *Grinding accessories running faster than their rated speed can break and fly apart.*

e) The outside diameter and the thickness of your accessory must be within the capacity rating of your power tool. *Incorrectly sized accessories cannot be adequately guarded or controlled.*

f) The arbour size of wheels, sanding drums or any other accessory must properly fit the spindle or collet of the power tool. *Accessories that do not match the mounting hardware of the power tool will run out of balance, vibrate excessively and may cause loss of control.*

- g) **Mandrel mounted wheels, sanding drums, cutters or other accessories must be fully inserted into the collet or chuck.** *If the mandrel is insufficiently held and/or the overhang of the wheel is too long, the mounted wheel may become loose and be ejected at high velocity.*
- h) **Do not use a damaged accessory. Before each use inspect the accessory such as abrasive wheels for chips and cracks, sanding drum for cracks, tears or excess wear, wire brush for loose or cracked wires. If power tool or accessory is dropped, inspect for damage or install an undamaged accessory. After inspecting and installing an accessory, position yourself and bystanders away from the plane of the rotating accessory and run the power tool at maximum no-load speed for one minute.** *Damaged accessories will normally break apart during this test time.*
- i) **Wear personal protective equipment. Depending on application, use face shield, safety goggles or safety glasses. As appropriate, wear dust mask, hearing protectors, gloves and workshop apron capable of stopping small abrasive or workpiece fragments.** *The eye protection must be capable of stopping flying debris generated by various applications. The dust mask or respirator must be capable of filtering particles generated by the particular application. Prolonged exposure to high intensity noise may cause hearing loss.*
- j) **Keep bystanders a safe distance away from work area. Anyone entering the work area must wear personal protective equipment.** *Fragments of workpiece or of a broken accessory may fly away and cause injury beyond immediate area of operation.*
- k) **Hold the power tool by insulated gripping surfaces only, when performing an operation where the cutting accessory may contact hidden wiring or its own cord.** *Cutting accessory contacting a "live" wire may make exposed metal parts of the power tool "live" and could give the operator an electric shock.*
- l) **Always hold the tool firmly in your hand(s) during the start-up.** *The reaction torque of the motor, as it accelerates to full speed, can cause the tool to twist.*
- m) **Use clamps to support workpiece whenever practical. Never hold a small workpiece in one hand and the tool in the other hand while in use.** *Clamping a small workpiece allows you to use your hand(s) to control the tool. Round material such as dowel rods, pipes or tubing have a tendency to roll while being cut, and may cause the bit to bind or jump toward you.*
- n) **Position the cord clear of the spinning accessory.** *If you lose control, the cord may be cut or snagged and your hand or arm may be pulled into the spinning accessory.*
- o) **Never lay the power tool down until the accessory has come to a complete stop.** *The spinning accessory may grab the surface and pull the power tool out of your control.*
- p) **After changing the bits or making any adjustments, make sure the collet nut, chuck or any other adjustment devices are securely tightened.** *Loose adjustment devices can unexpectedly shift, causing loss of control, loose rotating components will be violently thrown.*
- q) **Do not run the power tool while carrying it at your side.** *Accidental contact with the spinning accessory could snag your clothing, pulling the accessory into your body.*
- r) **Regularly clean the power tool's air vents.** *The motor's fan will draw the dust inside the housing and excessive accumulation of powdered metal may cause electrical hazards.*
- s) **Do not operate the power tool near flammable materials.** *Sparks could ignite these materials.*
- t) **Do not use accessories that require liquid coolants.** *Using water or other liquid coolants may result in electrocution or shock.*

## **FURTHER SAFETY INSTRUCTIONS FOR ALL OPERATIONS**

### **Kickback and Related Warnings**

Kickback is a sudden reaction to a pinched or snagged rotating wheel, backing pad, brush or any other accessory. Pinching or snagging causes rapid stalling of the rotating accessory which in turn causes the uncontrolled power tool to be forced in the direction opposite of the accessory's rotation.

For example, if an abrasive wheel is snagged or pinched by the workpiece, the edge of the wheel that is entering into the pinch point can dig into the surface of the material causing the wheel to climb out or kick out. The wheel may either jump toward or away from the operator, depending on direction of the wheel's movement at the point of pinching. Abrasive wheels may also break under these conditions.

Kickback is the result of power tool misuse and/or incorrect operating procedures or conditions and can be avoided by taking proper precautions as given below.

- a) **Maintain a firm grip on the power tool and position your body and arm to allow you to resist kickback forces.** *The operator can control torque reactions or kickback forces, if proper precautions are taken.*
- b) **Use special care when working corners, sharp edges etc. Avoid bouncing and snagging the accessory.** *Corners, sharp edges or bouncing have a tendency to snag the rotating accessory and cause loss of control or kickback.*
- c) **Do not attach a toothed saw blade.** *Such blades create frequent kickback and loss of control.*
- d) **Always feed the bit into the material in the same direction as the cutting edge is exiting from the material (which is the same direction as the chips are thrown).** *Feeding the tool in the wrong direction causes the cutting edge of the bit to climb out of the work and pull the tool in the direction of this feed.*
- e) **When using rotary files, cut-off wheels, high-speed cutters or tungsten carbide cutters, always have the work securely clamped.** *These wheels will grab if they become slightly canted in the groove, and can kickback. When a cut-off wheel grabs, the wheel itself usually breaks. When a rotary file, high-speed cutter or tungsten carbide cutter grabs, it may jump from the groove and you could lose control of the tool.*

## **ADDITIONAL SAFETY INSTRUCTIONS FOR GRINDING AND CUTTING-OFF OPERATIONS**

- a) **Use only wheel types that are recommended for your power tool and only for recommended applications.** For example: **do not grind with the side of a cut-off wheel.** *Abrasive cut-off wheels are intended for peripheral grinding, side forces applied to these wheels may cause them to shatter.*
- b) **For threaded abrasive cones and plugs use only undamaged wheel mandrels with an unrelieved shoulder flange that are of correct size and length.** *Proper mandrels will reduce the possibility of breakage.*
- c) **Do not "jam" a cut-off wheel or apply excessive pressure. Do not attempt to make an excessive depth of cut.** *Overstressing the wheel increases the loading and susceptibility to twisting or snagging of the wheel in the cut and the possibility of kickback or wheel breakage.*
- d) **Do not position your hand in line with and behind the rotating wheel.** *When the wheel, at the point of operation, is moving away from your hand, the possible kickback may propel the spinning wheel and the power tool directly at you.*
- e) **When wheel is pinched, snagged or when interrupting a cut for any reason, switch off the power tool and hold the power tool motionless until the wheel comes to a complete stop. Never attempt to remove the cut-off wheel from the cut while the wheel is in motion otherwise kickback may occur.** *Investigate and take corrective action to eliminate the cause of wheel pinching or snagging.*
- f) **Do not restart the cutting operation in the workpiece. Let the wheel reach full speed and carefully**



re-enter the cut. *The wheel may bind, walk up or kickback if the power tool is restarted in the workpiece.*

- g) **Support panels or any oversized workpiece to minimize the risk of wheel pinching and kickback.** *Large workpieces tend to sag under their own weight. Supports must be placed under the workpiece near the line of cut and near the edge of the workpiece on both sides of the wheel.*
- h) **Use extra caution when making a “pocket cut” into existing walls or other blind areas.** *The protruding wheel may cut gas or water pipes, electrical wiring or objects that cause kickback.*

## **ADDITIONAL SAFETY INSTRUCTIONS FOR WIRE BRUSHING OPERATIONS**

- a) **Be aware that wire bristles are thrown by the brush even during ordinary operation. Do not overstress the wires by applying excessive load to the brush.** *The wire bristles can easily penetrate light clothing and/or skin.*
- b) **Allow brushes to run at operating speed for at least one minute before using them. During this time no one is to stand in front or in line with the brush.** *Loose bristles or wires will be discharged during the run-in time.*
- c) **Direct the discharge of the spinning wire brush away from you.** *Small particles and tiny wire fragments may be discharged at high velocity during the use of these brushes and may become imbedded in your skin.*

## **SAFETY INSTRUCTIONS FOR LED LIGHTS**

**THERE IS A RISK OF INJURY TO THE EYES!** Never aim the LED light directly at people or animals and never look directly in to the LED light beam of the LED light.

## **RESIDUAL RISK**

Even if properly operating and handling this electric tool, some residual risks will remain. Due to its construction and build, this electric tool may present the following hazards,

- a) Lung damage, if suitable respiratory protection is not worn;
- b) Cuts
- c) Ear damage if working without wearing ear protection
- d) Eye damage if suitable eyes protection is not worn.
- e) Damage to your health caused by swinging your hands and arms when operating the electric tool for longer periods of time or if the too is not held or maintained properly.

# PRODUCT DESCRIPTION

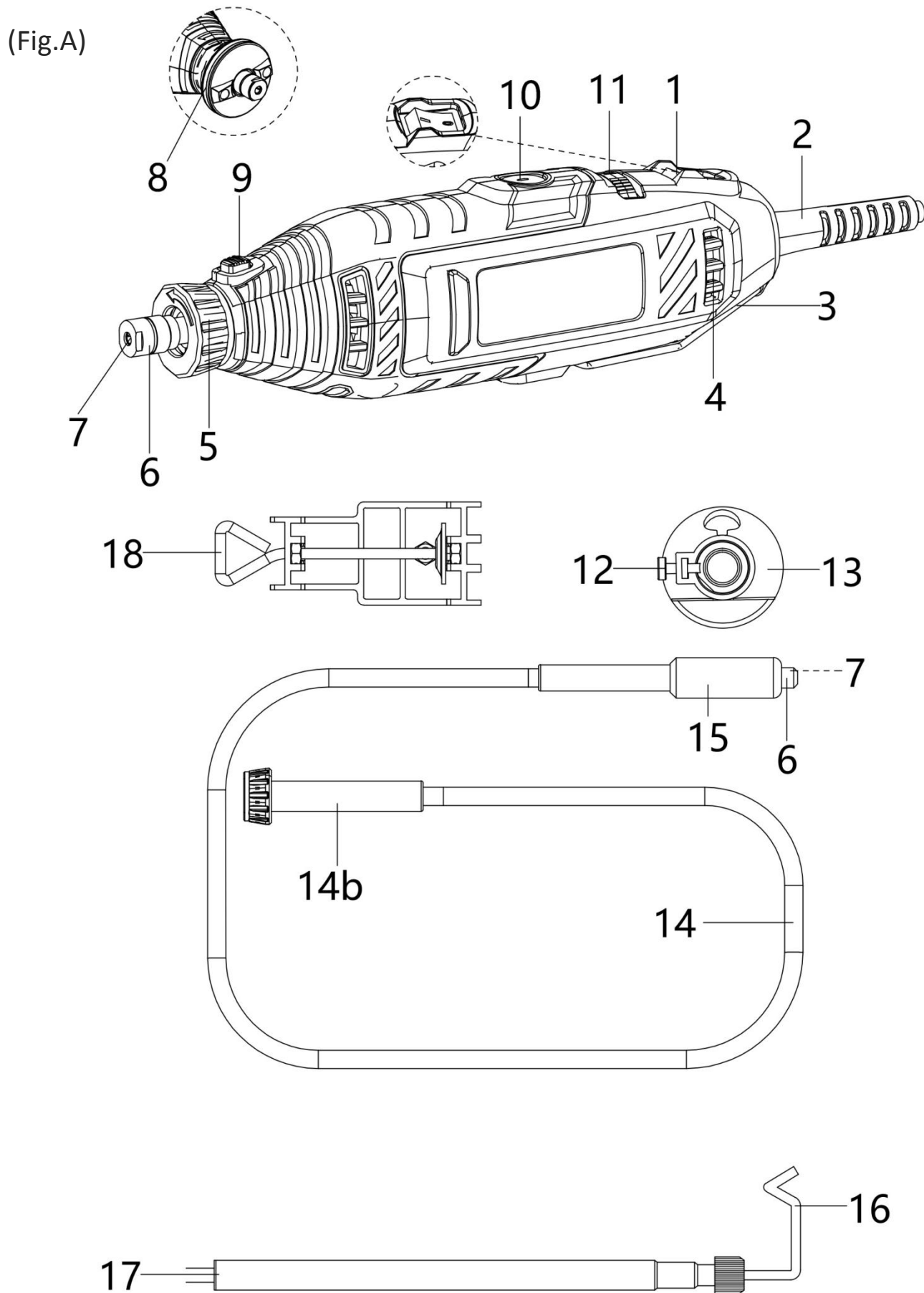

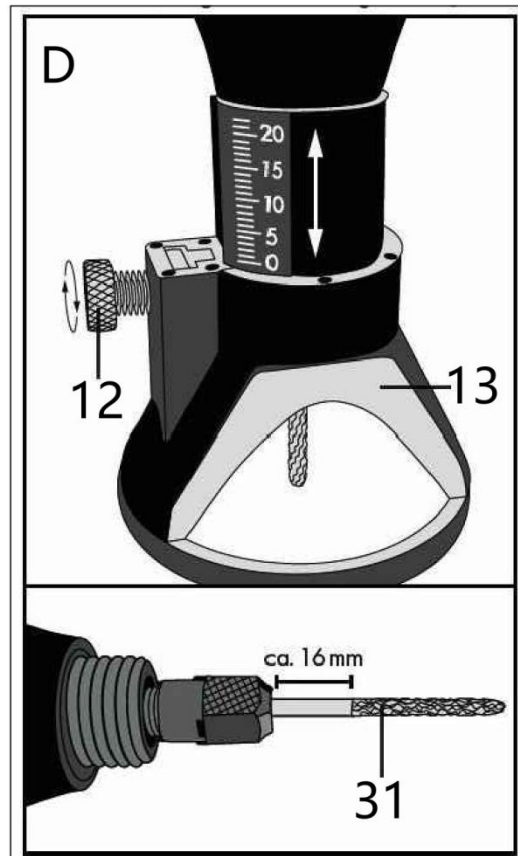
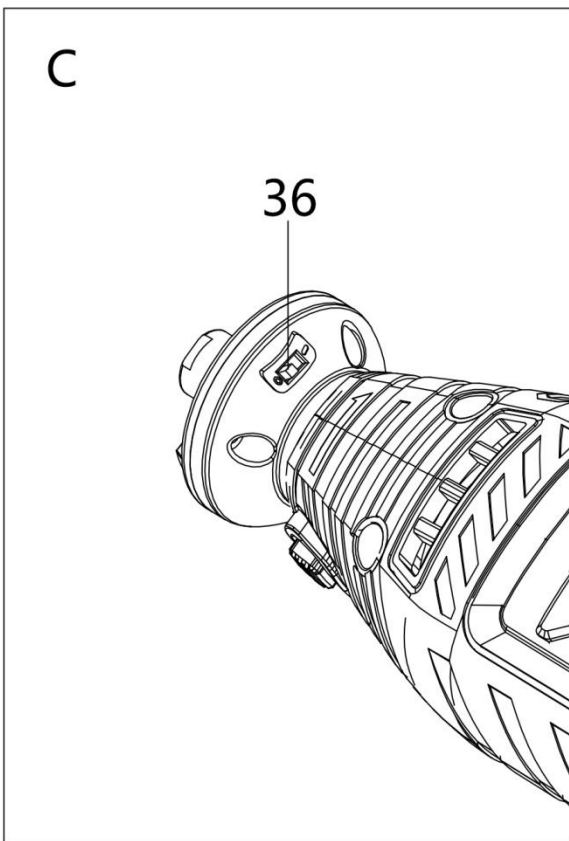
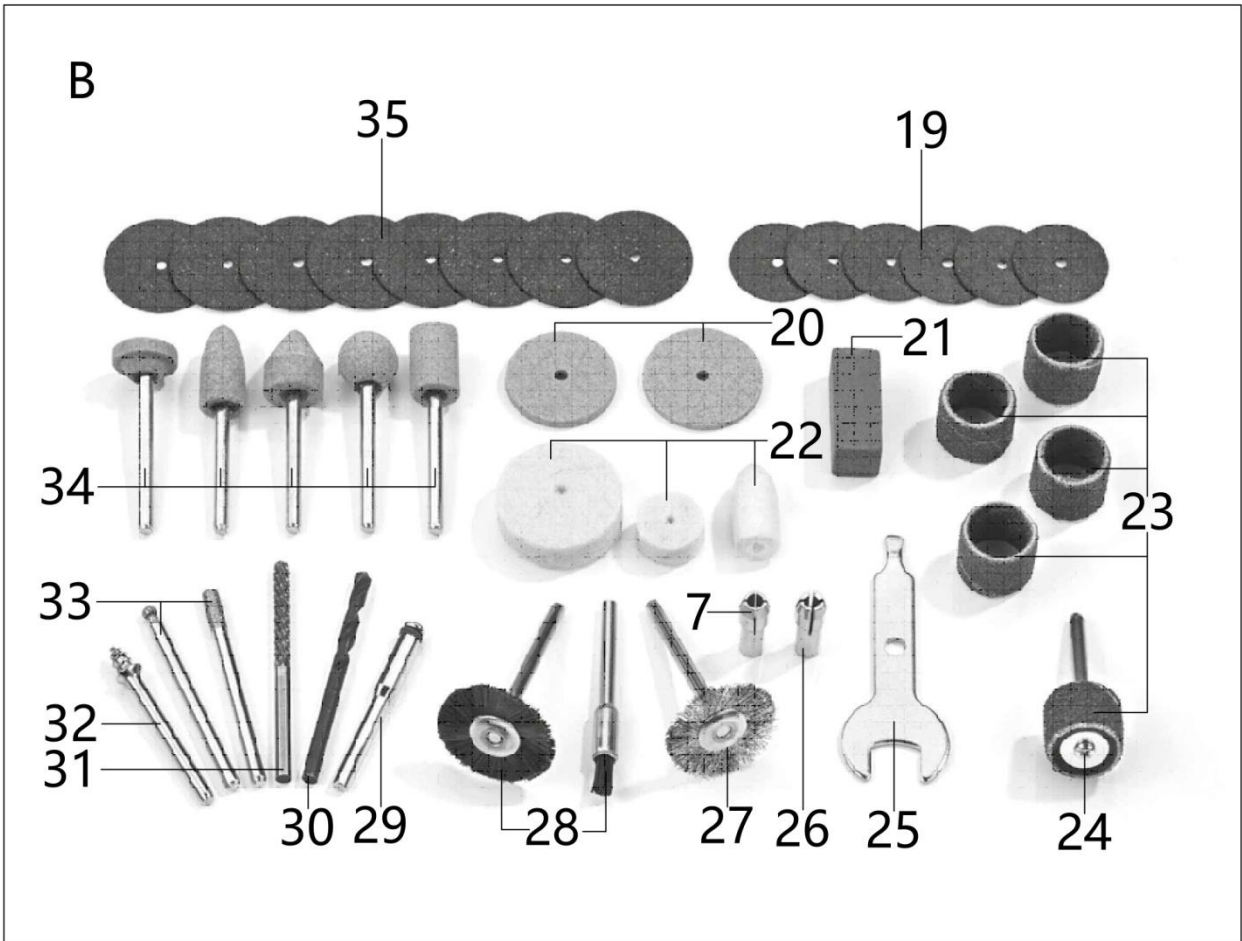

## OVERVIEW (Fig. A-C)

1. On/Off switch
2. Power cable
3. Bracket
4. Ventilation slots
5. Union nut
6. Tensioning nut
7. Collet chuck 3.2mm (pre-assembled)
8. Grip ring with LED Light
9. Spindle lock button
10. Carbon brushes
11. Infinitely variable speed control

### **Accessories**

12. Locking screw
13. Router cage
14. Flexible shaft
- 14b. Union nut (flexible shaft)
15. Spindle lock (flexible shaft)
16. Stand mount
17. Stand
18. Clamping assembly

### **Accessories Set, 42 pieces**

19. 6 cutting discs (max. 40000/min)
20. 2 grinding discs, abrasive (max. 40000/min)
21. 1 whet stone
22. 3 polishing attachments (max. 20000/min)
23. 4 abrasive belts (max. 40000/min)
24. 1 abrasive belt mandrel
25. 1 combination spanner
26. 1 collet chuck 2.4mm
27. 1 metal brush (max. 15000/min)
28. 2 plastic brushes (max. 15000/min)
29. 1 mandrel for cutting/grinding discs
30. 1 drill bit (max. 20000/min)
31. 1 milling bit (max. 40000/min)
32. 1 mandrel for polishing attachments
33. 2 engraving bits, abrasive (max. 40000/min)
34. 5 grinding bits, abrasive (max. 40000/min)
35. 8 cutting discs (max. 40000/min)
36. ON/OFF switch LED light

## INTRODUCTION

The operating instructions contain important information on safety, use and disposal. It is essential that you read the instructions before assembling, operation and maintaining the product. Use the product only as described and for the applications specified. Keep this manual safely and in the event that the product is passed on, hand over all documents to the third party or any future owner.

## TECHNICAL DATA

Rated voltage	230V~, 50Hz
Rated power	160W
Rated speed/ n	10000-40000/min
Drills	Max. $\Phi$ 3.2mm
Discs	Max. $\Phi$ 25mm
Protection class:	II/ 
Noise emission value according to EN 60745-2-23	
Sound pressure level $L_{PA}$	80.1 dB(A)
Sound power level $L_{WA}$	90.1 dB(A)
Uncertainty K	3dB(A)
Vibration emission value according to EN 60745-2-23	
$a_h$	4.387m/s <sup>2</sup>
Uncertainty K	1.5 m/s <sup>2</sup>

- The declared vibration total values and the declared noise emission values have been measured in accordance with a standard test method and may be used for comparing one tool with another.
- The declared vibration total values and the declared noise emission values may also be used in a preliminary assessment of exposure.

## **WARNINGS**

- The vibration and noise emissions during actual use of the power tool can differ from the declared values depending on the ways in which the tool is used especially what kind of workpiece is processed; and
- It is necessary to identify safety measures to protect the operator that are based on an estimation of exposure in the actual conditions of use (taking account of all parts of the operating cycle such as the times when the tool is switched off and when it is running idle in addition to the trigger time)

## **INTENDED USE**

---

This precision drill grinder (hereafter also referred to as the "appliance") is intended for drilling, milling, engraving, polishing, cleaning, grinding, cutting of wood, metal, plastics, ceramics and stone in dry rooms.

The manufacturer is not liable for damages caused by unspecified use or incorrect operation.

Any other use or modification that is not explicitly approved in these instructions may result in damage to the device and represent a serious danger or physical injury to the user. Not for commercial use.

## **SCOPE OF DELIVERY**

---

- 1 x rotary tool
- 1x plastic case
- 1x flexible shaft
- 1x stand
- 1x clamping device
- 1x router cage
- 1x grip ring with LED light
- 2x button cells
- 1x accessories set (42 pieces)
- 1x instruction manual
- 1x Carrying case

## **OPERATION**

---

 **WARNING!** Always disconnected with the plug from the mains socket before assembly and adjustment. Danger of electric shock!

### **CHANGING / INSERTING THE TOOL/COLLET CHUCK**

1. Press the spindle lock (9) and hold it down.
2. Turn the tensioning nut (6) until lock clicks into place.
3. Undo the tensioning nut (6) from the thread by using the combination spanner (25).
4. Remove any attached tool.
5. First push the intended tool through the tensioning nut (6) before inserting it into the appropriate

collet chuck (7) (26) for the tool shaft.

6. Press the spindle lock (9) and hold it down.
7. Push the collet chuck (7) (26) into the thread insert and screw the tensioning nut (6) tight with the combination spanner (25).

## **USING AN ACCESSORY TOOL WITH A MANDREL**

1. Use the screwdriver side of the combination spanner (25) to undo and tighten the screw on the mandrels (24) or (29).
2. Insert the respective mandrel (24), (29) or (32) into the appliance as described.
3. Use the combination spanner (25) to undo the screw on the mandrel (24) or (29).
4. Insert the desired accessory tool between the two washers on the screw.
5. Use the combination spanner (25) to tighten the screw on the mandrel (24) or (29).

## **WHET STONE**

Do not manually grind any edges with the whet stone (21).

## **FITTING ABRASIVE BELTS**

Push the abrasive belt (23) onto the abrasive belt mandrel (24). Tighten the screw on the abrasive belt mandrel (24) in order to fix the abrasive belt (23).

## **SWITCHING ON/OFF**

**NOTE: the rotation direction can be read off the arrow engraved on the union nut (5).**

1. Connect the appliance to the power supply.
2. Set the On/Off switch (1) to position "I". The tool will power on.
3. Move the On/Off switch (1) to position "O". The tool will power off.

## **SETTING THE ROTATION SPEED**

Set the infinitely variable speed control (11) to a position between "1" and "Max".

## **USING THE GRIP RING WITH LED LIGHT**

1. Unscrew the union nut (5) anticlockwise off the thread.
2. Screw the grip ring with LED (8) clockwise onto the screw thread.
3. Move the ON/off switch of the LED light (36) to the position "I" to switch it on (Fig. C).
4. Move the ON/off switch of the LED light (36) to the position "O" to switch it off.

## **TIPS ON WORKING WITH MATERIALS /TOOLS / SPEED RANGE**

1. Use the milling bit for working on the wood, plastics and plasterboard at maximum speed.
2. Calculate the rotational speed range for working on zinc, zinc alloys, aluminium, copper and lead by trying it out on test pieces.
3. Use a low rotational speed for work on plastics and materials with a low melting point.
4. Use a high rotational speed for working on wood.

5. Carry out cleaning, polishing and buffing work in the middle speed range.

The following are recommendations only and not binding. When carrying out practical work, carry out your own tests to see which tool and which settings are ideal for the material you are working on.

Number on the speed control (11)	Material being worked
1	Plastics and materials with a slow melting point.
2-3	Stone, ceramics
4	Soft wood, metal
5	hardwood
Max	steel

### Select suitable accessories for the appropriate rotational speed

**Warning!** never exceed the specified maximum rotational speed

Speed control	Accessories			Speed
Max			Cutting disc (19)	40000/min
5			Grinding wheel (20) / abrasive belts (23) / milling bits (31) / engraving bits (34) / cutting discs (35)	
4				
3		Polishing attachments		
2	Metal brush (27)	(22)/drills (30)		
1	/synthetic brush (28)			
0				0 /min

### Application examples /selecting a suitable tool

Function	Accessories	Use	Protrusion (min-max)mm
Drilling	Drill bit (30)	Working wood	18-25, using the smallest drill, the protrusion is 10mm
Milling	Milling bits (31)	Various jobs, e.g. creating recesses, hollows, forms, grooves or slits	18-25
Engraving	Engraving bits (33)	Labelling, handicrafts	18-25
Polishing, rust removal	Metal brush (27)	Rust removal	9-15
	Polishing attachments (22)	Various metals and plastics, especially precious metal such as gold and silver	12-18
Cleaning	Synthetic brushes (28)	e.g. cleaning hard-to-access plastic housings or the area around a door lock	9-15
Grinding	Grinding discs (20)	Grinding work on stone, wood, fine work on hard materials such as ceramics or alloyed steel	12-18
	Grinding bits (34)		10
	Abrasive belts (23)		10
cutting	Cutting discs (19) (35)	Working metal, plastic and wood	12-18

**NOTE:**

- The maximum diameter of the grinding assembly and of grinding cones, pencil grinders and grinding points with a thread insert may not exceed 55mm and the maximum diameter for sandpaper sanding accessories may not exceed 80mm.
- The max permissible length of a mandrel is 33mm.
- You need achieve the optimum working results by moving the tool over the workpiece at a steady speed and the while exerting light pressure.
- When carrying out cutting work, hold the appliance firmly with both hands.
- Observe the data and the information in the table to prevent the end of the spindle from touching the perforated base of the grinding tool.

**FLEXIBLE SHAFT**

- a) Unscrew the union nut (5) anticlockwise off the appliance and store it carefully.
- b) Press the spindle lock (9) and hold it down.
- c) Screw the tensioning nut (6) anticlockwise off the appliance.
- d) The shaft need to be pulled out a short distance as it can't be fixed into the collet chuck (7), (26) otherwise.
- e) Fit the flexible shaft (14) onto the appliance. To do so, insert the axis of flexible shaft into the collet chuck (7) inside of the tensioning nut (6)
- f) Press the spindle lock (9) and hold it down.
- g) Then tighten the tensioning nut (6) by using the combination spanner (25); screw the union nut (6) of the flexible shaft (14) clockwise onto the appliance.
- h) Place the desired accessory into the collet chuck (7) (26) of the flexible shaft.
- i) To lock the spindle, push the spindle lock (15) back onto the flexible shaft.
- j) Use the combination spanner (25) to undo the tensioning nut (6) on the flexible shaft. Fit the accessory and retighten the tensioning nut (6).

**STAND FOR THE MULTI-TOOL**

- a) Screw the stand (17) into the clamping assembly (18)
- b) Screw the clamping assembly (18) onto the edge of a work bench or table whose thickness is at least 55mm.
- c) The stand (17) is height-adjustable. Undo the upper part of the stand (17) by turning it anticlockwise. Pull out the tube to the maximum height and lock it again by turning it clockwise.
- d) The mount (16) is also height-adjustable; turn the black thread anticlockwise. After you have set the mount to the correct height, tighten the thread by turning in the opposite direction.
- e) Fix the appliance onto the mount (16) of the stand (17) using the metal bracket (3). The mount (16) can be turned 360°.

**ROUTER CAGE**

With this attachment, the appliance is particularly suitable for cutting special forms (holes for plugs, etc.)

- a) Insert the milling bit (31) as described in the section "Changing/inserting the tool/collet chuck".
- b) Ensure that the shaft of the bit protrudes out of the collet chuck by about 16 mm.
- c) Screw the union nut (5) anticlockwise off the appliance and store it carefully.
- d) Screw the router cage (13) onto the appliance.
- e) To set the correct working height, undo the locking screw (12) and adjust the foot of the router cage to the desired size.
- f) Afterwards, retighten the locking screw (12).



## CHANGING THE BATTERIES

- a) Make sure that the LED light is turned off. Remove the three screws from the rear of the grip ring with LED (8) .
- b) Replace the used batteries in the appliance with new batteries of the same type (button cell LR41). Note polarity when installing new batteries.
- c) Close the battery compartment again by replacing the three screws.

## CLEANING & MAINTENANCE

---

### **WARNING! RISK OF INJURY!**

1. Pull the mains plug before any adjustments, maintenance or repair.
2. Repair and servicing work not described in this manual should always be carried by the Service Centre. Use only the original parts.
3. The following cleaning and servicing should be done regularly. This will ensure a long and reliable service life.
  - Do not spray the appliance with water and do not immerse it in water. **Electric Shock** hazard.
  - Keep clean the ventilation slots, motor housing and handles of the appliance. Use a damp cloth or a brush. Do not use cleaning agents or solvents. You may otherwise irreparable damage the appliance.
  - The appliance is maintenance free.
  - Type Y attachment, If the replacement of the supply cord is necessary, this has to be done by the manufacturer or his agent in order to avoid a safety hazard.

## STORAGE AND TRANSPORTATION

---

### STORAGE

1. Switch off and unplug the appliance before storage.
2. Store the appliance in a dry and secure place well out of reach of children.
3. Store the appliance and all the individual pieces in the provided plastic case to ensure not to lose any part.

### TRANSPORT

Before transporting, observe the followings:

- a) Switch off and unplug the appliance.
- b) Allow the appliance to cool down.
- c) Put the appliance and accessories into the case.
- d) Hold the handle of the case for transportation carefully.

## REPLACEMENT PARTS /ACCESSORIES

---

 **WARNING! Only use accessories specified in the operating manual. Using the accessories other than those specific in the operating manual may cause a risk of injury. Only get the accessories listed below from the Service Centre.**

## DISPOSAL

---



To help the environment, please dispose of the product properly when it has reached the end of its useful life and not in the household waste. Information on collection points and their opening hours can be obtained from your local authority.

## DECLARATION OF CONFORMITY

---



**Carrefour Marchandises Internationales**  
**93, avenue de Paris**  
**91342 Massy**  
**France**

Herewith we declare that the product  
160W MULTI-FUNCTION ROTARY TOOL  
Model number: CPMG160W(DY94285)  
**S/N: 20210720566-20210721475**

Is in conformity with the following European Directives  
2006/42/EC  
2014/30/EU  
2011/65/EU & (EU) 2015/863

And the harmonized standards  
EN 60745-1-1 :2009+A1 :2010  
EN 60745-2-23 :2013  
EN 55014-1:2017+A11:2020  
EN 55014-2:2015  
EN IEC 61000-3-2:2019  
EN 61000-3-3:2013+A1 :2019

Manufacturer and name of the authorised representative of the technical documentation

Signature

Place and date:

# WARRANTY

---

The manufacturer guarantees the product against defects in material and workmanship for a period of 2 years from the date of the original purchase. The warranty only applies if the product is for household use. The warranty does not cover breakdowns due to normal wear and tear.

The manufacturer agrees to replace parts identified as defective by the designated distributor. The manufacturer does not accept responsibility for the replacement of the machine, in whole or in part, and/or ensuing damage.

**The warranty does not cover breakdowns due to:**

- insufficient maintenance.
- abnormal assembly, adjustment or operations of the product.
- parts subject to normal wear and tear.

**The warranty does not extend to:**

- shipping and packaging costs.
- using the tool for a purpose other than that for which it was designed.
- the use and maintenance of the machine done in a manner not described in the user manual.

Due to our policy of continuous product improvement, we reserve the right to alter or change specifications without notice. Consequently, the product may be different from the information contained therein, but a modification will be undertaken without notice if it is recognized as an improvement of the preceding characteristic.

**READ THE MANUAL CAREFULLY BEFORE USING THE MACHINE.**

When ordering spare parts, please indicate the part number or code, you can find this in the spare parts list in this manual. Keep the purchase receipt; without it, the warranty is invalid. To help you with your product, we invite you to contact us by phone or via our website:

**+33 (0)9.70.75.30.30**

**<https://services.swap-europe.com/contact>**

You must create a "ticket" via the web platform.

- Register or create your account.
- Indicate the reference of the tool.
- Choose the subject of your request.
- Describe your problem.

Attach these files: invoice or sales receipt, photo of the identification plate (serial number), photo of the part you need (for example: pins on the transformer plug which are broken).



# PRODUCT FAILURE

---

## WHAT TO DO IF MY MACHINE BREAKS DOWN?

### If you bought your product in a store:

- Make sure that your machine is complete with all accessories supplied, and clean! If this is not the case, the repairer will refuse the machine.
- Go to the store with the complete machine and with the receipt or invoice.

### If you bought your product on a website:

- Make sure that your machine is complete with all accessories supplied, and clean! If this is not the case, the repairer will refuse the machine.
- Create a SWAP-Europe service ticket on the site: <https://services.swap-europe.com> When making the request on SWAP-Europe, you must attach the invoice and the photo of the nameplate (serial number).

Contact the repair station to make sure it is available before dropping off the machine.

Go to the repair station with the complete machine packed, accompanied by the purchase invoice and the station support sheet downloadable after the service request is completed on the SWAP-Europe site

**Please keep your original packaging to allow for after-sales service returns or pack your machine with a similar cardboard box of the same dimensions.**

**For any question concerning our after-sales service you can make a request on our website <https://services.swap-europe.com>**

**Our hotline remains available at +33 (9) 70 75 30 30.**



# WARRANTY EXCLUSIONS

---

## THE WARRANTY DOES NOT COVER:

- Start-up and setting up of the product.
- Damage resulting from normal wear and tear of the product.
- Damage resulting from improper use of the product.
- Damage resulting from assembly or start-up not in accordance with the user manual.
- Breakdowns related to carburetion beyond 90 days and fouling of carburetors.
- Periodic and standard maintenance events.
- Actions of modification and dismantling that directly void the warranty.
- Products whose original authentication marking (brand, serial number) has been degraded, altered or withdrawn.
- Replacement of consumables.
- The use of non-original parts.
- Breakage of parts following impacts or projections.
- Accessories breakdowns.
- Defects and their consequences linked to any external cause.
- Loss of components and loss due to insufficient screwing.
- Cutting components and any damage related to the loosening of parts.
- Overload or overheating.
- Poor power supply quality: faulty voltage, voltage error, etc.
- Damages resulting from the deprivation of enjoyment of the product during the time necessary for repairs and more generally the costs related to the immobilization of the product.
- The costs of a second opinion established by a third party following an estimate by a SWAP-Europe repair station
- The use of a product which would show a defect or a breakage which was not the subject of an immediate report and/or repair with the services of SWAP-Europe.
- Deterioration linked to transport and storage\*.
- Launchers beyond 90 days.
- Oil, petrol, grease.
- Damages related to the use of non-compliant fuels or lubricants.

\* In accordance with transport legislation, damage related to transport must be declared to carriers within 48 hours maximum after observation by registered letter with acknowledgement of receipt.

This document is a supplement to your notice, a non-exhaustive list.

**Attention:** all orders must be checked in the presence of the delivery person. In case of refusal by the delivery person, it you must simply refuse the delivery and notify your refusal.

**Reminder:** the reserves do not exclude the notification by registered letter with acknowledgement within 72 hours.

### **Information:**

Thermal devices must be wintered each season (service available on the SWAP-Europe site). Batteries must be charged before being stored.

Staple here your receipt



Product	Ref	EAN
MULTI-FUNCTION ROTARY TOOL	DY94285	3616474461949



EN

## For any comments or suggestions

Carrefour Consumer service  
– CMI  
TSA 91431  
91343 MASSY Cedex  
France  
[www.carrefour.fr](http://www.carrefour.fr)

 **N°Cristal** 09 69 39 70 00

APPEL NON SURTAXE

More information on  
[www.mycarrefourdocs.com](http://www.mycarrefourdocs.com)